

of Chicago, Section 99-60.1, is hereby amended by adding at the end of the first paragraph following the words "hospital purposes" the words "and then only in case of emergency, or as directed by the Commissioner of Streets and Sanitation".

SECTION 2. This ordinance shall take effect on and after the date of its passage.

Chicago Zoning Ordinance Amended to Reclassify Particular Areas.

On motion of Alderman Metcalfe the City Council took up for consideration the report of the Committee on Buildings and Zoning deferred and published on June 26, 1968, pages 3168-3170, recommending that the City Council pass twenty-six proposed ordinances transmitted with the committee's report for amendment of the Chicago Zoning Ordinance to reclassify particular areas.

On separate motions made by Alderman Metcalfe, twenty-three of the said proposed ordinances (which were recommended by the committee without change) were *Passed*, by yeas and nays as follows:

Yeas—Aldermen Roti, Harvey, Metcalfe, Holman, Despres, Bohling, Cousins, Lupo, Buchanan, Danaher, Swinarski, Staszczuk, Krska, Sheridan, Shannon, Hines, Fitzpatrick, Campbell, Frost, Janousek, Kuta, Collins, Marzullo, Zydlo, Sain, Jambrone, Biggs, McMahon, Keane, Sulski, Brandt, Laskowski, Aiello, Cullerton, Scholl, Goldberg, McCutcheon, Rosenberg, Fifielski, Kerwin, Wigoda—41.

Nays—None.

Alderman Janousek moved to *Reconsider* the foregoing vote. The motion was *Lost*.

Said twenty-three ordinances, as passed, read respectively as follows (the *Italic* heading in each case not being a part of the ordinance):

Reclassification of Area Shown on Map No. 1-H.

Be It Ordained by the City Council of the City of Chicago:

SECTION 1. That the Chicago Zoning Ordinance be amended by changing all the C1-2 Restricted Commercial District symbols and indications as shown on Map No. 1-H in the area bounded by

W. Grand Avenue; a line 293 feet east of N. Western Avenue; a line 105 feet south of W. Grand Avenue; and N. Western Avenue,

to those of an M1-2 Restricted Manufacturing District, and a corresponding use district is hereby established in the area above described.

SECTION 2 This ordinance shall be in force and effect from and after its passage and due publication.

Reclassification of Area Shown on Map No. 2-G.

Be It Ordained by the City Council of the City of Chicago:

SECTION 1. That the Chicago Zoning Ordinance be amended by changing all the R4 and R5 General Residence District symbols and indications as shown on Map No. 2-G in the area bounded by

east on W. Polk St. from S. Loomis Street to S. Ada Street; south on S. Ada Street to W. Cabrini Street; east on W. Cabrini Street 86.19 feet;

south on S. Ada Street to W. Arthington Street; north on S. Loomis Street to W. Polk Street, to the designation of a Residential Planned Development which is hereby established in the area above described, subject to such use and bulk regulations as are set forth in the Plan of Development herewith attached and made a part hereof and to no others.

SECTION 2. This ordinance shall be in force and effect from and after its passage and due publication.

[Plan of Development attached to this ordinance printed on pages 3394-3398 of this Journal]

Reclassification of Area Shown on Map No. 3-G.

Be It Ordained by the City Council of the City of Chicago:

SECTION 1. That the Chicago Zoning Ordinance be amended by changing all the R4 General Residence District symbols and indications as shown on Map No. 3-G in the area bounded by

the south line of the right of way of the Chicago and North Western Railroad; the alley next east of and parallel to N. May Street; the alley next north of and parallel to W. Fry Street; the alley next east of the alley next east of and parallel to N. May Street; a line 125 feet north of W. Fry Street; N. Carpenter Street; N. Ogden Avenue; W. Fry Street and N. May Street,

to those of an M3-4 Heavy Manufacturing District, and a corresponding use district is hereby established in the area above described.

SECTION 2. This ordinance shall be in force and effect from and after its passage and due publication.

Reclassification of Area Shown on Map No. 3-H.

Be It Ordained by the City Council of the City of Chicago:

SECTION 1. That the Chicago Zoning Ordinance be amended by changing all the R4 General Residence District symbols and indications as shown on Map No. 3-H in the area bounded by

W. Le Moyne Street; N. Damen Avenue; W. Schiller Street; and the alley next east of and parallel to N. Hoynes Avenue,

to the designation of a Residential Planned Development which is hereby established in the area above described, subject to such use and bulk regulations as are set forth in the Plan of Development herewith attached and made a part hereof and to no others.

SECTION 2. This ordinance shall be in force and effect from and after its passage and due publication.

[Plan of Development attached to this ordinance printed on pages 3399-3403 of this Journal]

Reclassification of Area Shown on Map No. 5-M.

Be It Ordained by the City Council of the City of Chicago:

SECTION 1. That the Chicago Zoning Ordinance be amended by changing all the B4-1 Restricted Service District symbols and indications as shown on Map No. 5-M in the area bounded by

W. Grand Avenue; N. Meade Avenue; the alley next south of W. Grand Avenue; and N. Moody Avenue,

to those of a C1-1 Restricted Commercial District,

(Continued on page 3404)

PLAN OF DEVELOPMENTRESIDENTIAL PLANNED DEVELOPMENT #59STATEMENTS

1. The area delineated hereon as "Residential Planned Development" is owned and controlled by the Department of Urban Renewal of the City of Chicago and designated as Near West Side Urban Renewal Disposition Parcels LR-27 and PK-26.
2. Off-street parking facilities shall be provided in compliance with this Plan of Development as authorized by the Chicago Zoning Ordinance.
3. Any dedication or vacation of streets or alleys or adjustment of rights-of-way or consolidation or resubdivision of parcels shall require a separate submittal on behalf of the Department of Urban Renewal and approval by the City Council.
4. All applicable official reviews, approvals or permits are required to be obtained by the

Department of Urban Renewal or its successor
upon conveyance of Near West Side Urban Renewal
Disposition Parcels LR-27 and PK-26.
5. Service drives or any other ingress or egress shall be adequately designed and paved to provide ingress and egress for motor vehicles including emergency vehicles. There shall be no parking within such paved areas.
6. Use of land will consist of townhouse and duplex structures and private recreation areas.
7. The following information sets forth data concerning the property included in said Planned Development and data concerning a generalized land use plan (site plan) illustrating the development of said property in accordance with the intent and purpose of the Chicago Zoning Ordinance as related to a R3 General Residence District and with the regulations hereby made applicable thereto.
8. The Plan of Development hereby attached shall be subject to the "Rules, Regulations and Procedures in relation to Planned Developments."

APPLICANT: DEPARTMENT OF URBAN RENEWAL OF THE CITY OF CHICAGO

DATE: May 8, 1968

RESIDENTIAL PLANNED DEVELOPMENT

PROPERTY LINE MAP AND RIGHT-OF-WAY ADJUSTMENTS

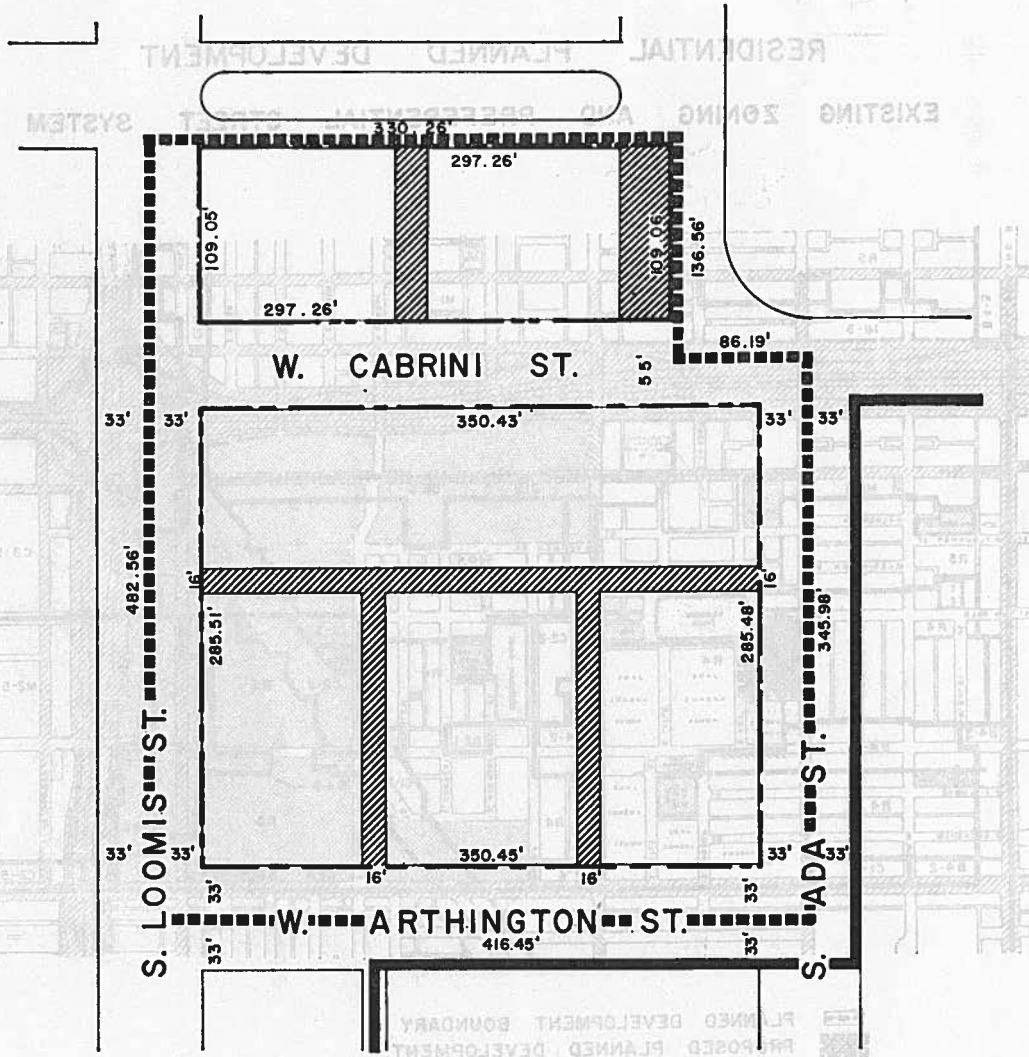

LEGEND

- NEAR WEST SIDE PROJECT BOUNDARY
- PLANNED DEVELOPMENT BOUNDARY
- PARCEL LR 27
- RIGHTS OF WAY VACATED BY ORDINANCE APPROVED BY CITY COUNCIL
ALLEYS: DATE SEPT. 19, 1966
STREETS: DATE SEPT. 19, 1966
- PARCEL PK-26



SCALE IN FEET

APPLICANT: DEPARTMENT OF URBAN RENEWAL
CITY OF CHICAGO

DATE: MAY 8, 1968

**RESIDENTIAL PLANNED DEVELOPMENT
EXISTING ZONING AND PREFERENTIAL STREET SYSTEM**

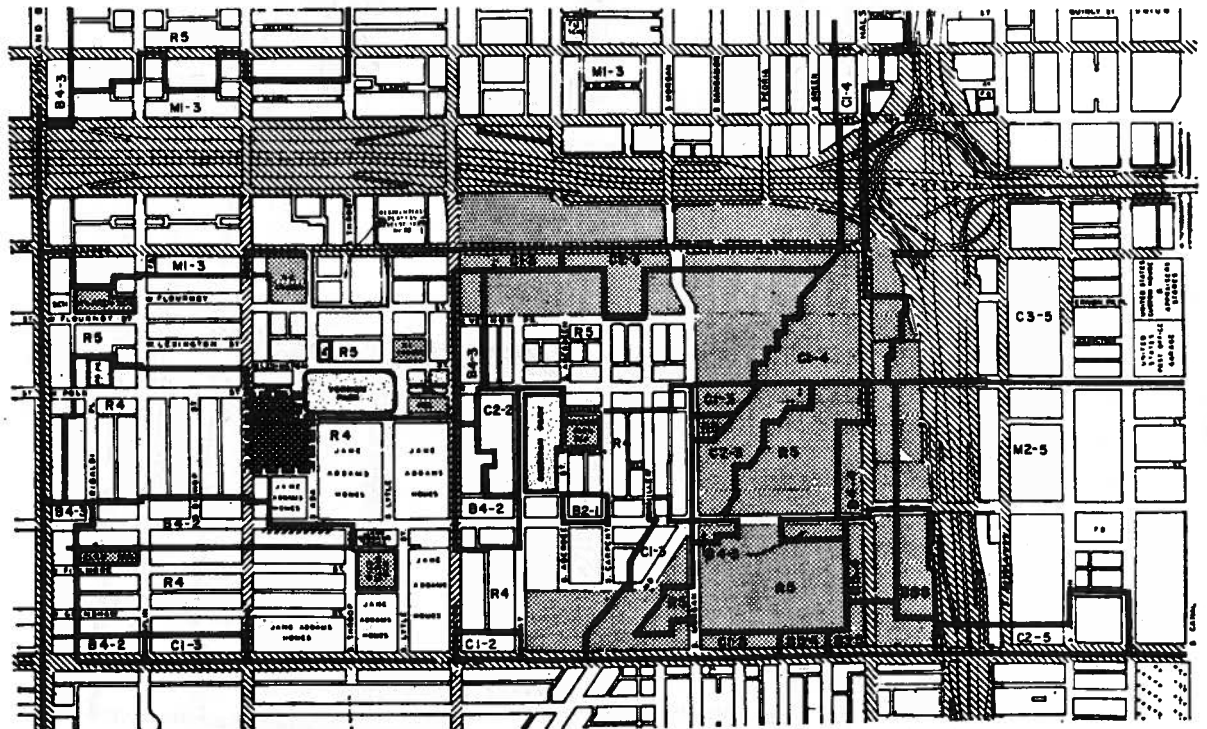

- PLANNED DEVELOPMENT BOUNDARY
- PROPOSED PLANNED DEVELOPMENT
- ZONING DISTRICTS
- PARKS & PLAYGROUNDS
- PREFERENTIAL STREETS
- PUBLIC & QUASI-PUBLIC FACILITIES



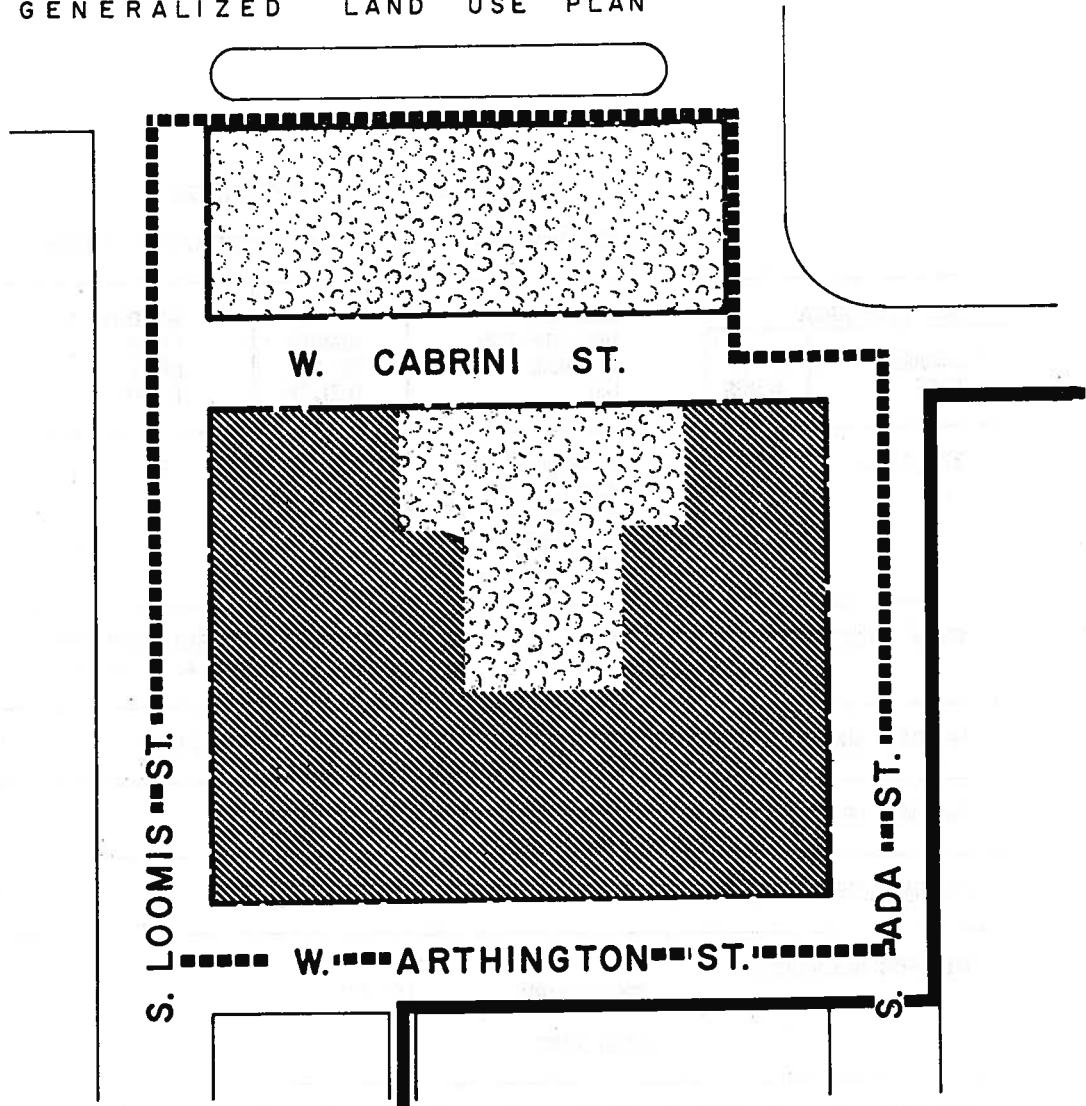

**APPLICANT: DEPARTMENT OF URBAN RENEWAL OF
THE CITY OF CHICAGO**

DATE: MAY 8, 1968

RESIDENTIAL PLANNED DEVELOPMENT GENERALIZED LAND USE PLAN

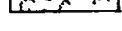

LEGEND

-  NEAR WEST SIDE PROJECT BOUNDARY
-  PLANNED DEVELOPMENT BOUNDARY
-  PARCEL LR-27
-  PRIVATE RECREATION AREA
-  TOWNHOUSES
-  PARCEL PK-26

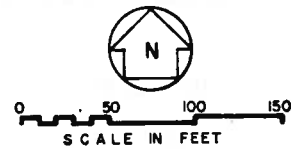

APPLICANT: DEPARTMENT OF URBAN RENEWAL
CITY OF CHICAGO

DATE: MAY 8, 1968

RESIDENTIAL PLANNED DEVELOPMENT
PLANNED DEVELOPMENT USE & BULK REGULATIONS & DATA

NET SITE AREA		GENERAL DESCRIPTION OF LAND USE	NUMBER OF D.U.'S	MAXIMUM FLOOR AREA RATIO	MAXIMUM PERCENT OF LAND COVERED
SQUARE FEET	ACRES				
124,488.3	2.86	TOWNHOUSE AND DUPLEX STRUCTURES, AND RECREATION AREAS	28 12	0.7	26

GROSS SITE AREA = NET SITE AREA (2.86 acres) + AREA OF PUBLIC STREETS (1.48 acres) = 4.34 acres

MAXIMUM NUMBER OF DWELLING UNITS PER ACRE OF TOTAL NET SITE AREA:	17.4
MAXIMUM PERMITTED F.A.R. FOR TOTAL NET SITE AREA:	0.7
MINIMUM NUMBER OF PARKING SPACES:	40
MINIMUM SETBACKS:	
FRONT YARD	15'-0"
SIDE YARD	5'-0"
MINIMUM DISTANCES BETWEEN BUILDINGS WITH A FACING LIVING ROOM WINDOWS:	50'-0"
MINIMUM DISTANCES BETWEEN END WALLS WITH WINDOWS:	25'-0"

APPLICANT: DEPARTMENT OF URBAN RENEWAL OF THE CITY OF CHICAGO

DATE: May 8, 1968