

be amended by changing all the R4 General Residence District symbols and indications as shown on Map No. 3-H in the area bounded by

a line 415 feet north of W. Augusta Boulevard; the alley next east of and parallel to N. Damen Avenue; a line 340 feet north of W. Augusta Boulevard; and N. Damen Avenue,

to those of a C1-2 Restricted Commercial District, and a corresponding use district is hereby established in the area above described.

SECTION 2. This ordinance shall be in force and effect from and after its passage and due publication.

Reclassification of Area Shown on Map No. 6-J.

Be It Ordained by the City Council of the City of Chicago:

SECTION 1. That the Chicago Zoning Ordinance be amended by changing all the R4 General Residence District symbols and indications as shown on Map No. 6-J in the area bounded by

W. 25th Street; S. Sawyer Avenue; a line 50 feet south of W. 25th Street; the alley next west of and parallel to S. Sawyer Avenue; a line 25 feet south of W. 25th Street; and S. Spaulding Avenue,

to those of a B4-1 Restricted Service District, and a corresponding use district is hereby established in the area above described.

SECTION 2. This ordinance shall be in force and effect from and after its passage and due publication.

Reclassification of Area Shown on Map No. 6-J.

Be It Ordained by the City Council of the City of Chicago:

SECTION 1. That the Chicago Zoning Ordinance be amended by changing all the C1-1 Restricted Commercial District symbols and indications as shown on Map No. 6-J in the area bounded by

a line 50 feet north of W. 31st Street; the alley next east of and parallel to S. Homan Avenue; a line 25 feet north of W. 31st Street; and S. Homan Avenue,

to those of an R3 General Residence District, and a corresponding use district is hereby established in the area above described.

SECTION 2. This ordinance shall be in force and effect from and after its passage and due publication.

Reclassification of Area Shown on Map No. 6-K.

Be It Ordained by the City Council of the City of Chicago:

SECTION 1. That the Chicago Zoning Ordinance be amended by changing all the R3 General Residence District symbols and indications as shown on Map No. 6-K in the area bounded by

the alley next north of and parallel to W. 31st Street; a line 50 feet west of S. Tripp Avenue; W. 31st Street; and S. Kildare Avenue,

to those of a B2-2 Restricted Retail District, and a corresponding use district is hereby established in the area above described.

SECTION 2. This ordinance shall be in force and effect from and after its passage and due publication.

Reclassification of Area Shown on Map No. 9-G.

Be It Ordained by the City Council of the City of Chicago:

SECTION 1. That the Chicago Zoning Ordinance be amended by changing all the R4 General Residence District symbols and indications as shown on Map No. 9-G in the area bounded by

the alley next north of and parallel to W. Eddy Street; a line 50 feet east of the alley next east of and parallel to N. Racine Avenue; W. Eddy Street; and the alley next east of and parallel to N. Racine Avenue,

to those of an M1-2 Restricted Manufacturing District, and a corresponding use district is hereby established in the area above described.

SECTION 2. This ordinance shall be in force and effect from and after its passage and due publication.

Reclassification of Area Shown on Map No. 10-F.

Be It Ordained by the City Council of the City of Chicago:

SECTION 1. That the Chicago Zoning Ordinance be amended by changing all the Planned Development symbols and indications as shown on Map No. 10-F in the area bounded by

W. Root Street; S. Princeton Avenue; W. 43rd Street; the west line of S. Stewart Avenue, or the line thereof if extended where no street exists; W. 42nd Street; and a line 63 feet east of the west line of S. Stewart Avenue,

to the designation of a Residential Planned Development which is hereby established in the area above described, subject to such use and bulk regulations as are set forth in the Plan of Development herewith attached and made a part hereof and to no others.

SECTION 2. This ordinance shall be in force and effect from and after its passage and due publication.

[Plan of Development attached to this ordinance is printed on pages 3895-3899 of this Journal.]

Reclassification of Area Shown on Map No. 10-G.

Be It Ordained by the City Council of the City of Chicago:

SECTION 1. That the Chicago Zoning Ordinance be amended by changing all the M2-4 General Manufacturing District symbols and indications as shown on Map No. 10-G in the area bounded by

a line 300 feet south of W. Pershing Road; a line 100 feet east of S. Ashland Avenue; a line 550 feet south of W. Pershing Road; and S. Ashland Avenue,

to those of a C2-5 General Commercial District, and a corresponding use district is hereby established in the area above described.

SECTION 2. This ordinance shall be in force and effect from and after its passage and due publication.

Reclassification of Area Shown on Map No. 10-L.

Be It Ordained by the City Council of the City of Chicago:

SECTION 1. That the Chicago Zoning Ordinance be amended by changing all the R2 Single Family Residence District symbols and indications as shown on Map No. 10-L in the area bounded by

a line 119.85 feet south of W. 44th Street; S.

(Continued on page 3900)

PD 54

Passed 11-29-68
Pages 3894-3895

PLAN OF DEVELOPMENT
RESIDENTIAL PLANNED DEVELOPMENT - No. 54 (as amended)

STATEMENTS

1. The area delineated hereon as a "Residential Planned Development" is owned and controlled by the Chicago Housing Authority.
2. Off-Street parking and loading facilities will be provided in compliance with this Plan of Development as authorized by the R4 General Residence District of the Chicago Zoning Ordinance.
3. Any dedication of streets or alleys or adjustments of the rights of way or consolidation or resubdivision of parcels shall require a separate submittal on behalf of the Chicago Housing Authority and approval by the City Council.
4. All applicable official reviews, approvals or permits are required to be obtained by the Chicago Housing Authority.
5. Service drives or any other ingress or egress shall be adequately designed and paved in accord with the regulations of the Department of Streets and Sanitation and in compliance with the Municipal Code of Chicago to provide ingress and egress for motor vehicles, including emergency vehicles. There shall be no parking permitted within such paved areas.

Fire lanes shall be adequately designed and paved in compliance with the Municipal Code of Chicago to provide ingress and egress for emergency vehicles; there shall be no parking within such paved areas.
6. Use of land will consist of one high-rise elevator apartment building (housing for elderly persons), 2 story walkup apartments, single family dwellings, and recreational areas and facilities as authorized by the Chicago Zoning Ordinance.
7. The following information sets forth data concerning the property included in said planned development and data concerning a generalized land use plan (site plan) illustrating the development of said property in accordance with the intent and purpose of the Chicago Zoning Ordinance as related to an R4 General Residence District classification and with regulations hereby made applicable thereto.
8. The Plan of Development hereby attached shall be subject to the "Rules, Regulations and Procedures in Relation to Planned Developments", as adopted by the Commissioner of Development and Planning.

APPLICANT: CHICAGO HOUSING AUTHORITY

DATE: Oct. 9, 1968

ell 232



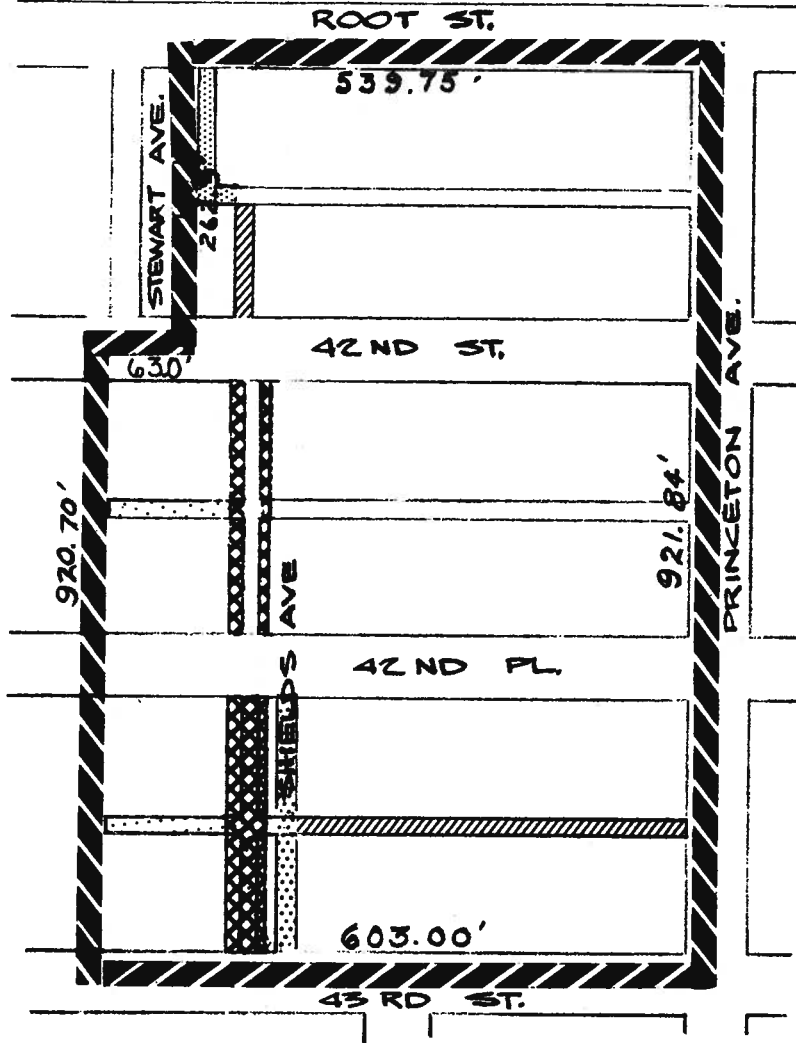

RESIDENTIAL PLANNED

DEVELOPMENT - No. 54 (as amended)

PROPERTY LINE MAP & RIGHT OF WAY ADJUSTMENTS



LEGEND

-  PLANNED DEVELOPMENT BOUNDARY
-  ALLEYS TO BE DEDICATED
-  ALLEYS TO BE VACATED
-  STREETS TO BE VACATED



SCALE: 1" = 200'

APPLICANT: THE CHICAGO HOUSING AUTHORITY



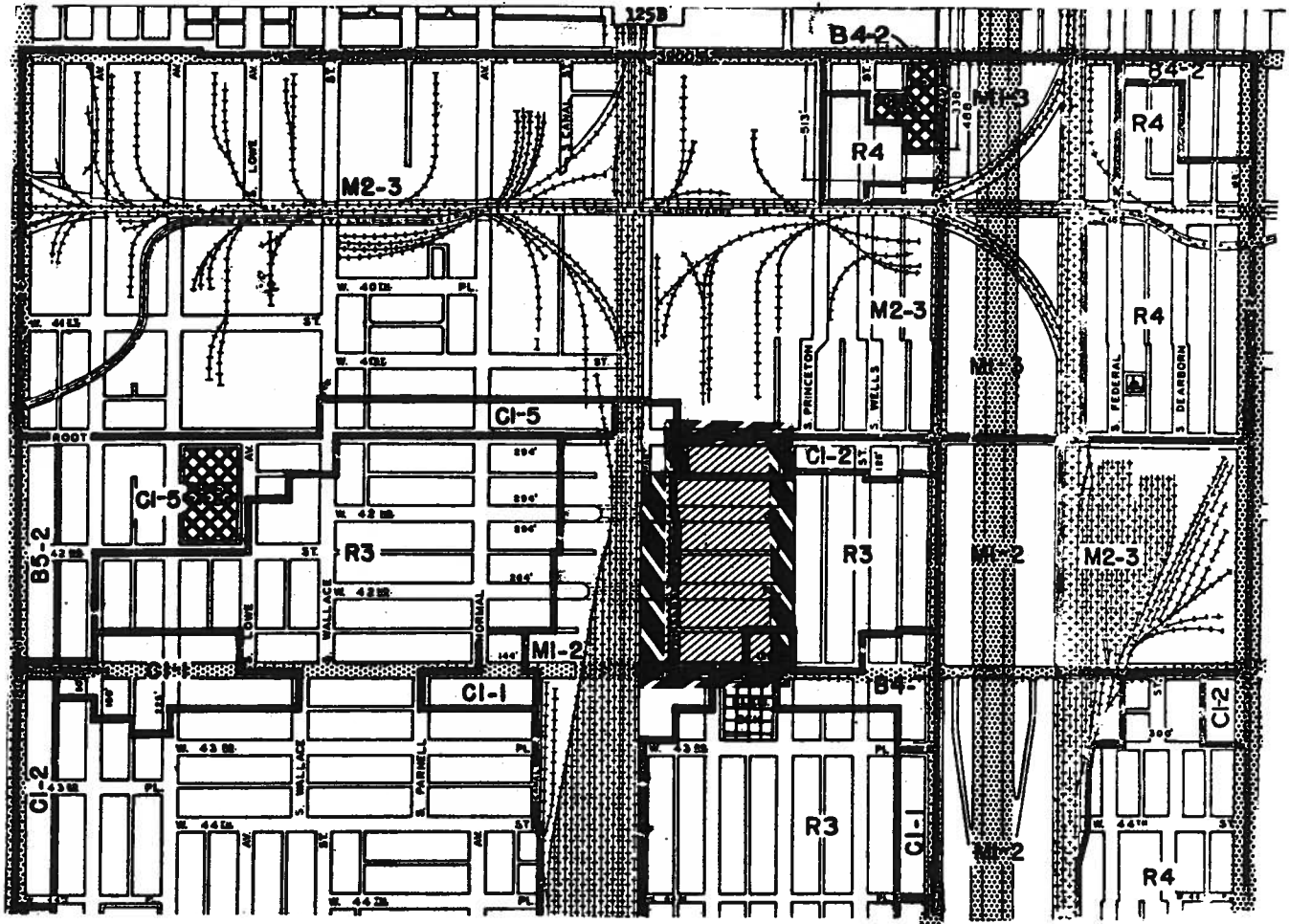

DATE: Oct. 9, 1968

**RESIDENTIAL PLANNED
DEVELOPMENT - No. 54 (as amended)**

EXISTING ZONING AND PREFERENTIAL STREET SYSTEM



LEGEND

-  **ZONING DISTRICTS**
-  **PREFERENTIAL STREETS**
-  **PROPOSED RESIDENTIAL PLANNED DEVELOPMENT**
-  **PUBLIC SCHOOLS**
-  **OTHER PUBLIC, QUASI-PUBLIC & PRIVATE INSTITUTIONS & FACILITIES**



SCALE: 1" = 800'

**APPLICANT: THE CHICAGO
HOUSING AUTHORITY**

DATE: Oct. 9, 1968

RESIDENTIAL PLANNED
DEVELOPMENT- No. 54 (as amended)

GENERALIZED LAND USE PLAN

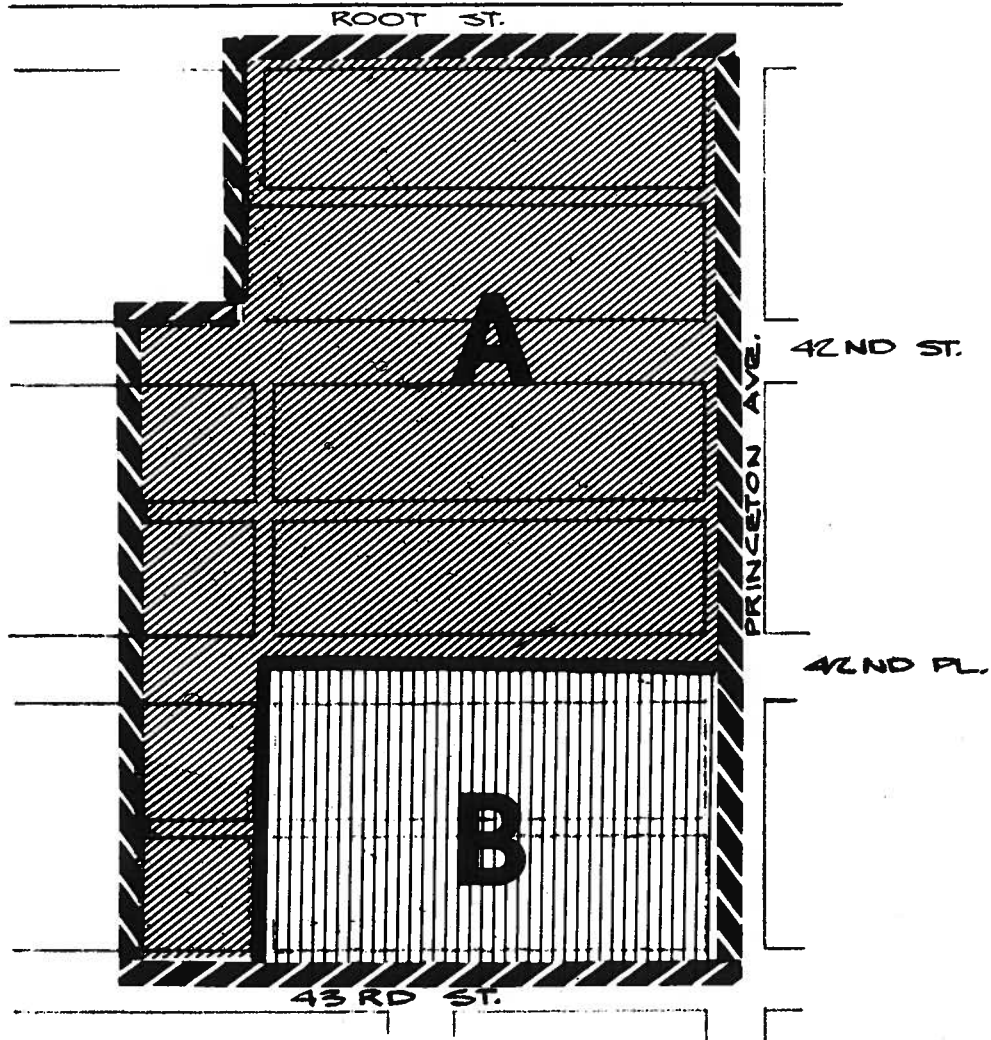

LEGEND



PLANNED DEVELOPMENT BOUNDARY

A

SUB-AREA DESIGNATION



TWO-STORY WALKUPS AND SINGLE
FAMILY DWELLINGS



ONE HIGH-RISE ELEVATOR APARTMENT
BUILDING WITH COMMUNITY SPACE - (Housing for Elderly)



SCALE: 1" = 200'

APPLICANT: THE CHICAGO HOUSING AUTHORITY

DATE: Oct. 9, 1968

RESIDENTIAL PLANNED

DEVELOPMENT - No. 54 (as amended)

PLANNED DEVELOPMENT USE & BULK REGULATIONS & DATA

SUB AREA	NET SITE AREA		GENERAL DESCRIPTION OF LAND USE	NO. OF D.U.'s	MAXIMUM	
	SQ. FT.	ACRES			F.A.R.	% OF LAND COVERED
A	319,272	7.32	24 2-story Walkups 23 Single Family Dwellings	75 23	.7	25
B	108,504	2.5	1 High-Rise Elevator Apartment Building (Housing for Elderly)	339	1.9	15
TOTAL	427,776	9.82		437		

GROSS SITE AREA = NET SITE AREA (427,776 sq. ft.) + AREA OF PUBLIC STREETS AND ALLEYS (182,440.5 sq. ft.) = (14.0 ACRES)

MAXIMUM NUMBER OF D.U.'s - 437

MAXIMUM NUMBER OF D.U.'s/ACRE OF TOTAL SITE AREA - 45

MAXIMUM PERMITTED F.A.R. FOR TOTAL SITE AREA - 1.2

MINIMUM NUMBER OF PARKING SPACES:

Walk-ups and Single Family D.U.'s	- 98
Housing for Elderly Persons	- 68
Total	166

(Additional off-street parking and loading facilities will be provided as authorized (by the R4 General Residence District classification of the Chicago Zoning Ordinance.

MINIMUM SETBACKS - Front Yard - 15'
- Side Yard - 5'
- Rear Yard - 30'

MAXIMUM PERCENTAGE OF LAND COVERED - 20%
(FOR TOTAL NET SITE AREA)

APPLICANT: THE CHICAGO HOUSING AUTHORITY

DATE: Oct. 9, 1968

Said ordinances as passed read respectively as follows (the Italic heading in each case not being a part of the ordinance):

Reclassification of Area Shown on Map No. 1-H.

Be It Ordained by the City Council of the City of Chicago:

SECTION 1. That the Chicago Zoning Ordinance be amended by changing all the R4 General Residence District and all the C1-2 Restricted Commercial District symbols and indications as shown on Map No. 1-H in the area bounded by

W. Lake Street; a line 473.22 feet east of N. Paulina Street; the alley next south of and parallel to W. Lake Street, or the line thereof if extended where no alley exists; a line 459.36 feet east of N. Paulina Street; W. Maypole Street; N. Paulina Street; the south line of W. Maypole Street, or the line thereof if extended where no street exists; and N. Hermitage Avenue,

to the designation of a Residential Planned Development which is hereby established in the area above described, subject to such use and bulk regulations as are set forth in the Plan of Development herewith attached and made a part hereof and to no others.

SECTION 2. This ordinance shall be in force and effect from and after its passage and due publication.

[Plan of Development attached to this ordinance printed on pages 2754 to 2758 of this Journal.]

Reclassification of Area Shown on Map No. 7-G.

Be It Ordained by the City Council of the City of Chicago:

SECTION 1. That the Chicago Zoning Ordinance be amended by changing all the R4 General Residence District symbols and indications as shown on Map No. 7-G in the area bounded by

the alley next south of and parallel to W. Diversey Parkway; N. Sheffield Avenue; N. Lincoln Avenue; N. Kenmore Avenue; the alley next south of the alley next south of and parallel to W. Diversey Parkway; and the alley next west of and parallel to N. Sheffield Avenue,

to the designation of a Residential Planned Development which is hereby established in the area above described, subject to such use and bulk regulations as are set forth in the Plan of Development herewith attached and made a part hereof and to no others.

SECTION 2. This ordinance shall be in force and effect from and after its passage and due publication.

[Plan of Development attached to this ordinance printed on pages 2759 to 2763 of this Journal.]

Reclassification of Area Shown on Map No. 8-E.

Be It Ordained by the City Council of the City of Chicago:

SECTION 1. That the Chicago Zoning Ordinance be amended by changing all the Residential Planned Development No. 41 symbols and indications as shown on Map No. 8-E in the area bounded by

E. 35th Street; S. Rhodes Avenue; E. 37th Street; and the alley next east of and parallel to S. South Park Way,

to the designation of a Residential Planned Development No. 41, as amended, which is hereby

established in the area above described, subject to such use and bulk regulations as are set forth in the Plan of Development herewith attached and made a part hereof and to no others.

SECTION 2. This ordinance shall be in force and effect from and after its passage and due publication.

[Plan of Development attached to this ordinance printed on pages 2764 to 2768 of this Journal.]

Reclassification of Area Shown on Map No. 9-G.

Be It Ordained by the City Council of the City of Chicago:

SECTION 1. That the Chicago Zoning Ordinance be amended by changing all the R-4 General Residence District symbols and indications as shown on Map No. 9-G in the area bounded by

W. Irving Park Road; N. Clark Street; the alley next north of and parallel to W. Byron Street, or the line thereof if extended where no alley exists; the west line of N. Wayne Avenue, or the line thereof if extended where no street exists; a line 45 feet north of the alley next north of and parallel to W. Byron Street; the east line of N. Wayne Avenue, or the line thereof if extended where no street exists; a line 80 feet north of the alley next north of and parallel to W. Byron Street; a line 150 feet east of the east line of N. Wayne Avenue; a line 248 feet north of the alley next north of and parallel to W. Byron Street; and N. Lakewood Avenue,

to the designation of a Residential Planned Development which is hereby established in the area above described, subject to such use and bulk regulations as are set forth in the Plan of Development herewith attached and made a part hereof and to no others.

SECTION 2. This ordinance shall be in force and effect from and after its passage and due publication.

[Plan of Development attached to this ordinance printed on pages 2769 to 2773 of this Journal.]

Reclassification of Area Shown on Map No. 9-H.

Be It Ordained by the City Council of the City of Chicago:

SECTION 1. That the Chicago Zoning Ordinance be amended by changing all the M1-2 Restricted Manufacturing District symbols and indications as shown on Map No. 9-H in the area bounded by

W. Larchmont Avenue; N. Ravenswood Avenue; W. Byron Street; and the east line of the right of way of the C.T.A.,

to those of an M1-4 Restricted Manufacturing District, and a corresponding bulk district is hereby established in the area above described.

SECTION 2. This ordinance shall be in force and effect from and after its passage and due publication.

Reclassification of Area Shown on Map No. 10-F.

Be It Ordained by the City Council of the City of Chicago:

SECTION 1. That the Chicago Zoning Ordinance be amended by changing all the R3 General Residence District, B4-1 Restricted Service District, and M1-2 Restricted Manufacturing District symbols and indications as shown on Map No. 10-F in the area bounded by

[Continued on page 2774.]

2054

[Continued from page 2753]

W. Root Street; S. Princeton Avenue; W. 43rd Street; the west line of S. Stewart Avenue, or the line thereof if extended where no street exists; W. 42nd Street; and a line 63 feet east of the west line of S. Stewart Avenue,

to the designation of a Residential Planned Development which is hereby established in the area above described, subject to such use and bulk regulations as are set forth in the Plan of Development herewith attached and made a part hereof and to no others.

SECTION 2. This ordinance shall be in force and effect from and after its passage and due publication.

[Plan of Development attached to this ordinance printed on pages 2776 to 2780 of this Journal.]

Reclassification of Area Shown on Map No. 11-L.

Be It Ordained by the City Council of the City of Chicago:

SECTION 1. That the Chicago Zoning Ordinance be amended by changing all the B2-1 Restricted Retail District symbols and indications as shown on Map No. 11-L in the area bounded by

N. Milwaukee Avenue; a line drawn from a point 50 feet north of W. Pensacola Avenue; along the east line of N. Milwaukee Avenue to a point 105 feet north of W. Pensacola Avenue; along the west line of the alley next east of N. Milwaukee Avenue; the alley next east of N. Milwaukee Avenue; and W. Pensacola Avenue,

to those of a B4-1 Restricted Service District, and a corresponding use district is hereby established in the area above described.

SECTION 2. This ordinance shall be in force and effect from and after its passage and due publication.

Reclassification of Area Shown on Map No. 11-M.

Be It Ordained by the City Council of the City of Chicago:

SECTION 1. That the Chicago Zoning Ordinance be amended by changing all the R2 Single Family Residence District and R3 General Residence District symbols and indications as shown on Map No. 11-M in the area bounded by

W. Cullom Avenue; N. Austin Avenue; W. Berbeau Avenue; N. McVicker Avenue; a line 149 feet 6 inches south of W. Cullom Avenue; and the alley next west of and parallel to N. McVicker Avenue,

to those of an R4 General Residence District, and a corresponding use district is hereby established in the area above described.

SECTION 2. This ordinance shall be in force and effect from and after its passage and due publication.

Reclassification of Area Shown on Map No. 12-M.

Be It Ordained by the City Council of the City of Chicago:

SECTION 1. That the Chicago Zoning Ordinance be amended by changing all the R3 General Resi-

dence District symbols and indications as shown on Map No. 12-M in the area bounded by

a line 297 feet north of W. 55th Street; a line 368 feet east of S. Austin Avenue; W. 55th Street; and a line 302.85 feet east of S. Austin Avenue,

to those of an R4 General Residence District, and a corresponding use district is hereby established in the area above described.

SECTION 2. This ordinance shall be in force and effect from and after its passage and due publication.

Reclassification of Area Shown on Map No. 13-M.

Be It Ordained by the City Council of the City of Chicago:

SECTION 1. That the Chicago Zoning Ordinance be amended by changing all the B4-1 Restricted Service District symbols and indications as shown on Map No. 13-M in the area bounded by

W. Higgins Avenue; N. Austin Avenue; the alley next south of and parallel to W. Higgins Avenue; and a line drawn from a point 232 feet 6 inches west of N. Austin Avenue; along the north line of the alley next south of and parallel to W. Higgins Avenue to a point 170 feet west of N. Austin Avenue; and along the south line of W. Higgins Avenue,

to those of an R4 General Residence District, and a corresponding use district is hereby established in the area above described.

SECTION 2. This ordinance shall be in force and effect from and after its passage and due publication.

Reclassification of Area Shown on Map No. 15-N.

Be It Ordained by the City Council of the City of Chicago:

SECTION 1. That the Chicago Zoning Ordinance be amended by changing all the R3 General Residence District symbols and indications as shown on Map No. 15-N in the area bounded by

N. Neva Avenue; W. Imlay Street; the alley next northeast of N. Northwest Highway; the alley next south of and parallel to W. Imlay Street; the alley next northeast of N. Northwest Highway; the alley next northwest of N. Sayre Avenue; and N. Northwest Highway,

to those of an R4 General Residence District, and a corresponding use district is hereby established in the area above described.

SECTION 2. This ordinance shall be in force and effect from and after its passage and due publication.

Reclassification of Area Shown on Map No. 17-G.

Be It Ordained by the City Council of the City of Chicago:

SECTION 1. That the Chicago Zoning Ordinance be amended by changing all the R3 General Residence District, B5-4 General Service District and Planned Development symbols and indications as shown on Map No. 17-G in the area bounded by

W. Albion Avenue; the alley next east of and

PLAN OF DEVELOPMENT
RESIDENTIAL PLANNED DEVELOPMENT

54

STATEMENTS

1. The area delineated hereon as a "Residential Planned Development" is owned and controlled by the Chicago Housing Authority.
2. Off-Street parking and loading facilities will be provided in compliance with this Plan of Development as authorized by the R4 General Residence District of the Chicago Zoning Ordinance.
3. Any dedication of streets or alleys or adjustments of the rights of way or consolidation or resubdivision of parcels shall require a separate submittal on behalf of the Chicago Housing Authority and approval by the City Council.
4. All applicable official reviews, approvals or permits are required to be obtained by the Chicago Housing Authority.
5. Service drives or any other ingress or egress shall be adequately designed and paved in accord with the regulations of the Department of Streets and Sanitation and in compliance with the Municipal Code of Chicago to provide ingress and egress for motor vehicles, including emergency vehicles. There shall be no parking permitted within such paved areas.

Fire lanes shall be adequately designed and paved in compliance with the Municipal Code of Chicago to provide ingress and egress for emergency vehicles; there shall be no parking within such paved areas.

6. Use of land will consist of two high-rise elevator apartment buildings (housing for elderly persons), 2 story walkup apartments, single family dwellings, a community building and recreational areas and facilities as authorized by the Chicago Zoning Ordinance.
7. The following information sets forth data concerning the property included in said planned development and data concerning a generalized land use plan (site plan) illustrating the development of said property in accordance with the intent and purpose of the Chicago Zoning Ordinance as related to an R4 General Residence District classification and with regulations hereby made applicable thereto.
8. The Plan of Development hereby attached shall be subject to the "Rules, Regulations and Procedures in Relation to Planned Developments", as adopted by the Commissioner of Development and Planning.

APPLICANT: CHICAGO HOUSING AUTHORITY

DATE: March 6, 1968



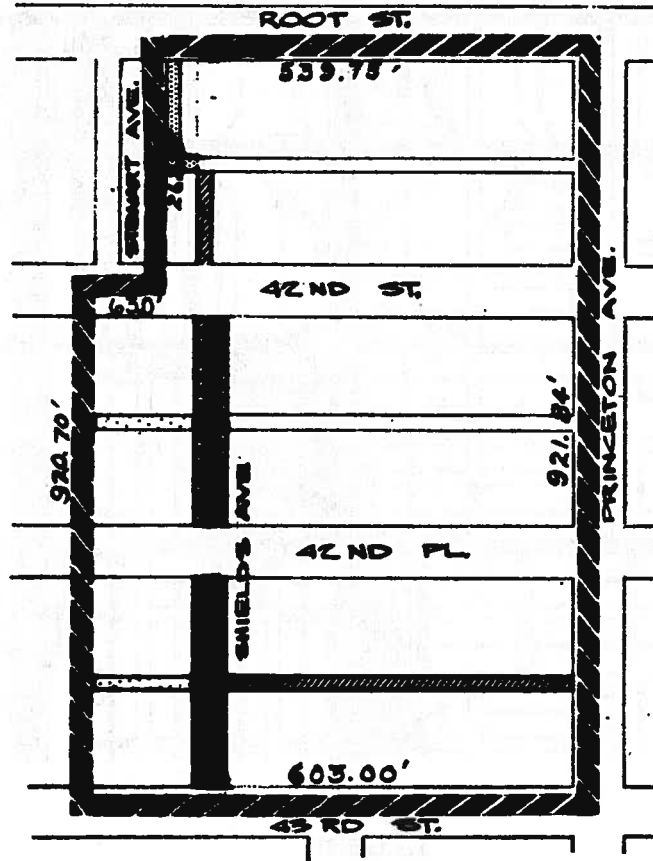

RESIDENTIAL PLANNED DEVELOPMENT

PROPERTY LINE MAP & RIGHT OF WAY ADJUSTMENTS



LEGEND

SCALE: 1" = 200'

-  PLANNED DEVELOPMENT BOUNDARY
-  ALLEYS TO BE DEDICATED
-  ALLEYS TO BE VACATED
-  STREETS TO BE VACATED

APPLICANT: THE CHICAGO HOUSING AUTHORITY

DATE: March 6, 1968

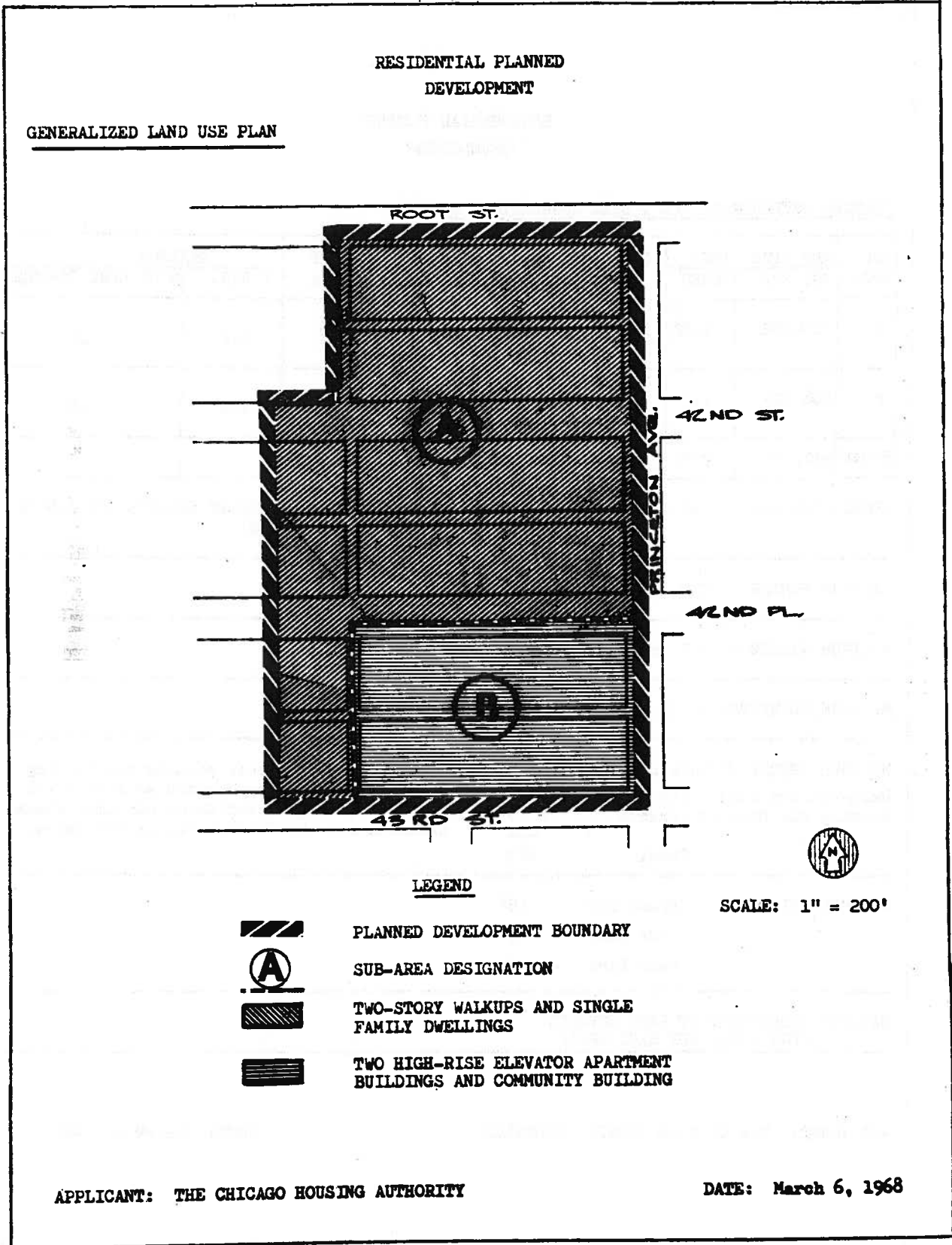

RESIDENTIAL PLANNED
DEVELOPMENT

PLANNED DEVELOPMENT USE & BULK REGULATIONS & DATA

SUB AREA	NET SITE AREA		GENERAL DESCRIPTION OF LAND USE	NO. OF D.U.'s	MAXIMUM	
	SQ. FT.	ACRES			F.A.R.	% OF LAND COVERED
A	319,272	7.32	24 2-story walkups 23 Single Family Dwellings	75 23	1.2	25
B	108,504	2.5	2 High-Rise Elevator Apartment Buildings	324	1.2	15
TOTAL	427,776	9.82		422		

GROSS SITE AREA = NET SITE AREA (427,776 sq. ft.) + AREA OF PUBLIC STREETS AND ALLEYS
(182,440.5 sq. ft.) = (14.0 ACRES)

MAXIMUM NUMBER OF D.U.'s - 422

MAXIMUM NUMBER OF D.U.'s/ACRE OF TOTAL SITE AREA - 48

MAXIMUM PERMITTED F.A.R. FOR TOTAL SITE AREA - 1.2

MINIMUM NUMBER OF PARKING SPACES:

Walk-ups and Single Family D.U.'s - 98
Housing for Elderly Persons - 65

Total 163

(Additional off-street parking and loading facilities will be provided as authorized (by the R4 General Residence District classification of the Chicago Zoning Ordinance.

MINIMUM SETBACKS - Front Yard - 15'
- Side Yard - 5'
- Rear Yard - 30'

MAXIMUM PERCENTAGE OF LAND COVERED - 20%
(FOR TOTAL NET SITE AREA)

APPLICANT: THE CHICAGO HOUSING AUTHORITY

DATE: March 6, 1968