

Said ordinances as passed read respectively as follows (the *Italic heading* in each case not being a part of the ordinance):

*Reclassification of Area Shown on Map No. 1-H.*

*Be It Ordained by the City Council of the City of Chicago:*

SECTION 1. That the Chicago Zoning Ordinance be amended by changing all the R4 General Residence District and all the C1-2 Restricted Commercial District symbols and indications as shown on Map No. 1-H in the area bounded by

W. Lake Street; a line 473.22 feet east of N. Paulina Street; the alley next south of and parallel to W. Lake Street, or the line thereof if extended where no alley exists; a line 459.36 feet east of N. Paulina Street; W. Maypole Street; N. Paulina Street; the south line of W. Maypole Street, or the line thereof if extended where no street exists; and N. Hermitage Avenue,

to the designation of a Residential Planned Development which is hereby established in the area above described, subject to such use and bulk regulations as are set forth in the Plan of Development herewith attached and made a part hereof and to no others.

SECTION 2. This ordinance shall be in force and effect from and after its passage and due publication.

[Plan of Development attached to this ordinance printed on pages 2754 to 2758 of this Journal.]

*Reclassification of Area Shown on Map No. 7-G.*

*Be It Ordained by the City Council of the City of Chicago:*

SECTION 1. That the Chicago Zoning Ordinance be amended by changing all the R4 General Residence District symbols and indications as shown on Map No. 7-G in the area bounded by

the alley next south of and parallel to W. Diversey Parkway; N. Sheffield Avenue; N. Lincoln Avenue; N. Kenmore Avenue; the alley next south of the alley next south of and parallel to W. Diversey Parkway; and the alley next west of and parallel to N. Sheffield Avenue,

to the designation of a Residential Planned Development which is hereby established in the area above described, subject to such use and bulk regulations as are set forth in the Plan of Development herewith attached and made a part hereof and to no others.

SECTION 2. This ordinance shall be in force and effect from and after its passage and due publication.

[Plan of Development attached to this ordinance printed on pages 2759 to 2763 of this Journal.]

*Reclassification of Area Shown on Map No. 8-E.*

*Be It Ordained by the City Council of the City of Chicago:*

SECTION 1. That the Chicago Zoning Ordinance be amended by changing all the Residential Planned Development No. 41 symbols and indications as shown on Map No. 8-E in the area bounded by

E. 35th Street; S. Rhodes Avenue; E. 37th Street; and the alley next east of and parallel to S. South Park Way,

to the designation of a Residential Planned Development No. 41, as amended, which is hereby

established in the area above described, subject to such use and bulk regulations as are set forth in the Plan of Development herewith attached and made a part hereof and to no others.

SECTION 2. This ordinance shall be in force and effect from and after its passage and due publication.

[Plan of Development attached to this ordinance printed on pages 2764 to 2768 of this Journal.]

*Reclassification of Area Shown on Map No. 9-G.*

*Be It Ordained by the City Council of the City of Chicago:*

SECTION 1. That the Chicago Zoning Ordinance be amended by changing all the R-4 General Residence District symbols and indications as shown on Map No. 9-G in the area bounded by

W. Irving Park Road; N. Clark Street; the alley next north of and parallel to W. Byron Street, or the line thereof if extended where no alley exists; the west line of N. Wayne Avenue, or the line thereof if extended where no street exists; a line 45 feet north of the alley next north of and parallel to W. Byron Street; the east line of N. Wayne Avenue, or the line thereof if extended where no street exists; a line 80 feet north of the alley next north of and parallel to W. Byron Street; a line 150 feet east of the east line of N. Wayne Avenue; a line 248 feet north of the alley next north of and parallel to W. Byron Street; and N. Lakewood Avenue,

to the designation of a Residential Planned Development which is hereby established in the area above described, subject to such use and bulk regulations as are set forth in the Plan of Development herewith attached and made a part hereof and to no others.

SECTION 2. This ordinance shall be in force and effect from and after its passage and due publication.

[Plan of Development attached to this ordinance printed on pages 2769 to 2773 of this Journal.]

*Reclassification of Area Shown on Map No. 9-H.*

*Be It Ordained by the City Council of the City of Chicago:*

SECTION 1. That the Chicago Zoning Ordinance be amended by changing all the M1-2 Restricted Manufacturing District symbols and indications as shown on Map No. 9-H in the area bounded by

W. Larchmont Avenue; N. Ravenswood Avenue; W. Byron Street; and the east line of the right of way of the C.T.A.,

to those of an M1-4 Restricted Manufacturing District, and a corresponding bulk district is hereby established in the area above described.

SECTION 2. This ordinance shall be in force and effect from and after its passage and due publication.

*Reclassification of Area Shown on Map No. 10-F.*

*Be It Ordained by the City Council of the City of Chicago:*

SECTION 1. That the Chicago Zoning Ordinance be amended by changing all the R3 General Residence District, B4-1 Restricted Service District, and M1-2 Restricted Manufacturing District symbols and indications as shown on Map No. 10-F in the area bounded by

[Continued on page 2774]

PD 41

Pass 8/25/66  
5/8/68

PLAN OF DEVELOPMENT

RESIDENTIAL PLANNED DEVELOPMENT NO. 41, As Amended

STATEMENTS

1. The area delineated hereon as "Residential Planned Development" is controlled by the City of Chicago as follows:
  - A. Redevelopment Project 37th-Cottage Grove Disposition Parcel A and B Secondary Stage owned by the Department of Urban Renewal of the City of Chicago.
  - B. Redevelopment Project 37th-Cottage Grove Disposition Parcel A and B Interim Stage conveyed to Service Development Associates, for which Service Development Associates has by agreement designated the Department of Urban Renewal of the City of Chicago to be the sole applicant on and in behalf of said Service Development Associates, its assigns and successors, for the purpose of obtaining and establishing a Planned Development, said agreement having been recorded as Document No. \_\_\_\_\_ in the Office of the Recorder of Deeds of Cook County on \_\_\_\_\_, 1968.
2. Off-Street parking facilities shall be provided in compliance with this Plan of Development as authorized by the Chicago Zoning Ordinance.
3. Any dedication or vacation of streets or alleys or adjustment of rights-of-way or consolidation or resubdivision of parcels shall require a separate submittal on behalf of the Department of Urban Renewal and approval by the City Council.
4. All applicable official reviews, approvals or permits are required to be obtained by the following:
  - A. Department of Urban Renewal or its successor upon conveyance of Redevelopment Project 37th-Cottage Grove Parcel A and B Secondary Stage.
  - B. Service Development Associates.
5. Service drives or any other ingress or egress shall be adequately designed and paved to provide ingress and egress for motor vehicles, including emergency vehicles. There shall be no parking within such paved areas.
6. Use of land will consist of rowhouses, elevator apartment structures, private recreation, and related convenience-type business uses.

7. The following information sets forth data concerning the property included in said Planned Development and data concerning a generalized land use plan (site plan) illustrating the development of said property in accordance with the intent and purpose of the Chicago Zoning Ordinance as related to a R5 General Residence District and a B2-1 Restricted Retail District and with the regulations hereby made applicable thereto.
8. The Plan of Development hereby attached shall be subject to the "Rules, Regulations and Procedures in relation to Planned Developments."

APPLICANT: DEPARTMENT OF URBAN RENEWAL OF THE CITY OF CHICAGO

DATE: January 30, 1968

# RESIDENTIAL PLANNED DEVELOPMENT NO. 41, AS AMENDED PROPERTY LINE MAP AND RIGHTS OF WAY ADJUSTMENTS

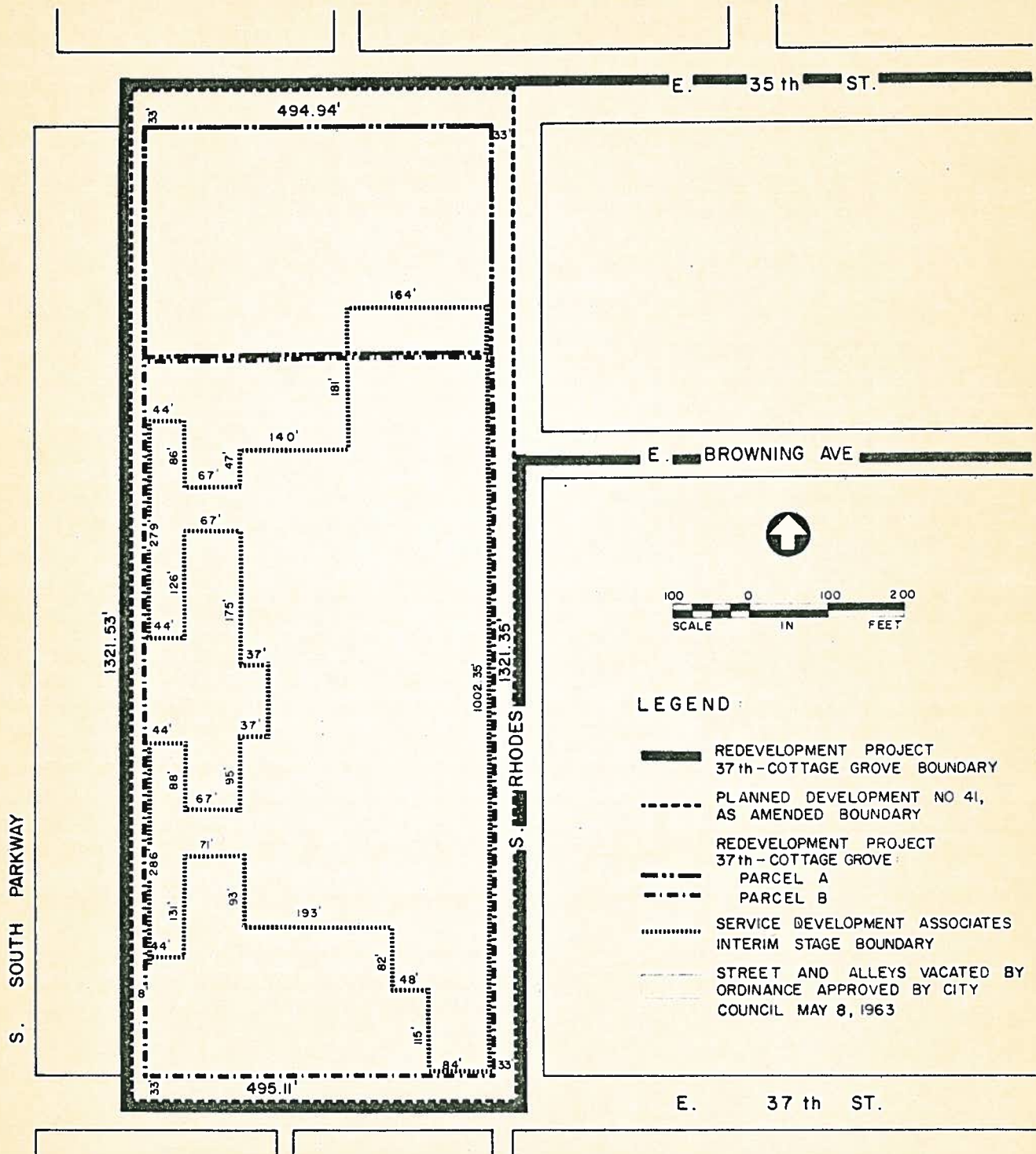

APPLICANT : DEPARTMENT OF URBAN RENEWAL  
OF THE CITY OF CHICAGO

DATE : JANUARY 30, 1968

# RESIDENTIAL PLANNED DEVELOPMENT

## EXISTING ZONING AND PREFERENTIAL STREET SYSTEM

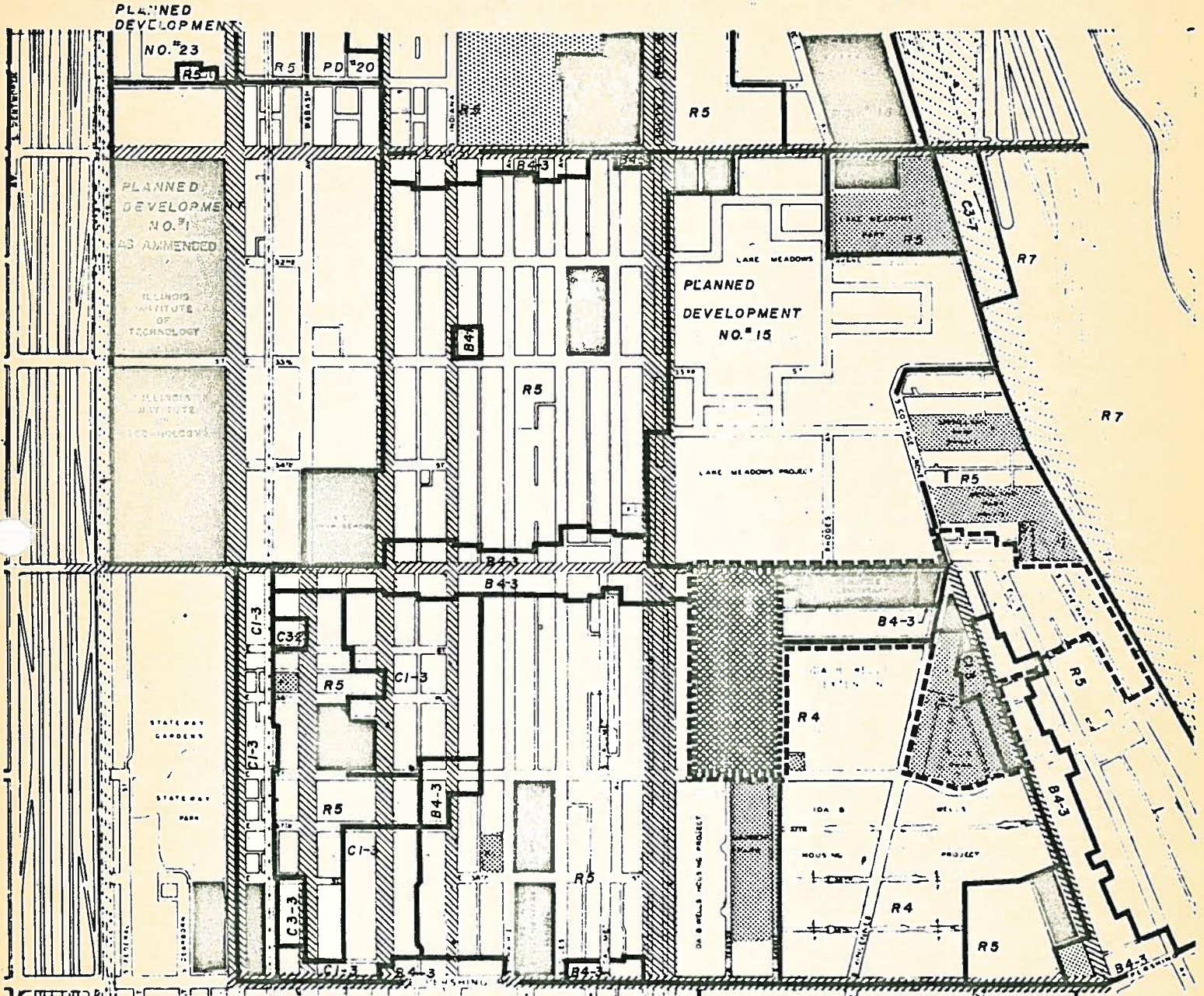

**LEGEND**

- |  |   |  |  |
|--|---|--|--|
|  | ZONING BOUNDARY                           |  | PREFERENTIAL STREETS                     |
|  | PARKS & PLAYGROUNDS                       |  | PROPOSED RESIDENTIAL PLANNED DEVELOPMENT |
|  | SCHOOLS PUBLIC AND QUASI PUBLIC BUILDINGS |  | BOUNDARY REDEVELOPMENT PROJECT           |

APPLICANT: THE DEPARTMENT OF URBAN RENEWAL OF THE CITY OF CHICAGO

DATE: MAY 16, 1966

SCALE 225 0 225 450

RESIDENTIAL PLANNED DEVELOPMENT NO. 41, AS AMENDED  
GENERALIZED LAND USE PLAN

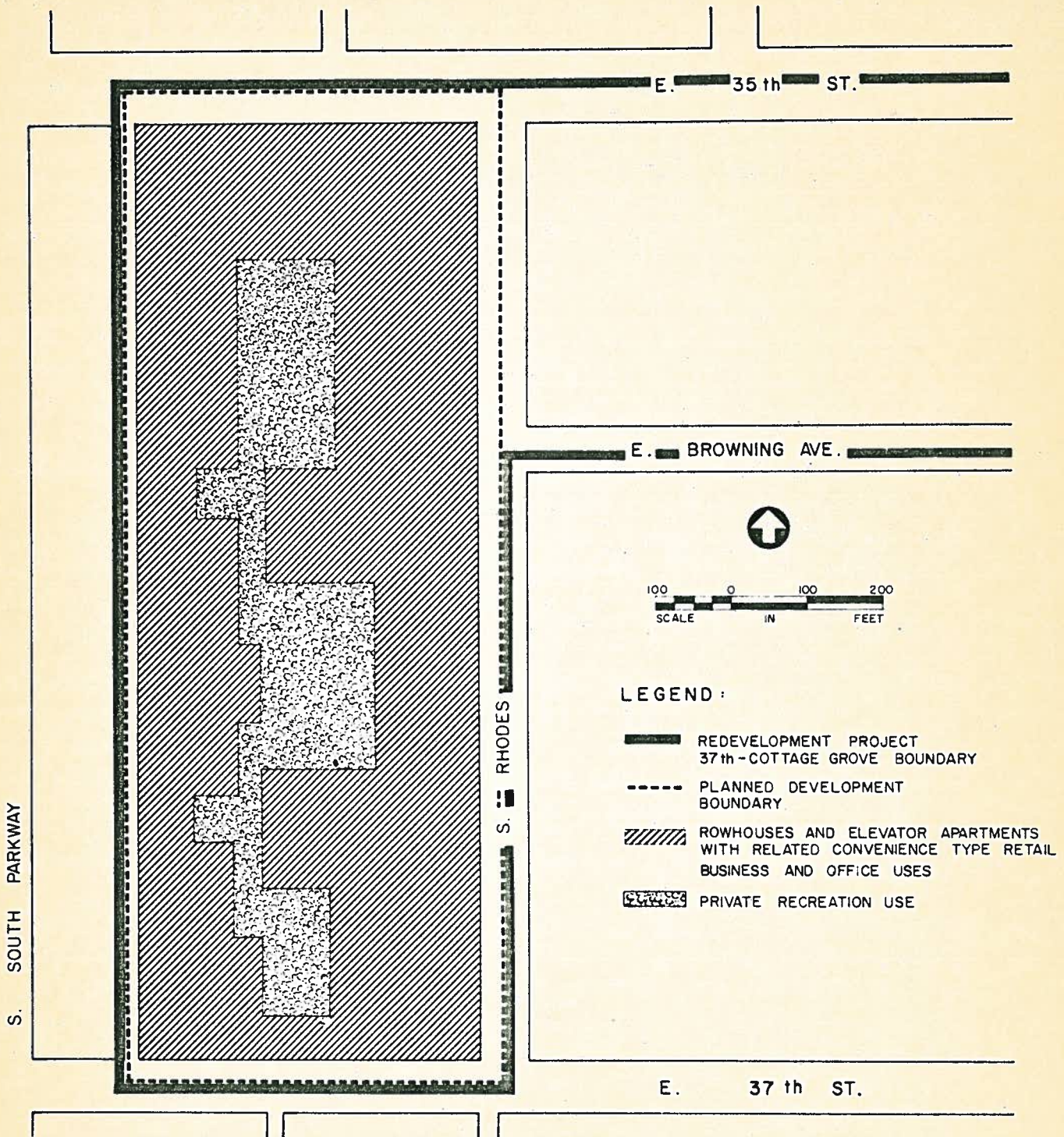

APPLICANT: DEPARTMENT OF URBAN RENEWAL  
OF THE CITY OF CHICAGO

DATE: JANUARY 30, 1968

## RESIDENTIAL PLANNED DEVELOPMENT

### Planned Development Use and Bulk Regulations and Data

NET SITE AREA		GENERAL DESCRIPTION OF LAND USE	NUMBER OF DWELLING UNITS	MAXIMUM F.A.R.	MAXIMUM % OF LAND COVERAGE
SQUARE FEET	ACRES				
570,000.75	13.09	ROWHOUSES, ELEVATOR APTS. W/RELATED CONVENIENCE TYPE BUSINESS USES, PRIVATE RECREATION AREAS, RETAIL BUSINESS AND OFFICE USE	54 690	2.2	25

NET SITE AREA = 570,000.75 square feet = 13.09 acres  
 GROSS SITE AREA = NET SITE AREA (13.09 acres) + AREA OF PUBLIC STREETS AND ALLEYS (1.92 acres) = 15.01 acres

MAXIMUM NUMBER OF DWELLING UNITS PER ACRE OF TOTAL NET RESIDENTIAL AREA: 53

MAXIMUM PERMITTED F.A.R. FOR TOTAL NET SITE AREA: 2.2

MINIMUM NUMBER OF PARKING SPACES REQUIRED: 572

MINIMUM OFF-STREET LOADING BERTHS: ELEVATOR APTS. - Between 10,000,200,000 sq. ft. - one space, each additional 200,000 sq.ft. or fraction thereof - one space.  
 BUSINESS - Between 10,000-100,000 sq. ft. - one space.

MINIMUM PARKING REQUIREMENTS:

ROWHOUSE	100%	1 space for each 500 s.f. of floor area in excess of 4000 s.f.
ELEVATOR APARTMENTS	75%	
BUSINESS AND OFFICE USE		

MINIMUM SETBACKS:

	FRONT YARDS	SIDE YARDS
ELEVATOR APTS.	25 ft.	20 ft.
ROWHOUSES	15 ft.	7.5 ft.

MINIMUM DISTANCES BETWEEN BUILDING FRONT AND REAR WALLS:  
 Elevator Apts: 80 ft.      Rowhouse: 50 ft.

MAXIMUM PERCENTAGE OF LAND COVERAGE FOR TOTAL NET SITE AREA: 25%

APPLICANT: DEPARTMENT OF URBAN RENEWAL OF THE CITY OF CHICAGO      DATE: JANUARY 30, 1968

## UNFINISHED BUSINESS.

### Chicago Zoning Ordinance Amended to Reclassify Particular Areas.

On motion of Alderman Metcalfe the City Council took up for consideration the report of the Committee on Buildings and Zoning deferred and published on July 11, 1966, pages 7050-7051, recommending that the City Council pass eight proposed ordinances transmitted with the committee's report for amendment of the Chicago Zoning Ordinance to reclassify particular areas.

On separate motions made by Alderman Metcalfe each of said eight proposed ordinances was *Passed*, by yeas and nays as follows:

*Yeas*—Aldermen Parrillo, Harvey, Metcalfe, Holman, Despres, Miller, Bohling, Condon, Lupo, Buchanan, Danaher, Zelezinski, Healy, Krska, Murray, Fitzpatrick, Campbell, Yaksic, Janousek, Tourek, Collins, Marzullo, Zydlo, Sain, Provenzano, T. F. Burke, McMahon, Keane, Sulski, Sande, Laskowski, Aiello, Casey, Cullerton, Laurino, Kaplan, Scholl, Goldberg, Rosenberg, Fifielski, Kerwin, O'Rourke, Wigoda, Sperling—44.

*Nays*—None.

Said ordinances as passed read respectively as follows (the *Italic heading* not being a part of the ordinance):

#### *Reclassification of Area Shown on Map No. 1-I.*

#### *Be It Ordained by the City Council of the City of Chicago:*

SECTION 1. That the Chicago Zoning Ordinance be amended by changing all the M1-2 Restricted Manufacturing District and all the M2-2 General Manufacturing District symbols and indications as shown on Map No. 1-I in the area bounded by

the alley next south of and parallel to W. Fulton Street; N. Western Avenue; W. Washington Street; N. Campbell Avenue; W. Lake Street; and N. Campbell Avenue,

to those of an M2-3 General Manufacturing District, and a corresponding use district is hereby established in the area above described.

SECTION 2. This ordinance shall be in force and effect from and after its passage and due publication.

#### *Reclassification of Area Shown on Map No. 5-N.*

#### *Be It Ordained by the City Council of the City of Chicago:*

SECTION 1. That the Chicago Zoning Ordinance be amended by changing all the B4-1 Restricted Service District symbols and indications as shown on Map No. 5-N in the area bounded by

W. Grand Avenue; N. Normand Avenue; the

alley next south of and parallel to W. Grand Avenue; and N. Rutherford Avenue,

to those of a C2-1 General Commercial District, and a corresponding use district is hereby established in the area above described.

SECTION 2. This ordinance shall be in force and effect from and after its passage and due publication.

#### *Reclassification of Area Shown on Map No. 6-E.*

#### *Be It Ordained by the City Council of the City of Chicago:*

SECTION 1. That the Chicago Zoning Ordinance be amended by changing all the C2-3 General Commercial District, C2-4 General Commercial District, B4-3 Restricted Service District, R4 General Residence District, R5 General Residence District symbols and indications as shown on Map No. 6-E in the area bounded by

E. 26th Street; S. Prairie Avenue; the south line of E. 29th Street; the east line of S. Indiana Avenue; E. 31st Street, S. Michigan Avenue, a line 200 feet south of E. 26th Street and the west line of S. Indiana Avenue,

to the designation of a Residential Planned Development which is hereby established in the area above described, subject to such use and bulk regulations as are set forth in the Plan of Development herewith attached and made a part hereof and to no others.

SECTION 2. This ordinance shall be in force and effect from and after its passage and due publication.

[The Plan of Development attached to this ordinance is printed on pages 7212-7216.]

#### *Reclassification of Area Shown on Map No. 8-E.*

#### *Be It Ordained by the City Council of the City of Chicago:*

SECTION 1. That the Chicago Zoning Ordinance be amended by changing all the R5 General Residence District, B2-3 Restricted Retail District, and B4-3 Restricted Service District symbols and indications as shown on Map No. 8-E in the area bounded by

E. 35th Street; S. Rhodes Avenue; E. 37th Street; and the alley next east of and parallel to S. South Park Way,

to the designation of a Residential Planned Development which is hereby established in the area above described, subject to such use and bulk regulations as are set forth in the Plan of Development herewith attached and made a part hereof and to no others.

SECTION 2. This ordinance shall be in force and effect from and after its passage and due publication.

(Continued on page 7217)

(Continued from page 7211)

The following is the Plan of Development attached to the foregoing ordinance:

Plan of Development  
Residential Planned Development  
Statements

1. The area delineated hereon as "Residential Planned Development" is owned and controlled by the Department of Urban Renewal of the City of Chicago and designated as Redevelopment Project 37th-Cottage Grove—Parcel A and B.

2. Off-Street parking facilities shall be provided in compliance with this Plan of Development as authorized by the Chicago Zoning Ordinance.

3. Any dedication or vacation of streets or alleys or adjustment of rights-of-way or consolidation or resubdivision of parcels shall require a separate submittal on behalf of the Department of Urban Renewal and approval by the City Council.

4. All applicable official reviews, approvals or permits are required to be obtained by the

Department of Urban Renewal or its successor upon conveyance of Redevelopment Project 37th-Cottage Grove—Parcel A and B.

5. Service drives or any other ingress or egress shall be adequately designed and paved to provide ingress and egress for motor vehicles including emergency vehicles. There shall be no parking within such paved areas.

6. Use of land will consist of rowhouses, elevator apartment structures, private recreation, and related convenience-type business uses.

7. The following information sets forth data concerning the property included in said Planned Development and data concerning a generalized land use plan (site plan) illustrating the development of said property in accordance with the intent and purpose of the Chicago Zoning Ordinance as related to an R5 General Residence District (as applied to Sub-Area A) and a B2-1 Restricted Retail District (as applied to Sub-Area B), and with the regulations hereby made applicable thereto.

8. The Plan of Development hereby attached shall be subject to the "Rules, Regulations and Procedures in relation to Planned Developments."

APPLICANT: DEPARTMENT OF URBAN RENEWAL  
OF THE CITY OF CHICAGO

Date: May 16, 1966.

[Maps attached to the Plan of Development printed on pages 7218-7221.]

*Reclassification of Area Shown on Map No. 17-G.*

*Be It Ordained by the City Council of the City of Chicago:*

SECTION 1. That the Chicago Zoning Ordinance be amended by changing all the B2-2 Restricted Retail District symbols and indications as shown on Map No. 17-G in the area bounded by

the alley next north of and parallel to W. Lunt Avenue; N. Glenwood Avenue; the alley next south of and parallel to W. Lunt Avenue; a line 150 feet west of N. Glenwood Avenue; W. Lunt Avenue; and a line 75 feet west of N. Glenwood Avenue,

to those of a B2-3 Restricted Retail District, and a corresponding bulk district is hereby established in the area above described.

SECTION 2. This ordinance shall be in force and effect from and after its passage and due publication.

*Reclassification of Area Shown on Map No. 20-H.*

*Be It Ordained by the City Council of the City of Chicago:*

SECTION 1. That the Chicago Zoning Ordinance be amended by changing all the R4 General Residence District symbols and indications as shown on Map No. 20-H in the area bounded by

W. 79th Street; S. Honore Street; the alley next south of and parallel to W. 79th Street; and S. Wolcott Avenue,

to those of a B4-2 Restricted Service District, and a corresponding use district is hereby established in the area above described.

SECTION 2. This ordinance shall be in force and effect from and after its passage and due publication.

*Reclassification of Area Shown on Map No. 22-C.*

*Be It Ordained by the City Council of the City of Chicago:*

SECTION 1. That the Chicago Zoning Ordinance be amended by changing all the R2 Single Family Residence District symbols and indications as shown on Map No. 22-C in the area bounded by

the alley next north of E. 87th Place; a line 200 feet east of S. Stony Island Avenue; E. 87th Place; and a line 125 feet east of S. Stony Island Avenue,

to those of a B4-2 Restricted Service District, and a corresponding use district is hereby established in the area above described.

SECTION 2. This ordinance shall be in force and effect from and after its passage and due publication.

*Reclassification of Area Shown on Map No. 32-E.*

*Be It Ordained by the City Council of the City of Chicago:*

SECTION 1. That the Chicago Zoning Ordinance be amended by changing all the R3 General Residence District symbols and indications as shown on Map No. 32-E in the area bounded by

a line 783.52 feet north of E. 133rd Street; a line drawn from a point 1149.26 feet east of S. Indiana Avenue and 783.52 feet north of E. 133rd Street to a point 675.44 feet north of E. 133rd Street along the west line of the right of way of the Chicago and Western Indiana Railroad; the west line of the right of way of the Chicago and Western Indiana Railroad; E. 133rd Street; a line 184.16 feet west of the west right of way of the Chicago and Western Indiana Railroad; a line 351 feet north of E. 133rd Street; a line 450.41 feet east of S. Indiana Avenue; E. 133rd Street; and S. Indiana Avenue,

to the designation of a Residential Planned Development which is hereby established in the area above described, subject to such use and bulk regulations as are set forth in the Plan of Development herewith attached and made a part hereof and to no others.

SECTION 2. This ordinance shall be in force and effect from and after its passage and due publication.

[Plan of Development attached to the foregoing ordinance is printed on pages 7223-7227.]

(Continued on page 7222)

A808 Passed 8-25-66  
CJP - 7211, 7218-722

PLAN OF DEVELOPMENT #41

RESIDENTIAL PLANNED DEVELOPMENT

STATEMENTS

1. The area delineated hereon as "Residential Planned Development" is owned and controlled by the Department of Urban Renewal of the City of Chicago and designated as Redevelopment Project 37th-Cottage Grove - Parcel A and B.
2. Off-Street parking facilities shall be provided in compliance with this Plan of Development as authorized by the Chicago Zoning Ordinance.
3. Any dedication or vacation of streets or alleys or adjustment of rights-of-way or consolidation or resubdivision of parcels shall require a separate submittal on behalf of the Department of Urban Renewal and approval by the City Council.
4. All applicable official reviews, approvals or permits are required to be obtained by the

Department of Urban Renewal or its successor upon conveyance of Redevelopment Project 37th-Cottage Grove - Parcel A and B.

5. Service drives or any other ingress or egress shall be adequately designed and paved to provide ingress and egress for motor vehicles including emergency vehicles. There shall be no parking within such paved areas.
6. Use of land will consist of rowhouses, elevator apartment structures, private recreation, and related convenience - type business uses.
7. The following information sets forth data concerning the property included in said Planned Development and data concerning a generalized land use plan (site plan) illustrating the development of said property in accordance with the intent and purpose of the Chicago Zoning Ordinance as related to a R5 General Residence District (as applied to SUB-AREA A) and a B2-1 Restricted Retail District (as applied to SUB-AREA B), and with the regulations hereby made applicable thereto.
8. The Plan of Development hereby attached shall be subject to the "Rules, Regulations and Procedures in relation to Planned Developments."

APPLICANT: DEPARTMENT OF URBAN RENEWAL OF THE CITY OF CHICAGO  
DATE: MAY 16 , 1966

# RESIDENTIAL PLANNED DEVELOPMENT

## PROPERTY LINE MAP AND RIGHTS OF WAY ADJUSTMENTS

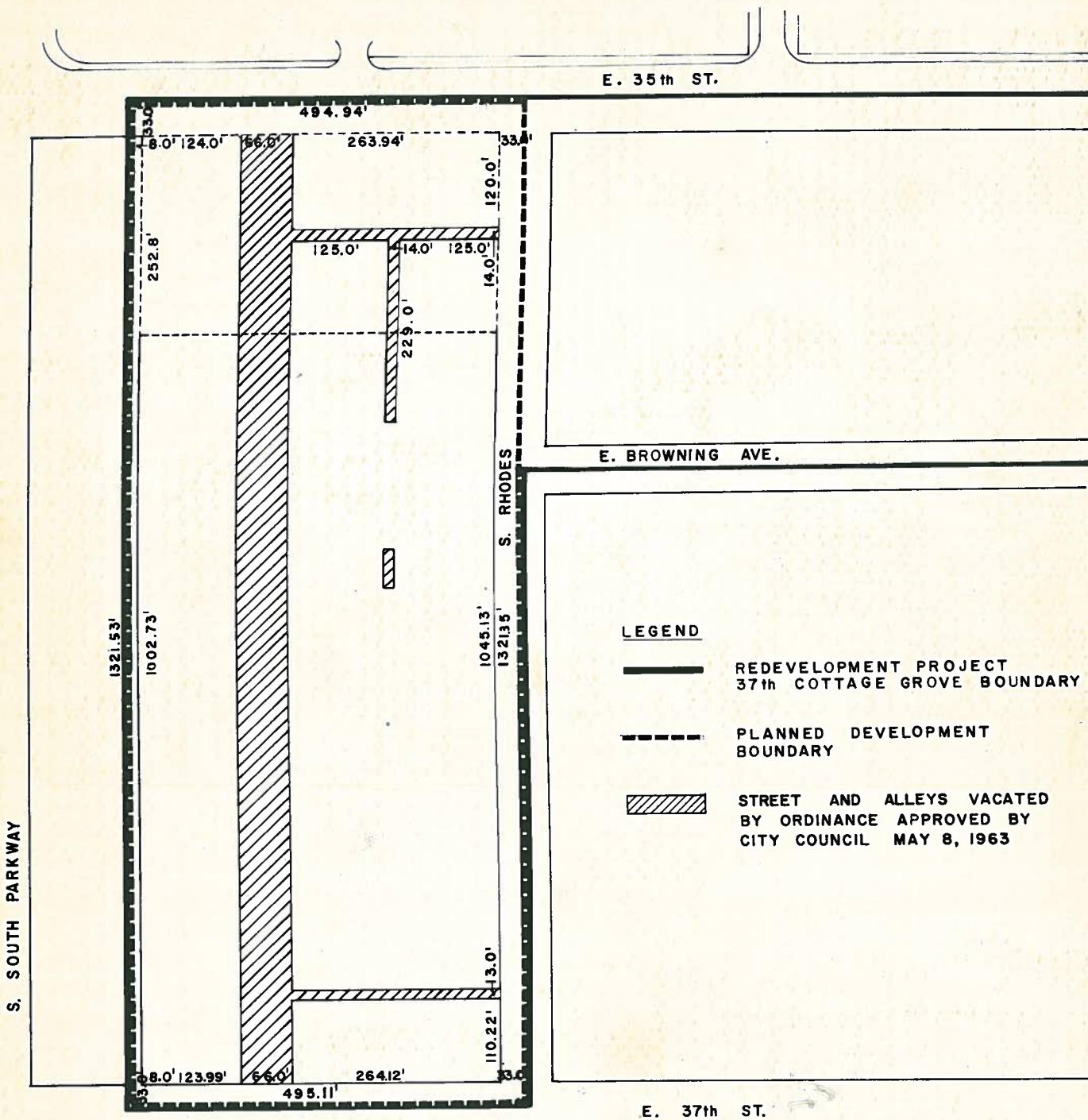

APPLICANT: DEPARTMENT OF URBAN RENEWAL OF  
THE CITY OF CHICAGO

DATE: MAY 16, 1966



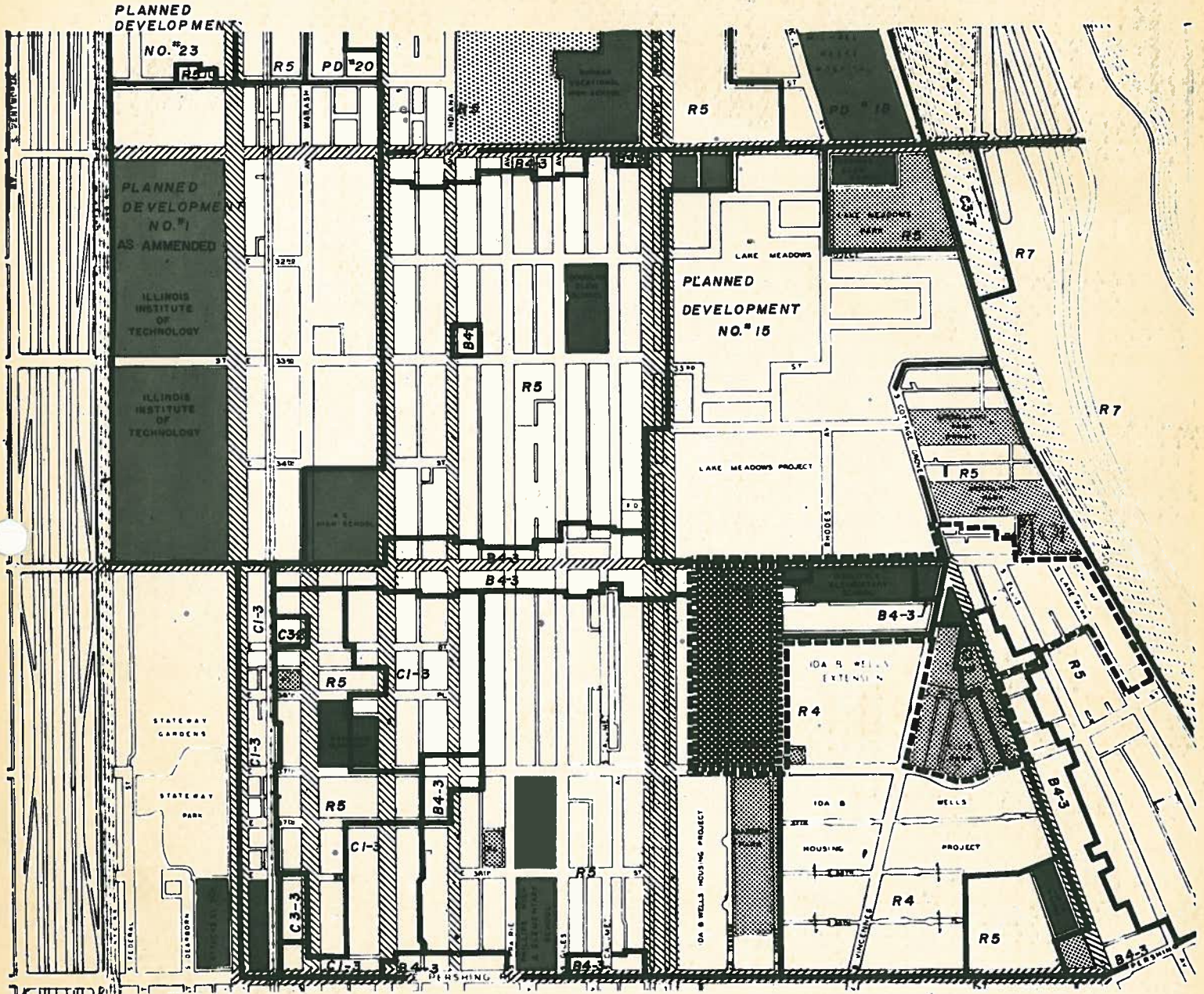

# RESIDENTIAL PLANNED DEVELOPMENT

## EXISTING ZONING AND PREFERENTIAL STREET SYSTEM



**LEGEND**

-  ZONING BOUNDARY
-  PARKS & PLAYGROUNDS
-  SCHOOLS PUBLIC AND QUASI PUBLIC BUILDINGS

-  PREFERENTIAL STREETS
-  PROPOSED RESIDENTIAL PLANNED DEVELOPMENT
-  BOUNDARY REDEVELOPMENT PROJECT
-  37th & COTTAGE GROVE

APPLICANT: THE DEPARTMENT OF URBAN RENEWAL OF  
THE CITY OF CHICAGO

DATE: MAY 16, 1966

SCALE 225 0 225 450



# RESIDENTIAL PLANNED DEVELOPMENT

## GENERALIZED LAND USE PLAN

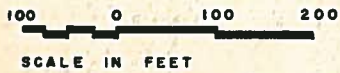
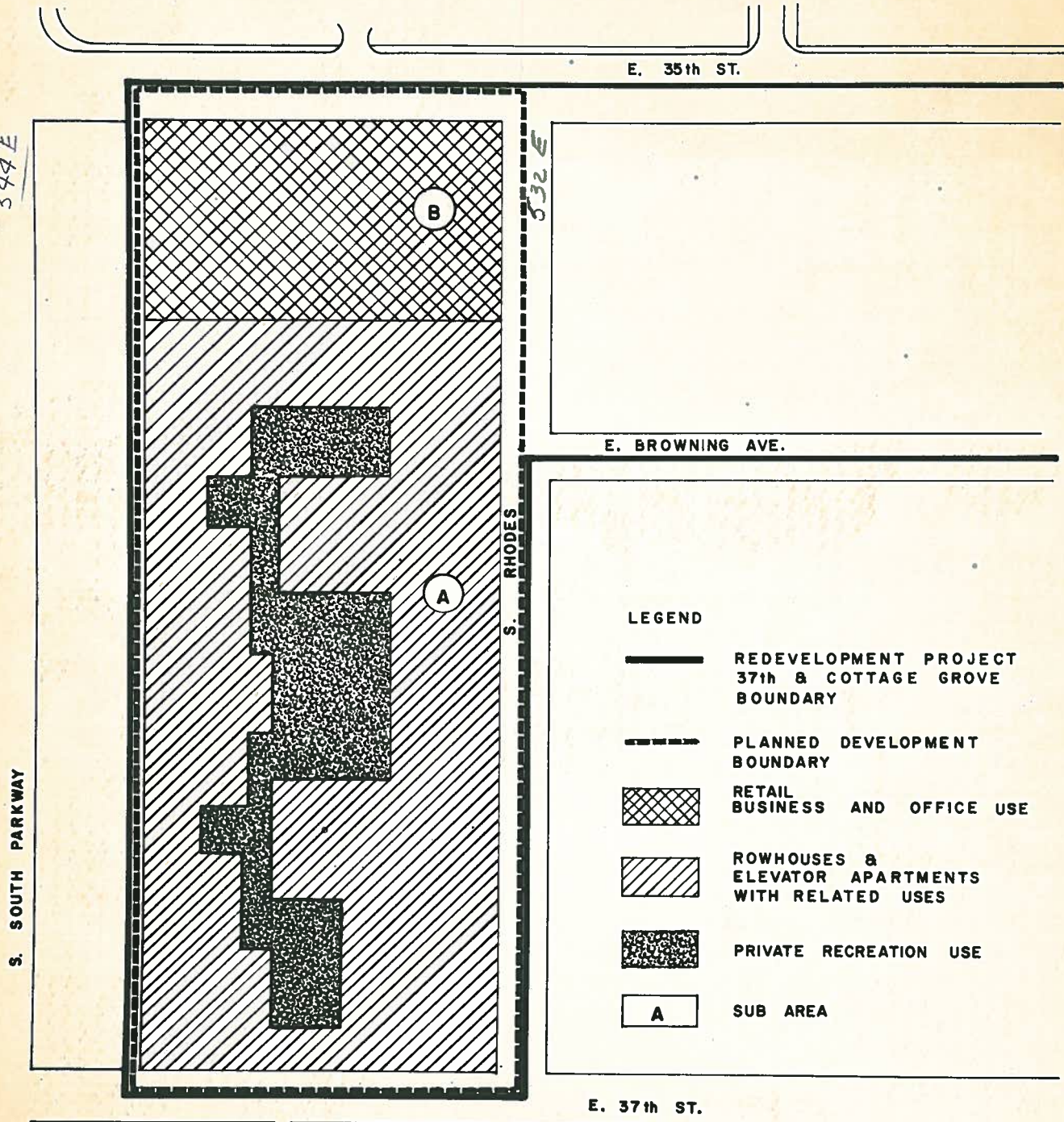

APPLICANT: DEPARTMENT OF URBAN RENEWAL OF THE CITY OF CHICAGO

DATE: MAY 16, 1966

RESIDENTIAL PLANNED DEVELOPMENT

Planned Development Use and Bulk Regulations and Data

SUB-AREA	NET SITE AREA		GENERAL DESCRIPTION OF LAND USE	NUMBER OF DWELLING UNITS	MAXIMUM F.A.R.	MAXIMUM % OF LAND COVERAGE
	SQUARE FEET	ACRES				
A	476,663.10	10.94	ROWHOUSES, ELEVATOR APTS. W/RELATED CONVENIENCE TYPE BUSINESS USES, AND PRIVATE RECREATION AREAS.	54 460	2.2	25
B	93,337.65	2.15	RETAIL BUSINESS AND OFFICE USE	—	1.2	15

NET SITE AREA = 570,000.75 square feet = 13.09 acres  
 GROSS SITE AREA = NET SITE AREA (13.09 acres) + AREA OF PUBLIC STREETS AND ALLEYS (1.92 acres) = 15.01 acres

MAXIMUM NUMBER OF DWELLING UNITS PER ACRE OF TOTAL NET RESIDENTIAL AREA: 50

MAXIMUM PERMITTED F.A.R. FOR TOTAL NET SITE AREA: 2.2

MINIMUM NUMBER OF PARKING SPACES REQUIRED: 441

MINIMUM OFF-STREET LOADING BERTHS: ELEVATOR APTS - Between 10,000,200,000 sq.ft one space, each additional 200,000 sq. ft. or fraction thereof-one space.  
 BUSINESS - Between 10,000-100,000 sq. ft. - one space. *Row scale as provided etc)*

MINIMUM PARKING REQUIREMENTS: ROWHOUSE 100%  
 ELEVATOR APARTMENTS 75%  
 BUSINESS AND OFFICE USE 1 space for each 500 s.f. of floor area in excess of 4000 s.f.

MINIMUM SETBACKS: FRONT YARDS SIDE YARDS  
 ELEVATOR APTS 25 ft. 20 ft.  
 ROWHOUSES 15 ft. 7.5 ft.

MINIMUM DISTANCES BETWEEN BUILDING FRONT AND REAR WALLS:  
 Elevator Apts: 80 ft. Rowhouse: 50 ft.

MAXIMUM PERCENTAGE OF LAND COVERAGE FOR TOTAL NET SITE AREA: 25%

APPLICANT: DEPARTMENT OF URBAN RENEWAL OF THE CITY OF CHICAGO, DATE: MAY 16, 1966