

CHICAGO, September 28, 1982.

To the President and Members of the City Council:

Your Committee on Buildings and Zoning begs leave to recommend that Your Honorable Body Pass the proposed ordinance transmitted herewith (referred to Your Committee on April 22, 1982) to amend the Chicago Zoning Ordinance for the purpose of reclassifying a particular area.

This recommendation was concurred in by 8 members of the committee, with no dissenting vote.

Respectfully submitted,
(Signed) EDWARD R. VRDOLYAK, Chairman.
(Signed) FRED B. ROTI, Vice-Chairman.

On motion of Alderman Roti the committee's recommendation was Concurred In and said proposed ordinance was Passed, by yeas and nays as follows:

Yeas--Aldermen Roti, Barnett, Kenner, Evans, Bloom, Sawyer, Bertrand, Humes, Shaw, Vrdolyak, Huels, Majerczyk, Madrzyk, Burke, Barden, Streeter, Kellam, Sheahan, Kelley, Sherman, Stemberk, Lipinski, Shumpert, Marzullo, Nardulli, Ray, Carothers, Hagopian, Martinez, Gabinski, Mell, Frost, Marcin, Farina, Damato, Cullerton, Laurino, Rittenberg, Pucinski, Natarus, Oberman, Merlo, Clewis, Axelrod, Schulter, Volini, Orr, Stone--48.

PP
290

Nays--None.

Alderman Natarus moved to Reconsider the foregoing vote. The motion was Lost.

The following is said ordinance as passed:

Be It Ordained by the City Council of the City of Chicago:

SECTION 1. That the Chicago Zoning Ordinance be amended by changing all the R4 General Residence and B5-2 General Service Districts symbols and indications as shown on Map No. 20-E in area bounded by

a line 1,798.97 feet north of and parallel to E. 87th Street; a line 823.86 feet east of and parallel to S. St. Lawrence Avenue; a line 1,173.49 feet north of and parallel to E. 87th Street; a line 494.97 feet east of and parallel to S. St. Lawrence Avenue; a line 1,333.49 feet north of and parallel to E. 87th Street; and a line 661.99 feet east of and parallel to S. St. Lawrence Avenue,

to those of a Residential Planned Development and a corresponding use district is hereby established in the area above described.

[Planned Development printed on pages 12656 through 12660 of this Journal]

SECTION 2. This ordinance shall be in force and effect from and after its passage and due publication.

Issuance of Permit Authorized for Erection of Illuminated Sign.

The Committee on Buildings and Zoning submitted the following report:

(Continued on page 12661)

CHICAGO, September 28, 1982.

To the President and Members of the City Council:

Your Committee on Buildings and Zoning begs leave to recommend that Your Honorable Body Pass the proposed ordinance transmitted herewith (referred to Your Committee on April 22, 1982) to amend the Chicago Zoning Ordinance for the purpose of reclassifying a particular area:

This recommendation was concurred in by 8 members of the committee, with no dissenting vote.

Respectfully submitted,
(Signed) EDWARD R. VRDOLYAK, Chairman.
(Signed) FRED B. ROTI, Vice-Chairman.

On motion of Alderman Roti the committee's recommendation was *Concurred In*, and said proposed ordinance was *Passed*, by yeas and nays as follows:

Yeas--Aldermen Roti, Barnett, Kenner, Evans, Bloom, Sawyer, Bertrand, Humes, Shaw, Vrdolyak, Huels, Majerczyk, Madrzyk, Burke, Barden, Streeker, Kellam, Sheahan, Kelley, Sherman, Stemberk, Lipinski, Shumper, Marzullo, Nardulli, Ray, Carothers, Hagopian, Martinez, Gabinski, Mell, Frost, Marcin, Farina, Damato, Cullerton, Laurino, Rittenberg, Pucinski, Natarus, Oberman, Merlo, Clewis, Axelrod, Schuller, Volini, Orr, Stone--48.

Nays--None.

Alderman Natarus moved to *Reconsider* the foregoing vote. The motion was *Lost*.

The following is said ordinance as passed:

Be It Ordained by the City Council of the City of Chicago:

SECTION 1. That the Chicago Zoning Ordinance be amended by changing all the R4 General Residential and B5-2 General Service Districts symbols and indications as shown on Map No. 20-E in area bounded by

a line 1,798.97 feet north of and parallel to E. 87th Street; a line 823.86 feet east of and parallel to S. St. Lawrence Avenue; a line 1,173.49 feet north of and parallel to E. 87th Street; a line 494.97 feet east of and parallel to S. St. Lawrence Avenue; a line 1,393.49 feet north of and parallel to E. 87th Street, and a line 661.99 feet east of and parallel to S. St. Lawrence Avenue;

to those of a Residential Planned Development and a corresponding use district is hereby established in the area above described.

[Planned Development printed on pages 12656 through 12660 of this Journal]

SECTION 2. This ordinance shall be in force and effect from and after its passage and due publication.

Issuance of Permit Authorized for Erection of Illuminated Sign.

The Committee on Buildings and Zoning submitted the following report:

(Continued on page 12661)

RESIDENTIAL PLANNED DEVELOPMENT;
GENERALIZED LAND USE MAP

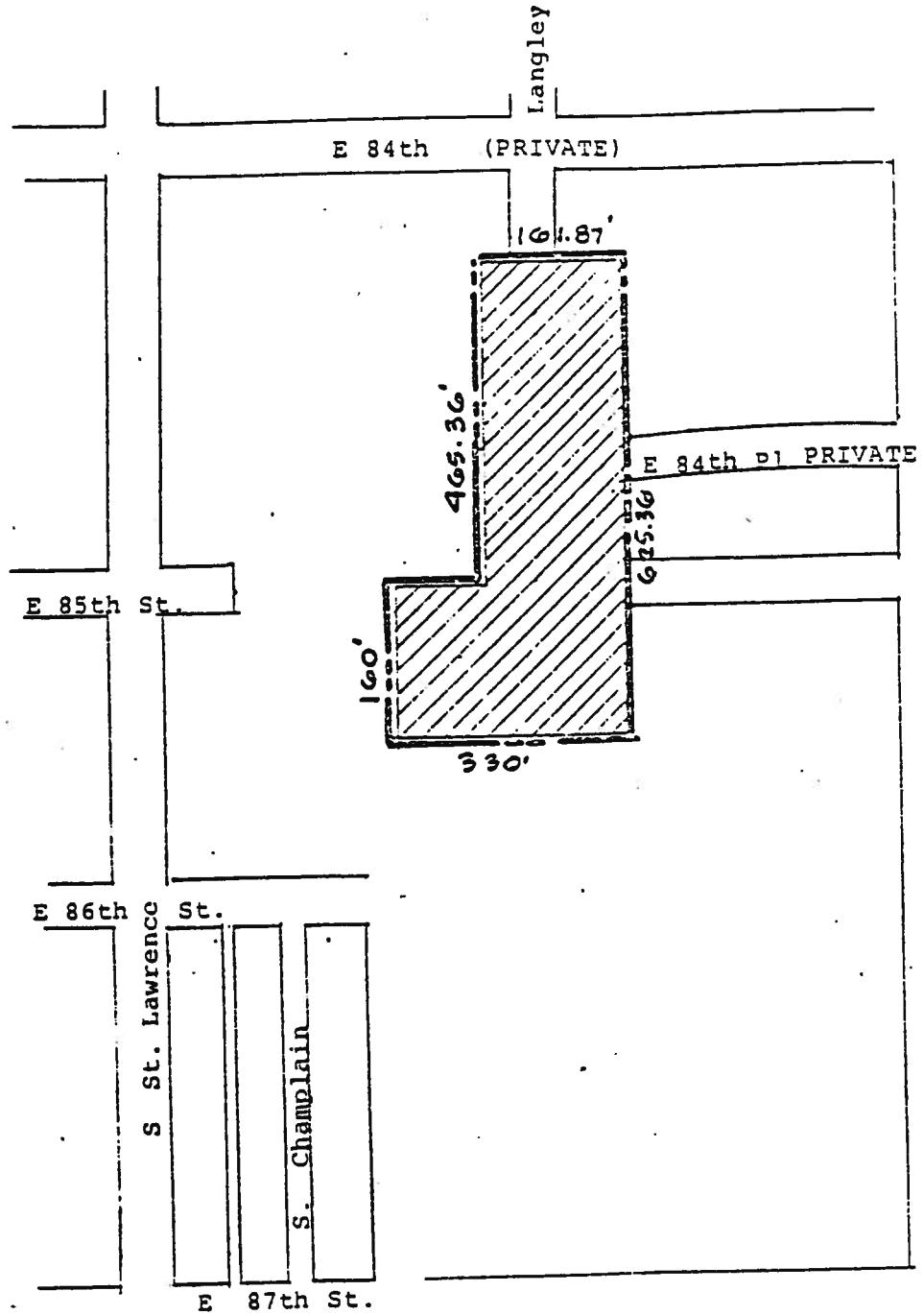

ELEVATOR APARTMENT STRUCTURE FOR ELDERLY,
INCLUDING COMMUNITY SPACE AND RECREATION
AREA FOR TENANT USE AND OFF-STREET PARKING



----- PLANNED DEVELOPMENT BOUNDARY

APPLICANT CHATHAM PARK SOUTH COOPERATIVE

DATE MARCH 19, 1982

RESIDENTIAL PLANNED DEVELOPMENT
 PLAN OF DEVELOPMENT
 STATEMENTS

No. 290

1. The area delineated hereon as a "Residential Planned Development" is controlled by the applicant, Chatham Park South Cooperative, an Illinois not-for-profit corporation ("Applicant").
2. Use of land will consist of an elevator apartment structure for the elderly including community space and recreation area for tenant usage and off-street parking as authorized by this Plan of Development.
3. All applicable official reviews, approvals or permits are required to be obtained by Applicant or its successors, assigns or grantees.
4. Any dedication or vacation of streets or alleys or adjustments of the rights of way or consolidation or resubdivision of parcels shall require a separate submittal on behalf of Applicant, its successors or assigns.
5. Off-street parking and loading facilities will be provided in compliance with this Plan of Development and as authorized by this Plan of Development.
6. Service drives or any other ingress or egress shall be adequately designed and paved in accord with the regulations of the Department of Streets and Sanitation and in compliance with the Municipal Code of Chicago to provide ingress and egress for motor vehicles, including emergency vehicles. There shall be no parking permitted within such paved areas.
7. Identification signs may be permitted with the approval of the Commissioner of Planning and the Commissioner of Inspectional Services.
8. The following information sets forth data concerning the property included in said development and data concerning a generalized land use plan (Site Plan) illustrating the development of said property in accordance with the intent and purpose of the Chicago Zoning Ordinance. Said development will be in strict accord with the Plan of Development.
9. The Plan of Development hereby attached shall be subject to the "Rules, Regulations and Procedures in Relation to Planned Developments", as adopted by the Commissioner of Planning.



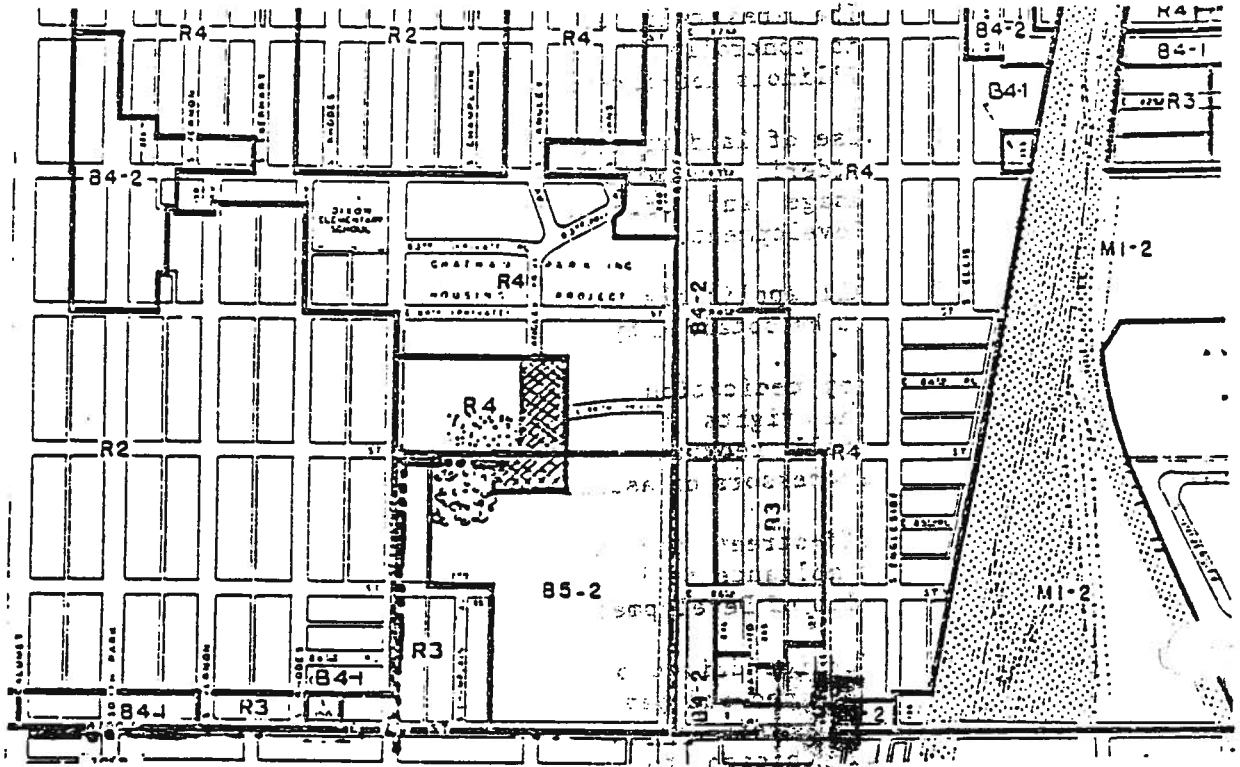

APPLICANT: Chatham Park South Cooperative

DATE: March 19, 1982

RESIDENTIAL PLANNED DEVELOPMENT:
EXISTING ZONING AND PREFERENTIAL STREET MAP



LEGEND

-  RESIDENTIAL PLANNED DEVELOPMENT
-  ZONING DISTRICT BOUNDRIES
-  PREFERENTIAL STREET PATTERN
-  PARKS AND PLAYGROUNDS
-  PUBLIC AND QUASI-PUBLIC FACILITIES



APPLICANT : CHATHAM PARK SOUTH COOPERATIVE
 DATE: MARCH 19, 1982