

9. This Plan of Development is applicable to the area delineated herein. These and no other controls shall apply to the area delineated herein except as provided for in Chapter 194A, Section 11.11-3(c).
10. The Plan of Development hereby attached shall be subject to the "Rules, Regulations and Procedures in Relation to Planned Developments" as adopted by the Department of Planning.

[Bulk Regulations and Maps attached to this Plan of Development
are printed on pages 3769 through 3772
of this Journal.]

Reclassification Of Area Shown On Map No. 15-O.

Be It Ordained by the City Council of the City of Chicago:

SECTION 1. That the Chicago Zoning Ordinance be amended by changing all the Residential Planned Development No. 162 symbols and indications as shown on Map No. 15-O in the area bounded by

West Everell Avenue; a line from a point 576.98 feet west of North Harlem Avenue along the south line of West Everell Avenue; to a point 205.655 feet west of North Oconto Avenue along the center line of West Peterson Avenue; the center line of West Peterson Avenue or the line thereof if extended where no street exists; and a line from a point 932.155 feet west of North Oconto Avenue along the center line of West Peterson Avenue, to a point 1,303.48 feet west of North Harlem Avenue along the south line of West Everell Avenue,

to the designation of a Residential Planned Development No. 162 as amended, which is hereby established in the area above described, subject to such use and bulk regulations as are set forth in the Plan of Development herewith attached and made a part thereof and to no others.

SECTION 2. This ordinance shall be in force and effect from and after its passage and due publication.

Residential Planned Development No. 162 attached to this ordinance reads as follows:

Residential Planned Development Statements.

1. The area delineated hereon as "Residential Planned Development for Housing for Elderly Persons" is owned or controlled by the Sisters of the Resurrection.

(Continued on page 3773)

(Continued from page 3768)

2. Off-street parking facilities, shall be provided in compliance with this Plan of Development, subject to the review of the Department of Streets and Sanitation and the approval of the Department of Planning.
3. Off-street loading facilities shall be provided in compliance with this Plan of Development, subject to the review of the Department of Streets and Sanitation and the approval of the Department of Planning.
4. All applicable official reviews, approvals or permits are required to be obtained by the Sisters of the Resurrection.
5. Any dedication or vacation of streets and alleys or easements, or adjustments of right-of-way or consolidation or resubdivision of parcels shall require a separate submittal on behalf of the Sisters of the Resurrection and approved by the City Council.
6. Access to the Planned Development shall be from an existing service road running north from W. Talcott Avenue (opposite N. Oketo Avenue, if extended) on the west, and from W. Peterson Avenue on the south. Any service drives or any other ingress or egress shall be adequately designed and paved in accord with the regulations of the Department of Streets and Sanitation and in compliance with the Municipal Code of Chicago, to provide ingress and egress for motor vehicles, including emergency vehicles; there shall be no parking within such paved areas. Fire lanes shall be adequately designed and paved in compliance with the Municipal Code of Chicago and shall have a minimum width of 20 feet to provide ingress and egress for emergency vehicles. There shall be no parking within such paved areas.
7. The following uses shall be permitted within the area delineated hereon as "Residential Planned Development for Housing for Elderly Persons": four elevator apartment buildings for elderly housing, off-street parking, and related recreational areas and facilities.
8. Identification signs may be permitted within the area delineated hereon as Residential Planned Development for Housing for Elderly Persons, subject to the review and approval of the Commissioner of the Department of Planning.
9. The following information sets forth data concerning the property included in said Residential Planned Development for Housing for Elderly Persons and data concerning a generalized land use plan (site plan) illustrating the development of said property in accordance with the intent and purpose of the Chicago Zoning Ordinance.
10. The Plan of Development hereby attached shall be subject to the "Rules, Regulations and Procedures in Relation to the Planned Developments", as adopted by the Commissioner of the Department of Planning.

[Bulk Regulations and Maps attached to this Plan of Development
are printed on pages 3775 through 3778)
of this Journal.]

Reclassification Of Area Shown On Map No. 16-H.

Be It Ordained by the City Council of the City of Chicago:

SECTION 1. That the Chicago Zoning Ordinance be amended by changing all the B2-1 Restricted Retail District symbols and indications as shown on Map No. 16-H in the area bounded by

a line 124.51 feet north of West 71st Street; South Damen Avenue; West 71st Street;
and a line 99 feet west of South Damen Avenue,

to those of a B4-1 Restricted Service District, and a corresponding use district is hereby established in the area above described.

SECTION 2. This ordinance shall be in force and effect from and after its passage and due publication.

Reclassification Of Area Shown On Map No. 20-D.

Be It Ordained by the City Council of the City of Chicago:

SECTION 1. That the Chicago Zoning Ordinance be amended by changing all the B4-2 Restricted Service District symbols and indications as shown on Map No. 20-D in the area bounded by

a line 150 feet north of and parallel to East 85th Street; the alley next east of and
parallel to South Cottage Grove Avenue; East 85th Street; and South Cottage Grove
Avenue,

to those of a C1-1 Restricted Commercial District, and a corresponding use district is hereby established in the area above described.

SECTION 2. This ordinance shall be in force and effect from and after its passage and due publication.

Reclassification Of Area Shown On Map No. 20-F.

(Continued on page 3779)

9/9/87

UNFINISHED BUSINESS

3775

RESIDENTIAL PLANNED DEVELOPMENT
PLANNED DEVELOPMENT USE & BULK REGULATIONS & DATA

<u>NET SITE AREA</u>		<u>GENERAL DESCRIPTION OF LAND USE</u>	<u>NO. OF DWELLING UNITS</u>	<u>MAX. FLOOR AREA RATIO</u>	<u>MAX. % OF LAND COVERED</u>
<u>Sq. Ft.</u>	<u>Acres</u>				
696,960	16	Four elevator apartment buildings for elderly housing, off-street parking and related recreational areas and facilities.	477	0.65	16%

Net Site Area + Area of Public Streets and Alleys = Gross Site Area
 696,960 sq. ft. 23,974.5 sq. ft. 720,934.5 sq. ft.

- MAXIMUM PERMITTED F.A.R. FOR TOTAL NET SITE AREA: 0.65
- MAXIMUM NUMBER OF DWELLING UNITS IN ELEVATOR APARTMENT STRUCTURES: 477
- MINIMUM NUMBER OF OFF-STREET PARKING SPACES FOR ALL FACILITIES: 264 TOTAL
- MINIMUM NUMBER OF OFF-STREET LOADING SPACES FOR ALL FACILITIES: 5
- MINIMUM BOUNDARY SETBACKS: 90' from north, east and south boundaries
35' from west boundary
- MAXIMUM PERCENT OF LAND COVERED: 16%



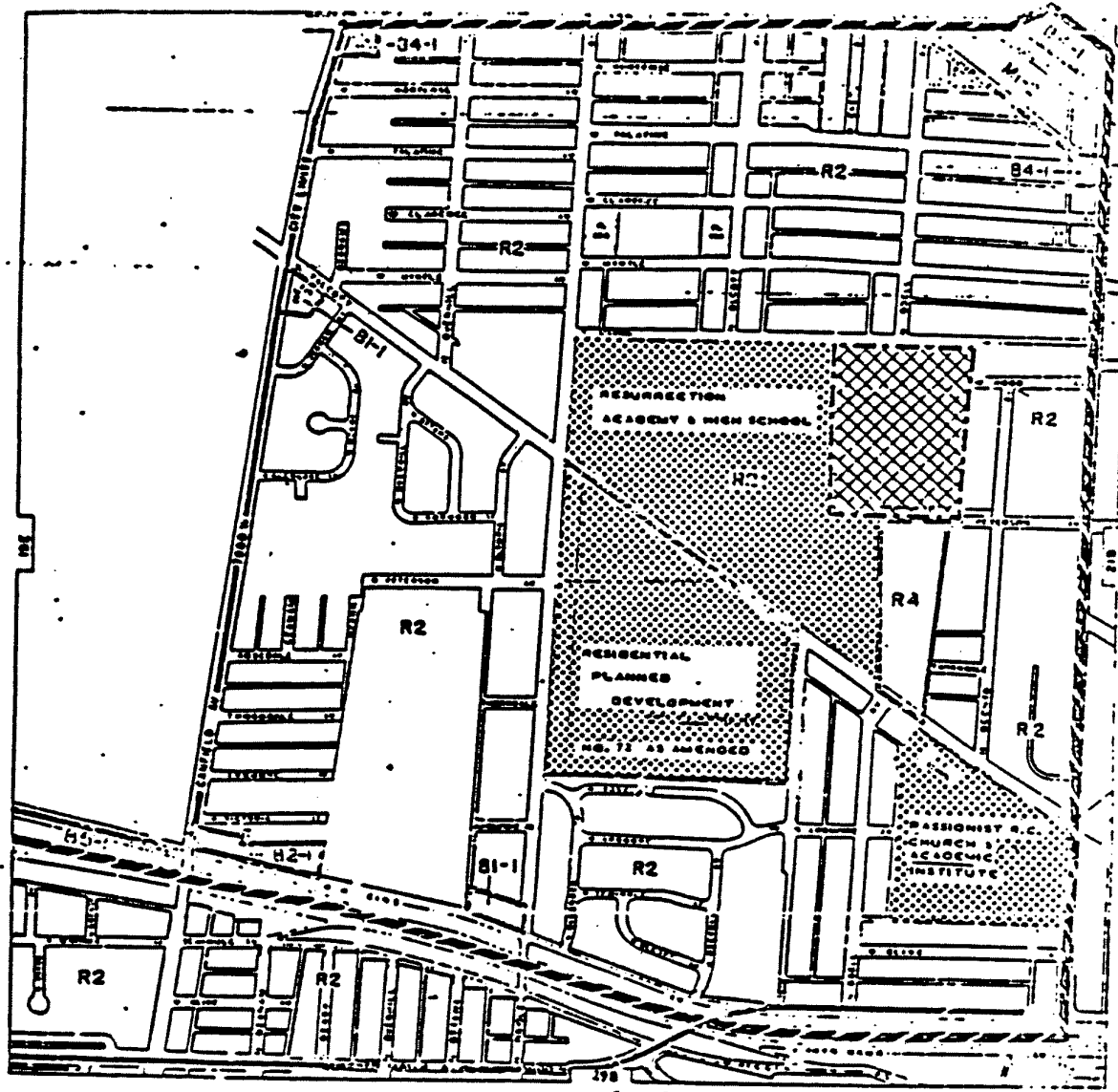

SETBACK AND YARD REQUIREMENTS MAY BE ADJUSTED WHERE REQUIRED TO PERMIT CONFORMANCE TO THE PATTERN OF, OR ARCHITECTURAL ARRANGEMENT RELATED TO, EXISTING STRUCTURES, OR WHERE NECESSARY BECAUSE OF TECHNICAL REASONS, SUBJECT TO THE APPROVAL OF THE DEPARTMENT OF PLANNING.

APPLICANT: Sisters of the Resurrections
 DATE: September 15, 1976
 Amended December 9, 1976
 Amended April 15, 1987

RESIDENTIAL PLANNED DEVELOPMENT
EXISTING ZONING AND PREFERENTIAL STREET SYSTEM



LEGEND

-  RESIDENTIAL PLANNED DEVELOPMENT
-  ZONING DISTRICT BOUNDARY
-  PUBLIC AND QUASI - PUBLIC FACILITIES
-  PREFERENTIAL STREETS

APPLICANT: SISTERS OF THE RESURRECTION
 DATE: SEPTEMBER 13, 1976
 AMENDED DECEMBER 9, 1976
 Amended April 15, 1987

9/9/87

UNFINISHED BUSINESS

3777

RESIDENTIAL PLANNED DEVELOPMENT
PROPERTY LINE MAP & RIGHT OF WAY ADJUSTMENTS

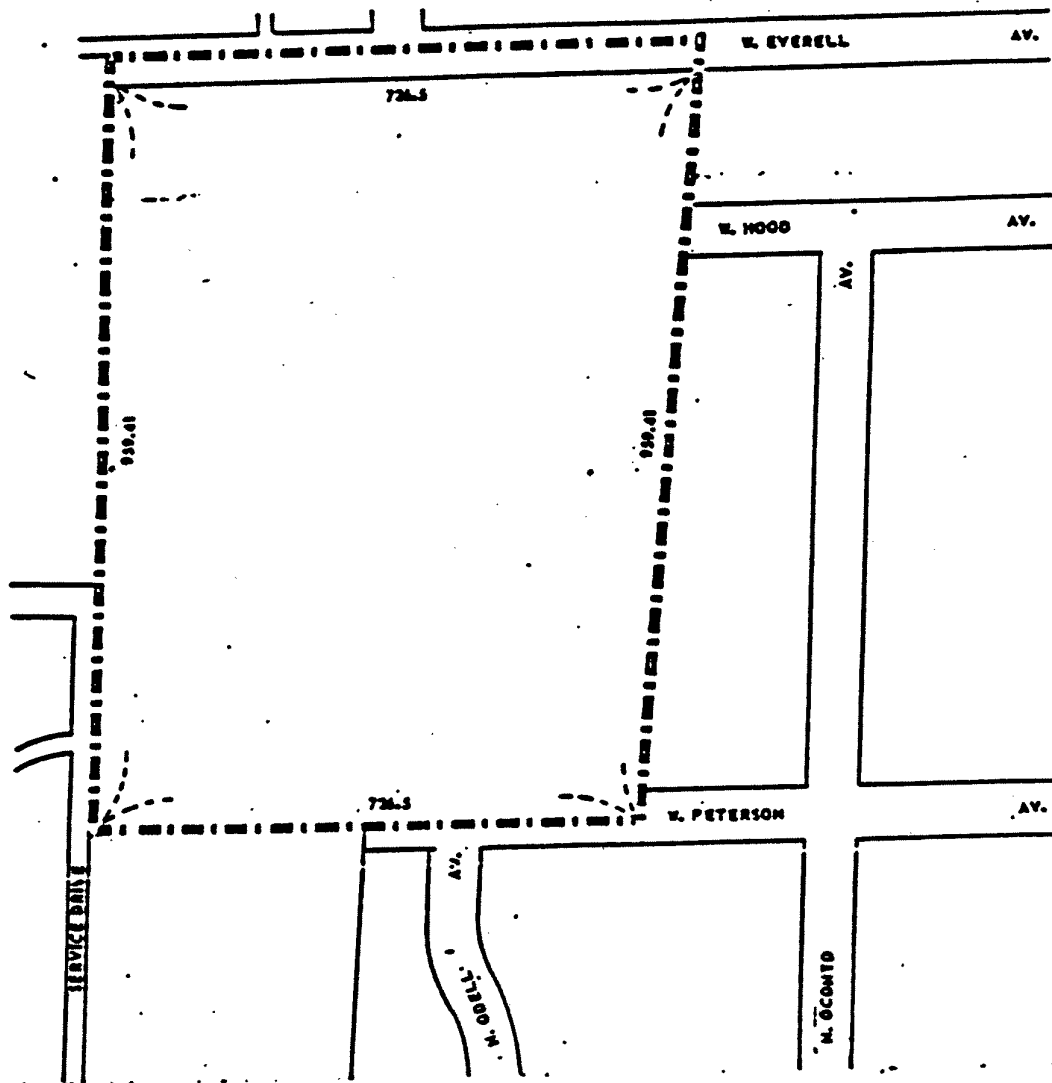

PLANNED DEVELOPMENT BOUNDARY

APPLICANT: SISTERS OF THE RESURRECTION
DATE: SEPTEMBER 13, 1976
AMENDED DECEMBER 9, 1976
Amended April 15, 1987

RESIDENTIAL PLANNED DEVELOPMENT
GENERALIZED LAND USE MAP

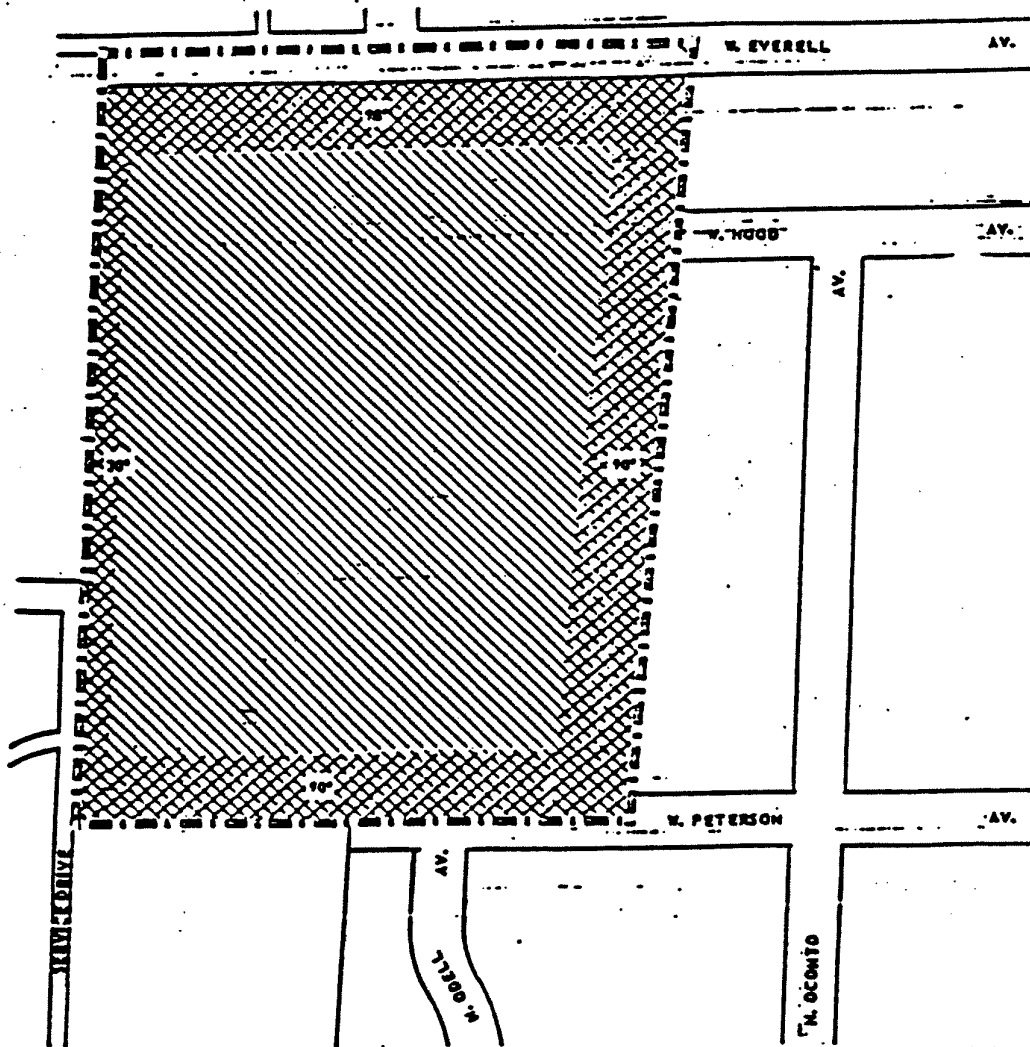

--- PLANNED DEVELOPMENT BOUNDARY.

////// FOUR ELEVATOR APARTMENT BUILDINGS
FOR ELDERLY HOUSING, 100 BED INTERMEDIATE NURSING
CARE FACILITY, AND RELATED RECREATIONAL AREAS AND FACILITIES.

XXXXX FREE OF BUILDINGS



SCALE: 1 INCH = 100 FT.

APPLICANT: SISTERS OF THE RESURRECTION
DATE: SEPTEMBER 15, 1976
AMENDED DECEMBER 9, 1976
Amended April 15, 1987

Reclassification of Area Shown on Map No. 12-F.

Be It Ordained by the City Council of the City of Chicago:

SECTION 1. That the Chicago Zoning Ordinance be amended by changing all the R3 General Residence District symbols and indications as shown on Map No. 12-F in the area bounded by

the alley next north of and parallel to W. Garfield Boulevard; a line 295 feet east of and parallel to S. Halsted Street and W. Garfield Boulevard and a line 195 feet east of and parallel to S. Halsted Street

to those of a B4-2 Restricted Service District, and a corresponding use district is hereby established in the area above described.

SECTION 2. This ordinance shall be in force and effect from and after its passage and due publication.

Reclassification of Area Shown on Map No. 15-I.

Be It Ordained by the City Council of the City of Chicago:

SECTION 1. That the Chicago Zoning Ordinance be amended by changing all the B4-2 Restricted Service District symbols and indications as shown on Map No. 15-I in the area bounded by

W. Rosemont Avenue; N. California Avenue; W. Granville Avenue and the alley next west of and parallel to N. California Avenue

to those of a B1-2 Local Retail District, and a corresponding use district is hereby established in the area above described.

SECTION 2. This ordinance shall be in force and effect from and after its passage and due publication.

Reclassification of Area Shown on Map No. 15-L.

Be It Ordained by the City Council of the City of Chicago:

SECTION 1. That the Chicago Zoning Ordinance be amended by changing all the B4-2 Restricted Service District symbols and indications as shown on Map No. 15-L in the area bounded by

a line 200 feet northwest and parallel to N. Luna Avenue; N. Elston Avenue on the northeast; a line 150 feet north of and parallel to N. Luna Avenue and the alley next south of and parallel to N. Elston Avenue

to those of a C1-1 Restricted Service District and a corresponding use district is hereby established in the area above described.

SECTION 2. This ordinance shall be in force and effect from and after its passage and due publication.

Reclassification of Area Shown on Map No. 15-O.

Be It Ordained by the City Council of the City of Chicago:

SECTION 1. That the Chicago Zoning Ordinance be amended by changing all the R2 Single Family Residence District symbols and indications as shown on Map No. 15-O in the area bounded by

W. Everell Avenue; a line from a point 576.9 feet west of N. Harlem Avenue along the south line of W. Everell Avenue, to a point 205.655 feet west of N. Oconto Avenue along the center line of W. Peterson Avenue; the center line of W. Peterson Avenue, or the line thereof if extended where no street exists and a line from a point 932.155 feet west of N. Oconto Avenue along the center line of W. Peterson Avenue, to a point 1303.48 feet west of N. Harlem Avenue along the south line of W. Everell Avenue

to the designation of a Residential Planned Development for Housing for Elderly Persons, as defined under Article 3 of the Chicago Zoning Ordinance; hereby established in the area herein described, subject to such use and bulk regulations as are set forth in the Plan of Development herewith attached and made a part thereof and to no others.

[Plan of Development printed on pages 4927 to 4931 of this Journal]

SECTION 2. This ordinance shall be in force and effect from and after its passage and due publication.

Failed to Pass—PROPOSED ORDINANCE FOR AMENDMENT OF CHICAGO ZONING ORDINANCE TO RECLASSIFY AREA SHOWN ON MAP NO. 9-J (Adverse Committee Recommendation).

On motion of Alderman Roti the City Council took up for consideration the report of the Committee on Buildings and Zoning deferred and published in the Journal of Proceedings of January 13, 1977, page 4837 recommending that the City Council *Do Not Pass* a proposed ordinance, for amendment of the Chicago Zoning Ordinance to reclassify a particular area.

Alderman Roti moved to *Concur In* the committee's recommendation. The question thereupon became: "*Shall the proposed ordinance Pass, notwithstanding the Committee's adverse recommendation?*" and the question being put, said proposed ordinance *Failed to Pass*, by yeas and nays as follows:

Yeas—None.

Nays—Aldermen Roti, Barnett, Kenner, Evans, Lathrop, Sawyer, Wilinski, Adduci, Vrdolyak, Kwak, Madrzyk, Burke, Jaksy, Barden, Shannon, Joyce, Kelley, Stewart, Stemberk, Lipinski, Rhodes, Marzullo, Zydlo, Ray, Washington, Hagopian, Gabinski, Mell, Frost, Laskowski, Aiello, Casey, Cullerton, Gutstein, Pucinski, Natarus, Oberman, Simpson, Block, Stone—40.

Said proposed ordinance which *Failed to Pass*, proposed to amend the Chicago Zoning Ordinance to reclassify a particular area, and is summarized as follows:

To classify as Business Planned Development instead of an M1-1 Restricted Manufacturing District, the area bounded by

the entire area bounded by N. Kimball Avenue on the West; W. Belmont Avenue on the south and the John F. Kennedy Expressway on the north and east (Map No. 9-J).

170
162

RESIDENTIAL PLANNED DEVELOPMENT #162

STATEMENTS

1. The area delineated hereon as "Residential Planned Development for Housing for Elderly Persons" is owned or controlled by the Sisters of the Resurrection.
2. Off-street parking facilities, shall be provided in compliance with this Plan of Development, subject to the review of the Department of Streets and Sanitation and the approval of the Department of Development and Planning.
3. Off-street loading facilities shall be provided in compliance with this Plan of Development, subject to the review of the Department of Streets and Sanitation and the approval of the Department of Development and Planning.
4. All applicable official reviews, approvals or permits are required to be obtained by the Sisters of the Resurrection.
5. Any dedication or vacation of streets and alleys or easements, or adjustments of right-of-way or consolidation or resub-division of parcels shall require a separate submittal on behalf of the Sisters of the Resurrection and approved by the City Council.
6. Access to the Planned Development shall be from an existing service road running north from W. Talcott Avenue (opposite N. Oketo Avenue, if extended) on the west, and from W. Peterson Avenue on the south. Any service drives or any other ingress or egress shall be adequately designed and paved in accord with the regulations of the Department of Streets and Sanitation and in compliance with the Municipal Code of Chicago, to provide ingress and egress for motor vehicles, including emergency vehicles; there shall be no parking within such paved areas. Fire lanes shall be adequately designed and paved in compliance with the Municipal Code of Chicago and shall have a minimum width of 20 feet to provide ingress and egress for emergency vehicles. There shall be no parking within such paved areas.
7. The following uses shall be permitted within the area delineated hereon as "Residential Planned Development for Housing for Elderly Persons": four elevator apartment buildings for elderly housing, a 100 bed intermediate nursing care facility, off-street parking, and related recreational areas and facilities.
8. Identification signs may be permitted within the area delineated hereon as Residential Planned Development for Housing for Elderly Persons, subject to the review and approval of the Commissioner of the Department of Development and Planning.
9. The following information sets forth data concerning the property included in said Residential Planned Development for Housing for Elderly Persons and data concerning a generalized land use plan (site plan) illustrating the development of said property in accordance with the intent and purpose of the Chicago Zoning Ordinance.
10. The Plan of Development hereby attached shall be subject to the "Rules, Regulations and Procedures in Relation to Planned Development", as adopted by the Commissioner of the Department of Development and Planning.

RESIDENTIAL PLANNED DEVELOPMENT
PROPERTY LINE MAP & RIGHT OF WAY ADJUSTMENTS

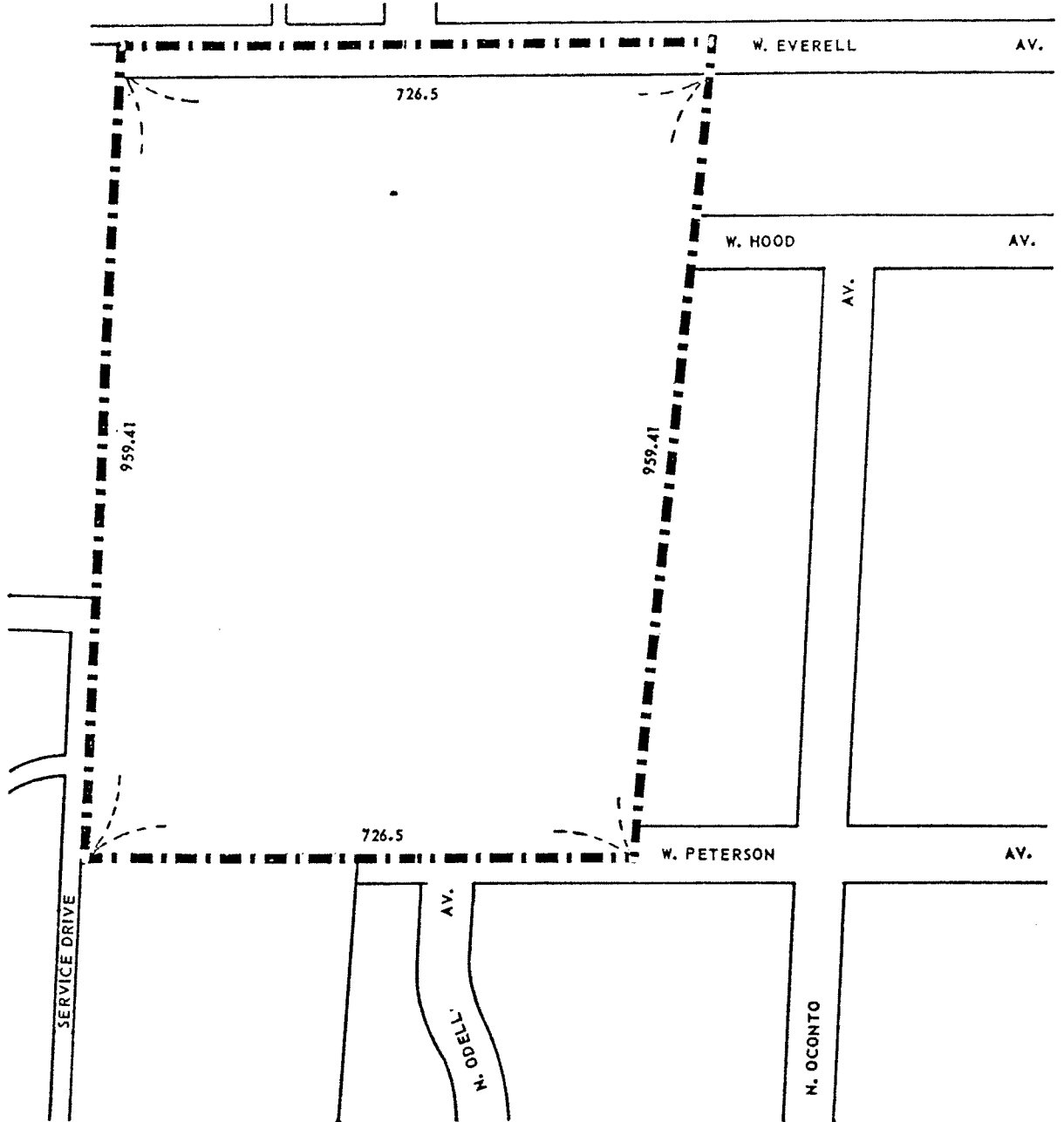



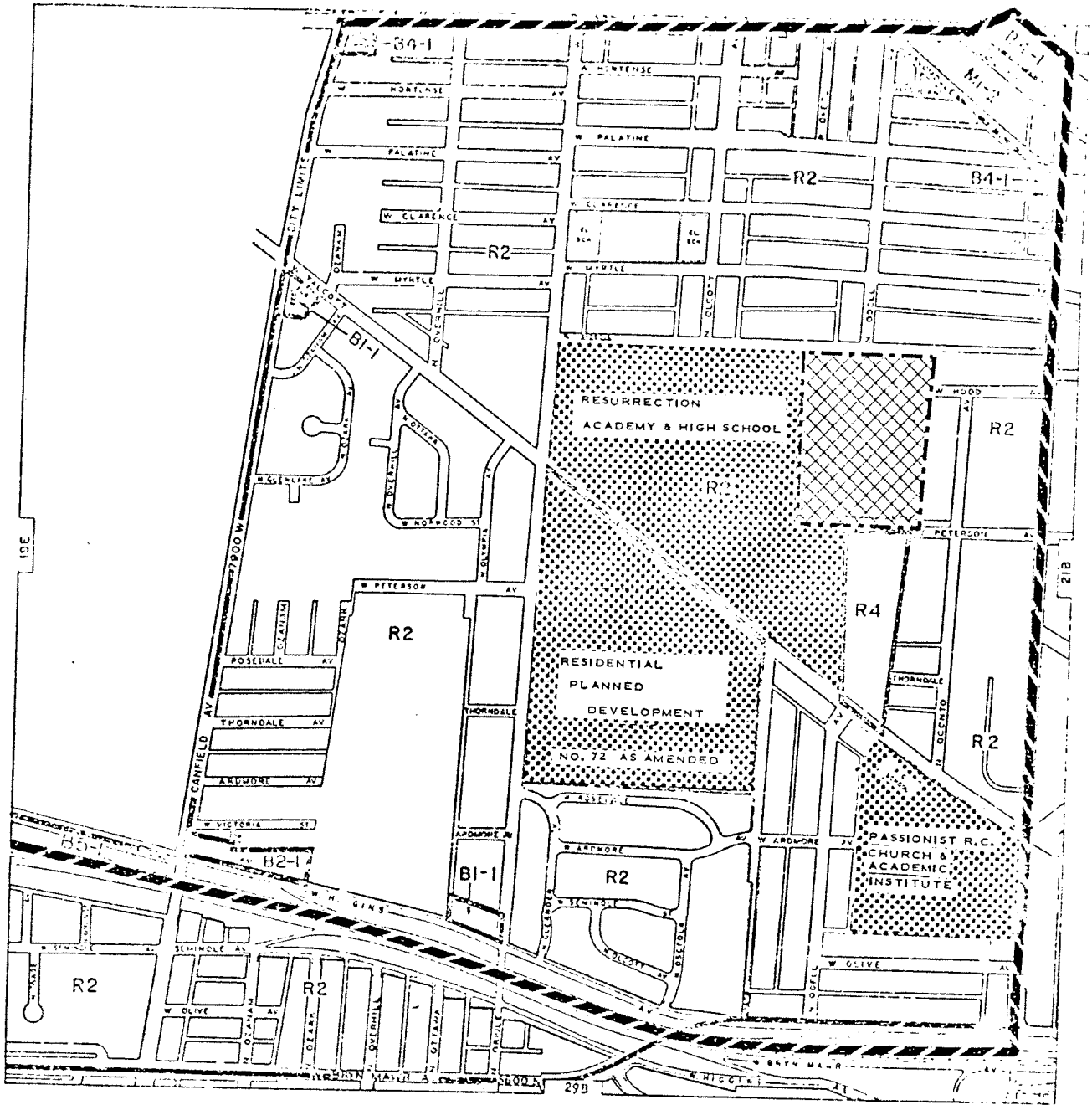

--- PLANNED DEVELOPMENT BOUNDARY

APPLICANT: SISTERS OF THE RESURRECTION
DATE: SEPTEMBER 15, 1976
AMENDED DECEMBER 9, 1976

RESIDENTIAL PLANNED DEVELOPMENT
EXISTING ZONING AND PREFERENTIAL STREET SYSTEM



LEGEND



-  RESIDENTIAL PLANNED DEVELOPMENT
-  ZONING DISTRICT BOUNDARY
-  PUBLIC AND QUASI - PUBLIC FACILITIES
-  PREFERENTIAL STREETS

APPLICANT: SISTERS OF THE RESURRECTION

DATE: SEPTEMBER 15, 1976
AMENDED DECEMBER 9, 1976

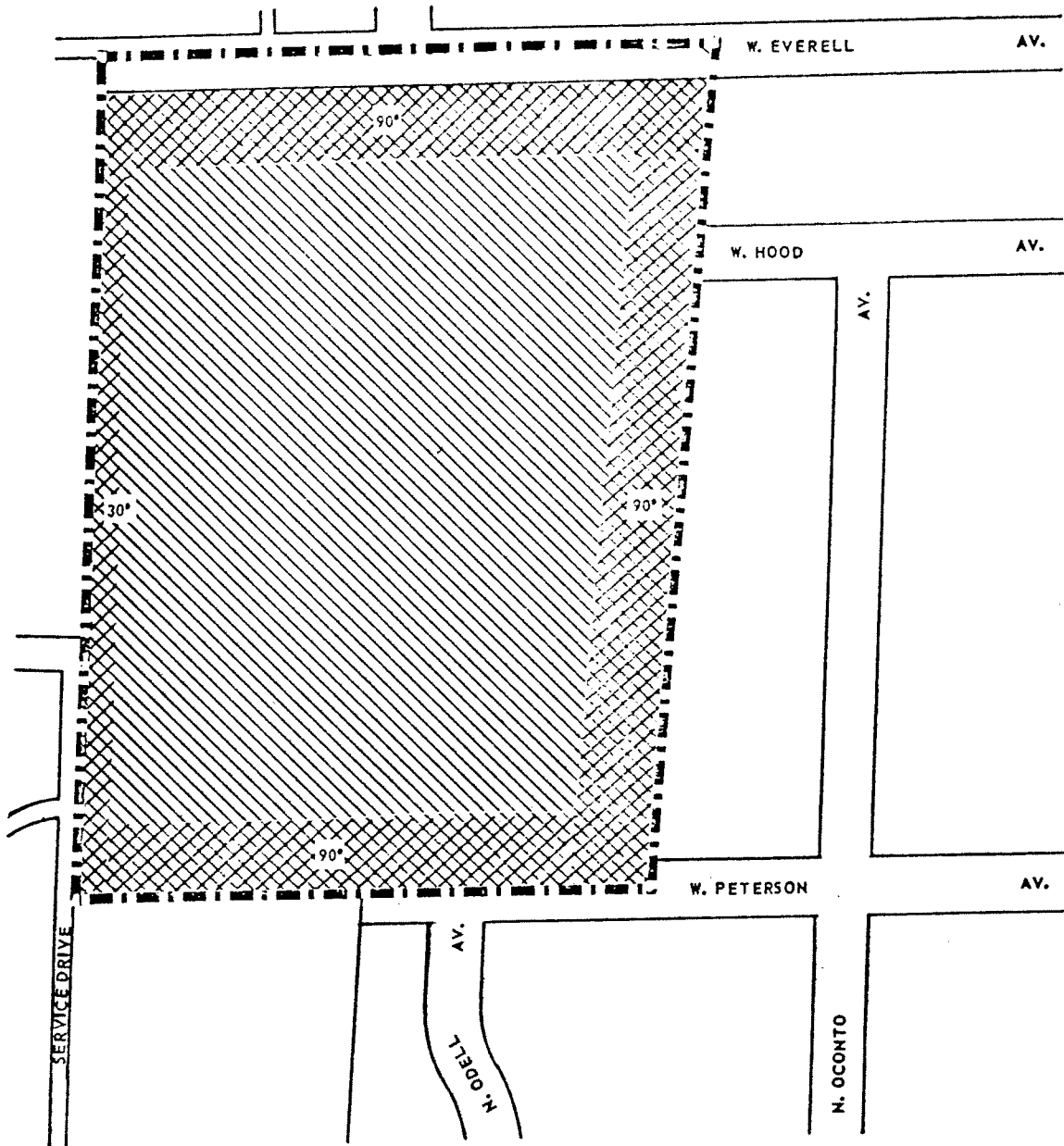
RESIDENTIAL PLANNED DEVELOPMENT
GENERALIZED LAND USE MAP



-  PLANNED DEVELOPMENT BOUNDARY.
-  FOUR ELEVATOR APARTMENT BUILDINGS FOR ELDERLY HOUSING, 100 BED INTERMEDIATE NURSING CARE FACILITY, AND RELATED RECREATIONAL AREAS AND FACILITIES.
-  FREE OF BUILDINGS



SCALE: 1 INCH. = 200 FT.

APPLICANT: SISTERS OF THE RESURRECTION
 DATE: SEPTEMBER 15, 1976
 AMENDED DECEMBER 9, 1976

