

11. ~~The Plan of Development hereby attached shall be subject to the "Rules, Regulations and Procedures in Relation to Planned Development Amendments" as promulgated by the Commissioner of the Department of Planning and in effect on the date hereof.~~

Pages 19347 and 19348 -- by deleting the Institutional Planned Development No. 137, as amended, Planned Development Use and Bulk Regulation and Data appearing on pages 19347 and 19348 and inserting in lieu thereof the following:

"Institutional Planned Development No. 137, As Amended.

Planned Development

Use And Bulk Regulations And Data.

(Site)	Net Site Area Sq. Ft. (Acres)	General Description Of Land Use	Max. Floor Area Ratio	Max % Of Land Covered
A	83,704.2 1.92	305-Bed Nursing Home Off-street parking facilities Off-street loading facilities	1.5	35%
B	82,377.6 1.89	225-Bed Nursing Home Off-street parking facilities Off-street loading facilities	1.5	40%
TOTAL: 166,081.8 3.81				

Note: The Net Site Area for Site A and Site B include the vacated South Yale Avenue and the vacated South Princeton Avenue, respectively.

(Site) Gross Site Area = Net Site Area + Area Of Public Streets And Alleys.

A	106,915.7	83,704.2	+	23,211.5
B	99,856.2	82,377.6	+	17,478.6

Maximum permitted F.A.R. for Total Net Site Area: 1.5

Estimated population:

Site A	305 beds 1 doctor in residence 30 maximum no. of employees in any one shift
Site B	225 beds 1 doctor in residence 30 maximum no. employees in any one shift

Minimum number of off-street parking spaces:

Site A	63 Regular <u>2</u> Handicapped 65	Site B	50 Regular <u>3</u> Handicapped 53
--------	--	--------	--

Maximum number of off-street loading spaces: Site A = 1 Site 3 = 1

Minimum setbacks:	Site A	Site B
Boundary and front yard:	25 feet	25 feet
Boundary and side yard:	8 feet	8 feet
Boundary and rear yard:	35 feet	15 feet

Maximum percent of land covered for Total Net Site Area: 37.5

Reclassification Of Area Shown On Map No. 16-F.

Be It Ordained by the City Council of the City of Chicago:

SECTION 1. That the Chicago Zoning Ordinance be amended by changing all the Institutional Planned Development No. 137, C1-2 Restricted Commercial District, and R4 General Residence District symbols and indications as shown on Map No. 16-F in the area bounded by

West 69th Street; South Wentworth Avenue; a line 257.3 feet south of West 69th Street; a line 133 feet west of South Wentworth Avenue; a line 190.3 feet south of West 69th Street; the east line of South Yale Avenue; a line 187.3 feet south of West 69th Street; South Yale Avenue; a line 257.45 feet south of West 69th Street; a line 132.3 feet west of South Yale Avenue; a line 247.45 feet south of West 69th Street; a line 150.5 feet west of South Yale Avenue; a line 269.45 feet south of West 69th Street; a line 196.5 feet west of South Yale Avenue; a line 280.45 feet south of West 69th Street; South Princeton Avenue; a line 276.51 feet south of West 69th Street; and the east right-of-way line of the C.R.I. & P. Railroad,

to the designation of Institutional Planned Development No. 137, as amended, which hereby established the area above described; subject to such use and bulk regulations as are set forth in the Plan of Development herewith attached and made a part thereof and to no others.

SECTION 2. This ordinance shall be in force and effect from and after its passage and due publication.

Plan of Development attached to this ordinance reads as follows:

Institutional Planned Development No. 137, As Amended,

Statements.

1. The area delineated herein as "Institutional Planned Development", is controlled by the Department of Urban Renewal, since it lies within the Southeast Englewood Urban Renewal Area and Englewood Conservation Area.

2. Off-street parking and loading facilities shall be provided in compliance with this Plan of Development, subject to the review of the Bureau of Traffic Engineering and Operations and the approval of the Department of Planning.
3. Any dedication of streets and alleys or adjustments of the rights-of-way or consolidation or resubdivision of parcels shall require a separate submittal on behalf of the Department of Urban Renewal or its successors and approval of the Chicago City Council.
4. All other applicable official reviews, approvals or permits are required to be obtained by redeveloper or its successors.
5. Any service drives or any other ingress or egress shall be adequately designed or paved in accord with the regulations of the Bureau of Traffic Engineering and Operations and in compliance with the Municipal Code of Chicago to provide ingress and egress for motor vehicles, including emergency vehicles. There shall be no parking permitted within such paved areas. Fire lanes, if required, shall be adequately designed and paved in compliance with the Municipal Code of Chicago and shall have a minimum width of 20 feet to provide ingress and egress for emergency vehicles.
6. The following uses shall be permitted within the area delineated herein as "Institutional Planned Development":
 - A. 305-bed nursing home, off-street parking and loading facilities.
 - B. 225-bed nursing home, off-street parking and loading facilities.
7. Identification signs may be permitted within the area delineated herein as an Institutional Planned Development, subject to the review and approval of the Commissioner of the Department of Planning.
8. The following information sets forth data concerning the property included in said Planned Development and data concerning a generalized land use plan (site plan) illustrating the development of said property in accordance with the intent and purpose of the Chicago Zoning Ordinance.
9. The Plan of Development hereby attached shall be subject to the "Rules, Regulations and Procedures in Relation to Planned Developments", as adopted by the Commissioner of the Department of Planning.

Use and Bulk Regulations and Data attached to this Plan of Development reads as follows:

*Institutional Planned Development No. 137, As Amended,**Planned Development**Use And Bulk Regulations And Data.*

(Site)	Net Site Area Sq. Ft.	Acres	General Description Of Land Use	Max. Floor Area Ratio	Max. % of Land Covered
A	83,704.2	1.92	305-bed nursing home Off-street parking facilities Off-street loading facilities	1.5	35
B	82,377.6	1.89	225-bed nursing home Off-street parking facilities Off-street loading facilities	1.5	40

Note: The net site area for Site A and Site B include the vacated South Yale Avenue and the vacated South Princeton Avenue, respectively.

(Site)	Gross Site Area	=	Net Site Area	+	Area of Public Streets and Alleys
A	106,915.7		83,704.2	+	23,211.5
B	99,856.2		82,377.6	+	17,478.6

Maximum permitted F.A.R. for total net site area: Site A = 1.5 Site B = 1.5

Estimated population:

Site A	305 beds 1 doctor in residence 30 maximum number of employees in any one shift
Site B	225 beds 1 doctor in residence 30 maximum number of employees in any one shift

Minimum number of off-street parking spaces:

Site A	63 Regular <u>2</u> Handicapped	Site B	50 Regular <u>3</u> Handicapped
	65		53

Maximum number of off-street loading spaces: Site A = 1 Site B = 1

Minimum setbacks:	Site A	Site B
Boundary and front yard:	25 feet	25 feet
Boundary and side yard:	8 feet	8 feet
Boundary and rear yard:	35 feet	15 feet

Maximum percent of land covered:	Site A = 35%	Site B = 40%
----------------------------------	--------------	--------------

Setback and yard requirements may be adjusted where required to permit conformance to the pattern of, or architectural arrangement related to existing structures, or when necessary because of technical reasons subject to the approval of the Department of Planning.

[Generalized Land Use Plan, Property Line Map and Right-of-Way
Adjustment and Existing Zoning and Preferential Street
System Map printed on pages 19350 through
19352 of this Journal.]

Reclassification Of Area Shown On Map No. 18-F.

Be It Ordained by the City Council of the City of Chicago:

SECTION 1. That the Chicago Zoning Ordinance be amended by changing all the B2-2 Restricted Retail District symbols and indications as shown on Map No. 18-F in the area bounded by

West 74th Street; the alley next east of and parallel to South Halsted Street; a line 100 feet south of and parallel to West 74th Street; South Halsted Street,





to those of a C1-2 Restricted Commercial District, and a corresponding use district is hereby established in the area above described.

SECTION 2. This ordinance shall be in force and effect from and after its passage and due publication.

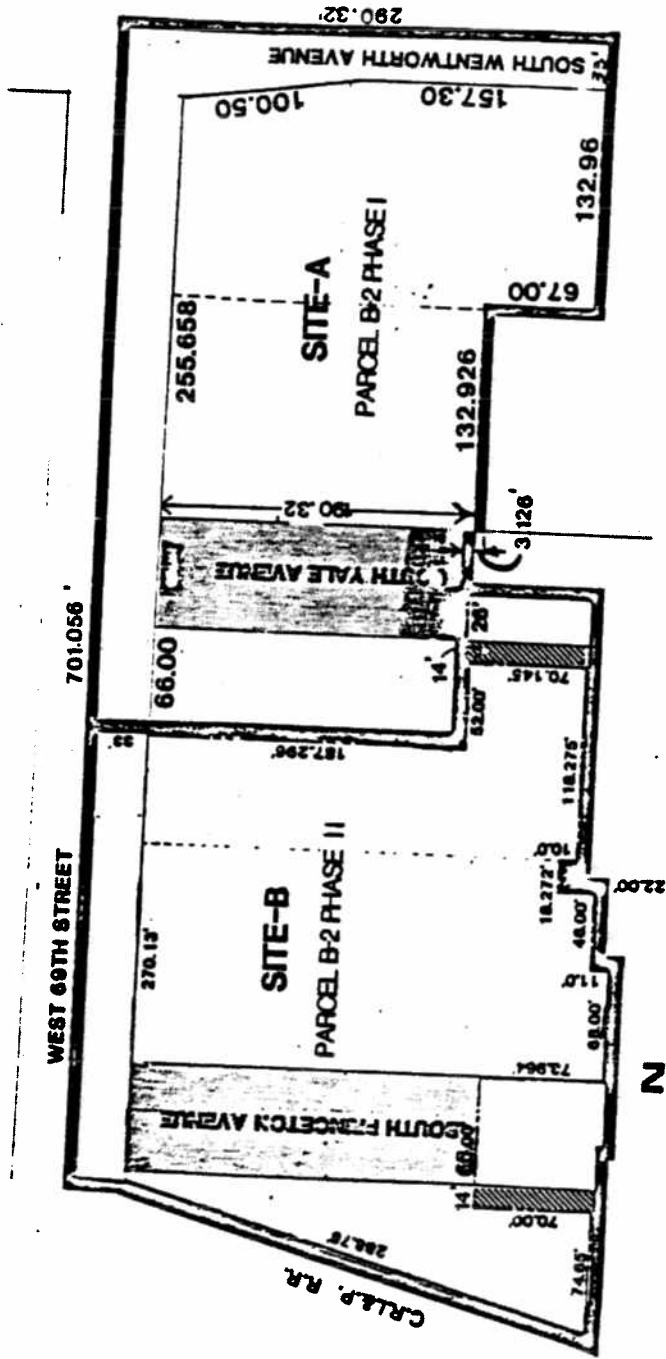
**JOINT COMMITTEE
COMMITTEE ON HOUSING.
COMMITTEE ON BUILDINGS.**

INSTITUTIONAL PLANNED DEVELOPMENT NO. 137 AS AMENDED
PROPERTY LINE MAP AND RIGHT-OF-WAY ADJUSTMENT







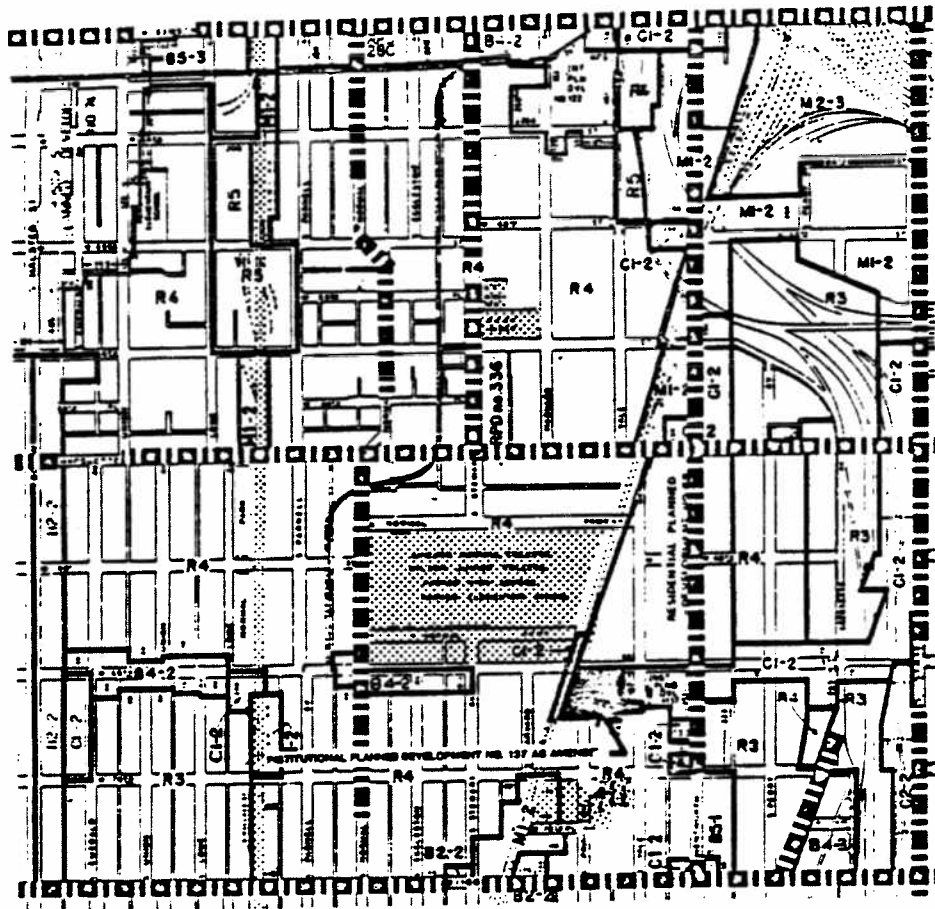

-  PLANNED DEVELOPMENT BOUNDARY
-  SOUTH-EAST ENGLEWOOD DISPOSITION
-  PARCEL B-2 PHASE I AND PHASE II
-  TO BE VACATED
-  TO BE DEDICATED

APPLICANT: DEPARTMENT OF URBAN RENOVATION OF THE CITY OF CHICAGO
PRINCETON ASSOCIATES/WENTWORTH INC.

DATE: OCTOBER 1988

INSTITUTIONAL PLANNED DEVELOPMENT NO. 137 AS AMENDED
EXISTING ZONING & PREFERENTIAL STREET SYSTEM



-  PROPOSED INSTITUTIONAL PLANNED DEVELOPMENT
-  ZONING DISTRICT BOUNDARIES
-  PREFERENTIAL STREETS
-  PARKS AND PLAYGROUNDS
-  PUBLIC AND QUASI-PUBLIC FACILITIES

APPLICANT: DEPARTMENT OF URBAN RENEWAL OF THE CITY OF CHICAGO
 PRINCETON ASSOCIATES/WENTWORTH INC.
 DATE: OCTOBER 1988

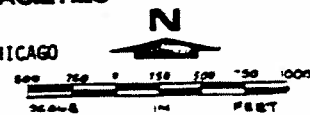

*Reclassification of Area Shown on Map No. 14-K.**Be It Ordained by the City Council of the City of Chicago:*

SECTION 1. That the Chicago Zoning Ordinance be amended by changing all the R3 General Residence District symbols and indications as shown on Map No. 14-K in the area bounded by

the alley next south of and parallel to W. 57th Place; the alley next west of and parallel to S. Pulaski Road; the alley next north of and parallel to W. 59th Street; S. Karlov Avenue; W. 59th Street; the alley next west of and parallel to S. Pulaski Road; the alley next north of and parallel to W. 63rd Street; the alley next west of and parallel to S. Kolmar Avenue; W. 59th Street; the east line of the right of way of the Belt Railway; W. 58th Street; the alley next west of and parallel to S. Kolmar Avenue; the alley next north of and parallel to W. 59th Street; a line 35 feet west of S. Kenneth Avenue; W. 59th Street; S. Tripp Avenue; the alley next south of and parallel to W. 59th Street; S. Keeler Avenue; the alley next north of and parallel to W. 58th Place; and S. Karlov Avenue

to those of an R2 Single Family Residence District, and a corresponding use district is hereby established in the area above described.

SECTION 2. This ordinance shall be in force and effect from and after its passage and due publication.

*Reclassification of Area Shown on Map No. 14-K.**Be It Ordained by the City Council of the City of Chicago:*

SECTION 1. That the Chicago Zoning Ordinance be amended by changing all the B4-1 Restricted Service District symbols and indications as shown on Map No. 14-K in the area bounded by

the alley next north of and parallel to W. 63rd Street; S. Tripp Avenue; W. 63rd Street; and S. Kolin Avenue

to those of a B2-1 Restricted Retail District, and a corresponding use district is hereby established in the area above described.

SECTION 2. This ordinance shall be in force and effect from and after its passage and due publication.

*Reclassification of Area Shown on Map No. 16-B.**Be It Ordained by the City Council of the City of Chicago:*

SECTION 1. That the Chicago Zoning Ordinance be amended by changing all the R4 General Residence District symbols and indications as shown on Map No. 16-B in area bounded by

W. 77th Street; the alley next east of and parallel to S. Laverne Avenue; a line 35 feet south of and parallel to W. 77th Street; S. Cicero Avenue; a line 485 feet south of and parallel to W. 77th Street; and S. Laverne Avenue

to those of a C2-1 General Commercial District, and a corresponding use district is hereby established in the area above described.

SECTION 2. This ordinance shall be in force and effect from and after its passage and due publication.

*Reclassification of Area Shown on Map No. 16-F.**Be It Ordained by the City Council of the City of Chicago:*

SECTION 1. That the Chicago Zoning Ordinance be amended by changing all the Institutional Planned Development No. 137 and C1-2 Restricted Commercial District symbols and indications as shown on Map No. 16-F in the area bounded by

W. 69th Street; S. Wentworth Avenue; a line 257.3 feet south of W. 69th Street; a line 133 feet west of S. Wentworth Avenue; a line 190.3 feet south of W. 69th Street; the east line of S. Yale Avenue; a line 187.3 feet south of W. 69th Street; and a line 66 feet west of S. Yale Avenue

to the designation of Institutional Planned Development No. 137, as amended, which is hereby established in the area above described, subject to such use and bulk regulations as are set forth in the Plan of Development herewith attached and made a part hereof and to no others.

[Planned Development printed on pages 8591 to 8595 of this Journal]

SECTION 2. This ordinance shall be in force and effect from and after its passage and due publication.

*Reclassification of Area Shown on Map No. 20-J.**Be It Ordained by the City Council of the City of Chicago:*

SECTION 1. That the Chicago Zoning Ordinance be amended by changing all the R2 Single Family Residence District symbols and indications as shown on Map No. 20-J in area bounded by

the alley next northwesterly of and parallel to W. Columbus Avenue; a line 69.9- $\frac{1}{8}$ feet northeasterly of the point of intersection of W. 86th Street and W. Columbus Avenue as measured along W. Columbus Avenue and perpendicular thereto; W. Columbus Avenue; W. 86th Street; and the second alley east of and parallel to S. Pulaski Road

to those of a B4-1 Restricted Service District, and a corresponding use district is hereby established in the area above described.

SECTION 2. This ordinance shall be in force and effect from and after its passage and due publication.

*Reclassification of Area Shown on Map No. 22-B.**Be It Ordained by the City Council of the City of Chicago:*

SECTION 1. That the Chicago Zoning Ordinance be amended by changing all the B4-2 Restricted Service District symbols and indications as shown on Map No. 22-B in area bounded by

E. 90th Street; S. Brandon Avenue; a line 130 feet south and parallel to E. 90th Street; a line 130 feet west and parallel to S. Brandon Avenue

to those of an R3 General Residence District, and a corresponding use district is hereby established in the area above described.

SECTION 2. This ordinance shall be in force and effect from and after its passage and due publication.

INSTITUTIONAL PLANNED DEVELOPMENT NO. 137, AS AMENDED

STATEMENTS



1. The area delineated hereon as "Institutional Planned Development," is owned and controlled by the Department of Urban Renewal of the City of Chicago with the exception of public rights-of-ways.
2. Off-street parking facilities shall be provided in compliance with this Plan of Development; subject to the review of the Department of Streets and Sanitation and the approval of the Department of Planning, City and Community Development.
3. Off-street loading facilities shall be provided in compliance with this Plan of Development, subject to the review of the Department of Streets and Sanitation and the approval of the Department of Planning, City and Community Development.
4. All applicable official reviews, approvals or permits are required to be obtained by the Department of Urban Renewal or its successors upon conveyance of Southeast Englewood Disposition Parcel B-2 (Part 1).
5. Any dedication, vacation or closures of streets and alleys or easements, or adjustments of right-of-way or consolidation or resubdivision of parcels shall require a separate submittal on behalf of the Department of Urban Renewal or its successor and approval by the City Council.
6. Any service drives or any other ingress or egress shall be adequately designed or paved in accord with the regulations of the Department of Streets and Sanitation and in compliance with the Municipal Code of Chicago to provide ingress and egress for motor vehicles, including emergency vehicles. There shall be no parking within such paved areas. Fire lanes, if required, shall be adequately designed and paved in compliance with the Municipal Code of Chicago and shall have a minimum width of 20 feet to provide ingress and egress for emergency vehicles. There shall be no parking within such paved areas.
7. The following uses shall be permitted within the area delineated herein as "Institutional Planned Development":
305 bed nursing home off-street parking and loading facilities.
8. Identification signs may be permitted within the area delineated herein as Institutional Planned Development, subject to the review and approval of the Commissioner of the Department of Planning, City and Community Development.
9. The following information sets forth data concerning the property included in said Planned Development and data concerning a generalized land use plan (site plan) illustrating the development of said property in accordance with the intent and purpose of the Chicago Zoning Ordinance.
10. The Plan of Development hereby attached shall be subject to the "Rules, Regulations and Procedures in Relation to Planned Development," as adopted by the Commissioner of the Department of Planning, City and Community Development.

APPLICANT: DEPARTMENT OF URBAN RENEWAL

DATE: July 7, 1978

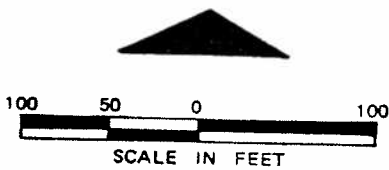
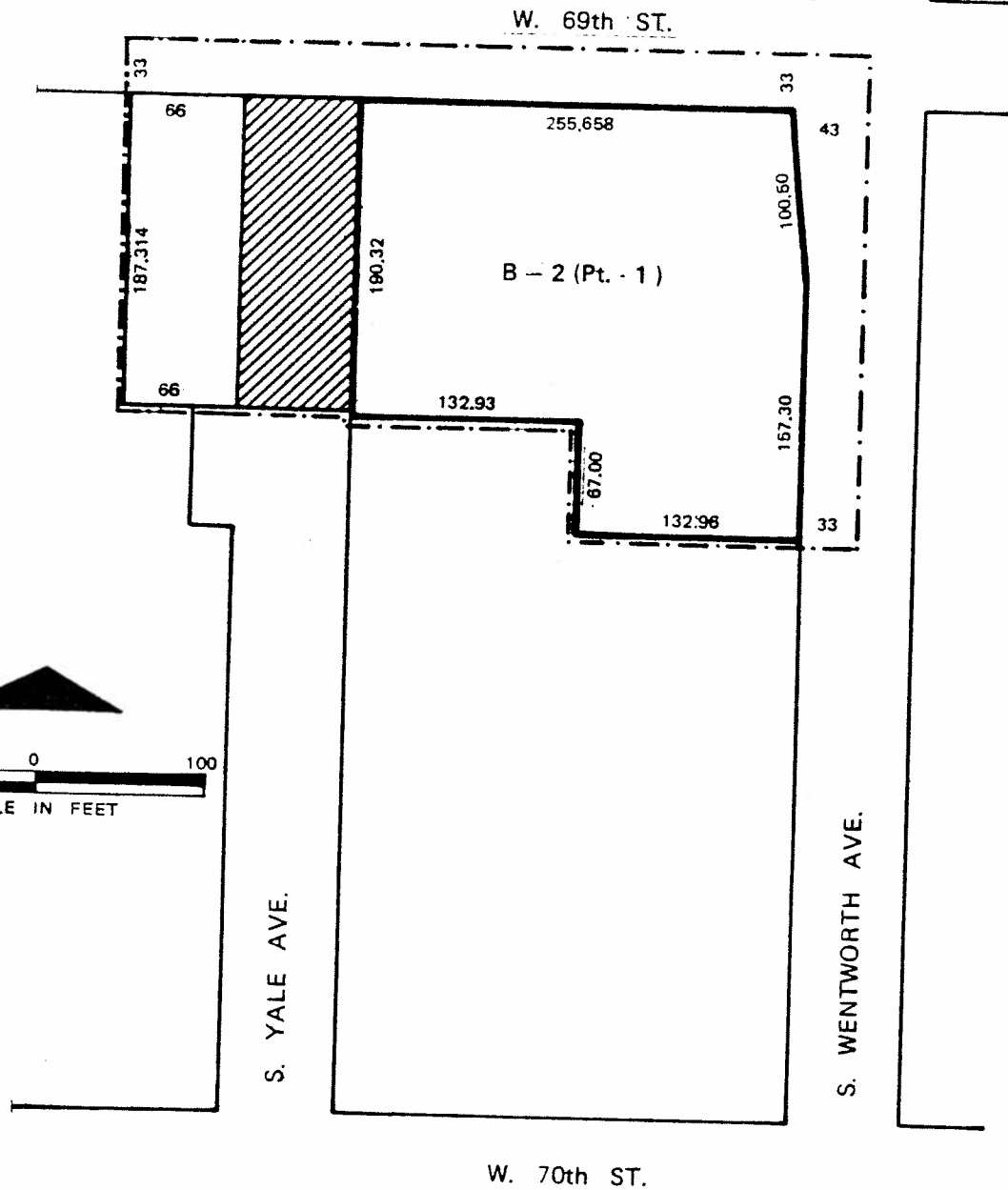
INSTITUTIONAL PLANNED DEVELOPMENT NO.137, AS AMENDED PROPERTY LINE MAP AND RIGHT-OF-WAY ADJUSTMENTS

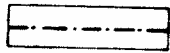
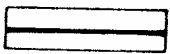

- LEGEND**
-  PLANNED DEVELOPMENT BOUNDARY
 -  SOUTHEAST ENGLEWOOD DISPOSITION PARCEL B-2 (PT. - 1)
 -  STREET TO BE CLOSED TO VEHICULAR TRAFFIC

APPLICANT : DEPARTMENT OF URBAN RENEWAL CITY OF CHICAGO
 DATE : JULY 7, 1978

INSTITUTIONAL PLANNED DEVELOPMENT NO.137, AS AMENDED

GENERALIZED LAND USE PLAN

W. 69th ST.

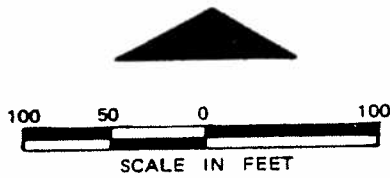
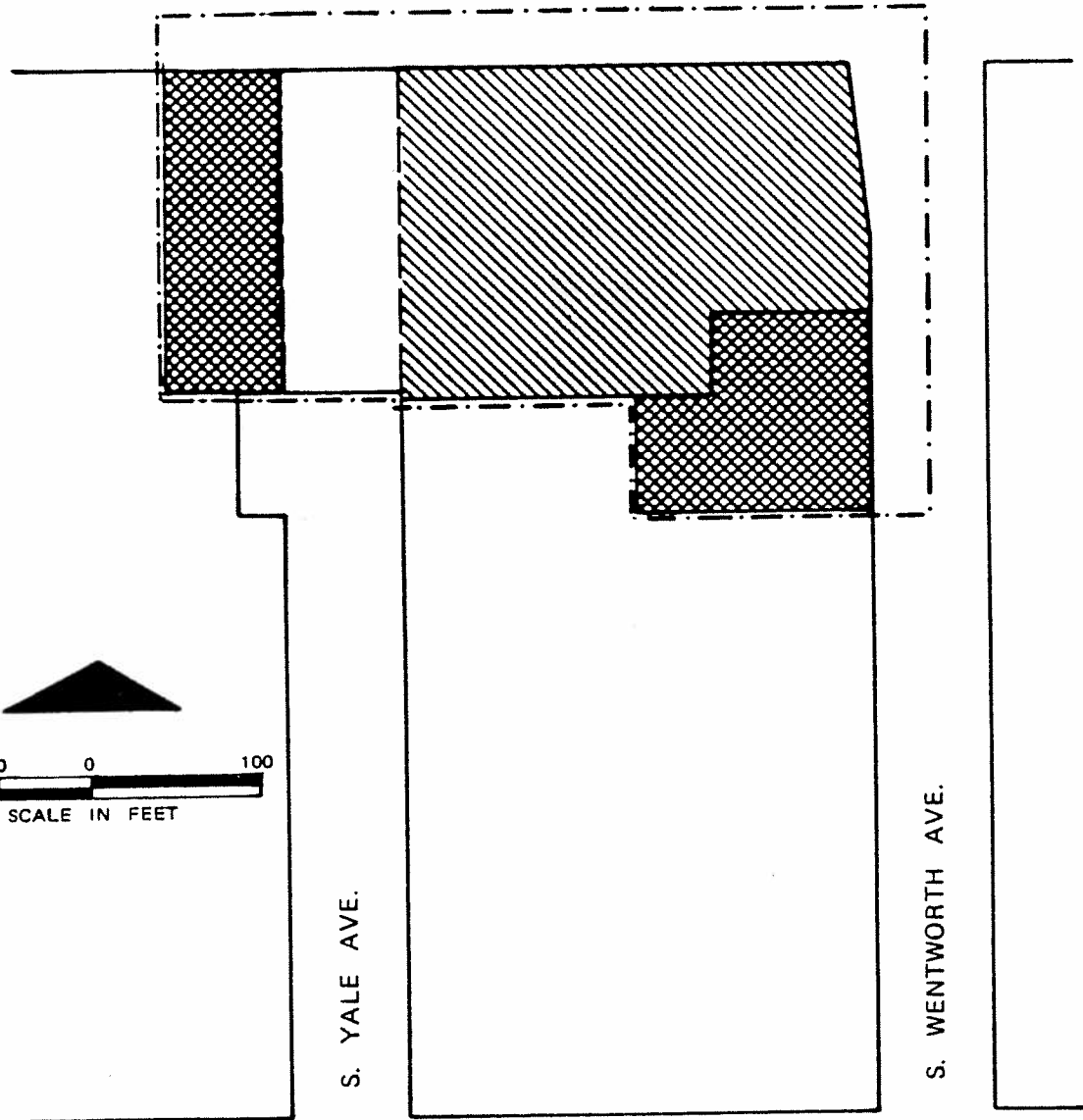

S. YALE AVE.

S. WENTWORTH AVE.

W. 70th ST.

LEGEND

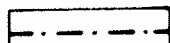

PLANNED DEVELOPMENT BOUNDARY



NURSING HOME



OFF-STREET PARKING AND LOADING

APPLICANT : DEPARTMENT OF URBAN RENEWAL CITY OF CHICAGO
 DATE : JULY 7, 1978

INSTITUTIONAL PLANNED DEVELOPMENT NO. 137, AS AMENDED

PLANNED DEVELOPMENT USE & BULK REGULATIONS & DATA

NET SITE AREA		GENERAL DESCRIPTION OF LAND USE	MAXIMUM FLOOR AREA RATIO	MAXIMUM PERCENTAGE OF LAND COVERED
Square Feet	Acres			
71,345.5	1.64	305-Bed Nursing Home Off-Street Parking Facilities Off-Street Loading Facilities	1.5	35%

<u>GROSS SITE AREA = NET SITE AREA + AREA OF PUBLIC STREETS AND ALLEYS</u>		
102,979.9	71,345.5	31,634.4

MAXIMUM PERMITTED F.A.R. FOR TOTAL NET SITE AREA: 1.5

EXTIMATED POPULATION: 305 Beds
 1 Doctor in Residence
 30 Maximum No. of Employees in any one shift

MINIMUM NUMBER OF OFF-STREET PARKING SPACES: 63 Regular
 2 Handicapped
 65 Total

MINIMUM NUMBER OF OFF-STREET LOADING SPACES: 1

MINIMUM SETBACKS:
 BOUNDARY AND FRONT YARD: 25 Feet
 BOUNDARY AND SIDE YARD: 8 Feet
 BOUNDARY AND REAR YARD: 35 Feet

MAXIMUM PERCENT OF LAND COVERED: 35%

SETBACK AND YARD REQUIREMENTS MAY BE ADJUSTED WHERE REQUIRED TO PERMIT CONFORMANCE TO THE PATTERN OF, OR ARCHITECTURAL ARRANGEMENT RELATED TO, EXISTING STRUCTURES, OR WHERE NECESSARY BECAUSE OF TECHNICAL REASONS, SUBJECT OF THE APPROVAL OF THE DEPARTMENT OF PLANNING, CITY AND COMMUNITY DEVELOPMENT.

APPLICANT: DEPARTMENT OF URBAN RENEWAL OF THE CITY OF CHICAGO

DATE: JULY 7, 1978

INSTITUTIONAL PLANNED DEVELOPMENT #137
STATEMENTS

1. The area delineated hereon as "Institutional Planned Development" is owned and controlled by the Department of Urban Renewal of the City of Chicago with the exception of Public Right-of-Ways.
2. Off-street parking facilities shall be provided in compliance with this Plan of Development, subject to the review of the Department of Streets and Sanitation and the approval of the Department of Development and Planning.
3. Off-street loading facilities shall be provided in compliance with this Plan of Development, subject to the review of the Department of Streets and Sanitation and the approval of the Department of Development and Planning.
4. All applicable official reviews, approvals or permits are required to be obtained by the Department of Urban Renewal or its successors upon conveyance of Southeast Englewood Disposition Parcel B-2 (Part 1).
5. Any dedication, vacation or closures of streets and alleys or easements, or adjustments of right-of-way or consolidation or resubdivision of parcels shall require a separate submittal on behalf of the Department of Urban Renewal or its successor and approval by the City Council.
6. Any service drives or any other ingress or egress shall be adequately designed or paved in accord with the regulations of the Department of Streets and Sanitation and in compliance with the Municipal Code of Chicago to provide ingress and egress for motor vehicles, including emergency vehicles. There shall be no parking within such paved areas. Fire lanes, if required, shall be adequately designed and paved in compliance with the Municipal Code of Chicago and shall have a minimum width of 20 feet to provide ingress and egress for emergency vehicles. There shall be no parking within such paved areas.
7. The following uses shall be permitted within the area delineated herein as "Institutional Planned Development": 305-bed nursing home off-street parking and loading facilities.
8. Identification signs may be permitted within the area delineated herein as Institutional Planned Development, subject to the review and approval of the Commissioner of the Department of Development and Planning.
9. The following information sets forth data concerning the property included in said Planned Development and data concerning a generalized land use plan (site plan) illustrating the development of said property in accordance with the intent and purpose of the Chicago Zoning Ordinance.
10. The Plan of Development hereby attached shall be subject to the "Rules, Regulations and Procedures in relation to Planned Development", as adopted by the Commissioner of the Department of Development and Planning.

Reclassification of Area Shown on Map No. 6-H.

Be It Ordained by the City Council of the City of Chicago:

SECTION 1. That the Chicago Zoning Ordinance be amended by changing all the C4 Motor Freight Terminal District symbols and indications as shown on Map No. 6-H in the area bounded by

a line parallel to, and 305 feet north of the north bank of the South Branch of the Chicago River; the center line of vacated S. Paulina Street; north bank of South Branch of the Chicago River; and the center line of vacated Canal "C"

to those of an M3-4 Heavy Manufacturing District, and a corresponding use district is hereby established in the area above described.

SECTION 2. This ordinance shall be in force and effect from and after its passage and due publication.

Reclassification of Area Shown on Map No. 9-M.

Be It Ordained by the City Council of the City of Chicago:

SECTION 1. That the Chicago Zoning Ordinance be amended by changing all the R2 Single Family Residence District symbols and indications as shown on Map No. 9-M in the area bounded by

the south line of W. Melrose Street extended; a line 96.8 feet east of the center line of N. Marmora Avenue extended; the alley next north of and parallel to W. Belmont Avenue, or the line thereof extended where no alley exists and a line 16.8 feet east of and parallel to N. Marmora Avenue extended

to those of a B4-1 Restricted Service District, and a corresponding use district is hereby established in the area above described.

SECTION 2. This ordinance shall be in force and effect from and after its passage and due publication.

Reclassification of Area Shown on Map No. 16-F.

Be It Ordained by the City Council of the City of Chicago:

SECTION 1. That the Chicago Zoning Ordinance be amended by changing all the C1-2 Restricted Commercial and R4 General Residence District symbols and indications as shown on Map No. 16-F in the area bounded by

W. 69th Street; S. Wentworth Avenue; a line 257.3 feet south of W. 69th Street; a line 133 feet west of S. Wentworth Avenue; a line 190.3 feet south of W. 69th Street and the west line of S. Yale Avenue

to the designation of an Institutional Planned Development which is hereby established in the area above described, subject to such use and bulk regulations as are set forth in the Plan of Development herewith attached and made a part hereof and to no others.

[Plan of Development printed on pages 2444-2448 of this Journal]

SECTION 2. This ordinance shall be in force and effect from and after its passage and due publication.

Reclassification of Area Shown on Map No. 16-L.

Be It Ordained by the City Council of the City of Chicago:

SECTION 1. That the Chicago Zoning Ordinance be amended by changing all the R2 Single Family Residence District symbols and indications as shown on Map No. 16-L in the area bounded by

a line 90 feet north of and parallel to W. 65th Street, the alley next east of and parallel to S. Lavergne Avenue; a line 120 feet north of and parallel to W. 65th Street; S. Laporte Avenue; W. 65th Street and S. Lavergne Avenue

to those of a B4-1 Restricted Service District, and a corresponding use district is hereby established in the area above described.

SECTION 2. This ordinance shall be in force and effect from and after its passage and due publication.

Reclassification of Area Shown on Map No. 16-M.

Be It Ordained by the City Council of the City of Chicago:

SECTION 1. That the Chicago Zoning Ordinance be amended by changing all the M1-1 Restricted Manufacturing District symbols and indications as shown on Map No. 16-M in the area bounded by

a line 120.4 feet west of and parallel to the west line of S. Melvina Avenue; a line 300 feet east of and parallel to the east line of S. Mobile Avenue; W. 64th Place and W. 65th Street

to those of an R4 General Residence District, and a corresponding use district is hereby established in the area above described.

SECTION 2. This ordinance shall be in force and effect from and after its passage and due publication.

Reclassification of Area Shown on Map No. 26-E.

Be It Ordained by the City Council of the City of Chicago:

SECTION 1. That the Chicago Zoning Ordinance be amended by changing all the B4-2 Restricted Service District symbols and indications as shown on Map No. 26-E in the area bounded by

a line 95 feet north of and parallel to W. 110th Place; the alley first east of and parallel to S. Martin Luther King Drive; E. 110th Place; S. Vernon Avenue; E. 111th Street and S. Martin Luther King Drive

to those of an R4 General Residence District, and a corresponding use district is hereby established in the area above described.

SECTION 2. This ordinance shall be in force and effect from and after its passage and due publication.

INSTITUTIONAL PLANNED DEVELOPMENT
PROPERTY LINE MAP AND RIGHT-OF-WAY ADJUSTMENTS

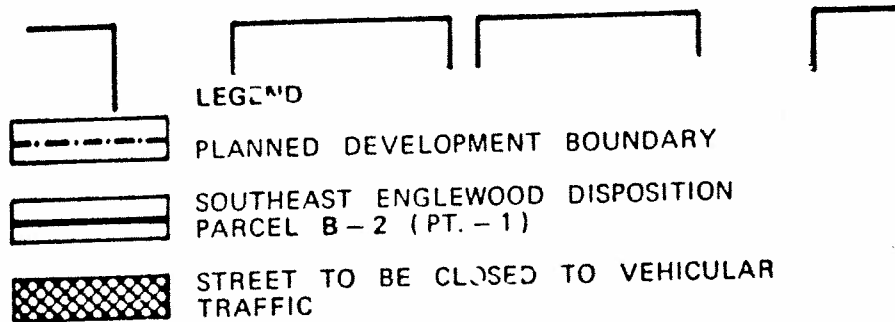
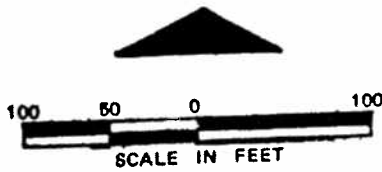
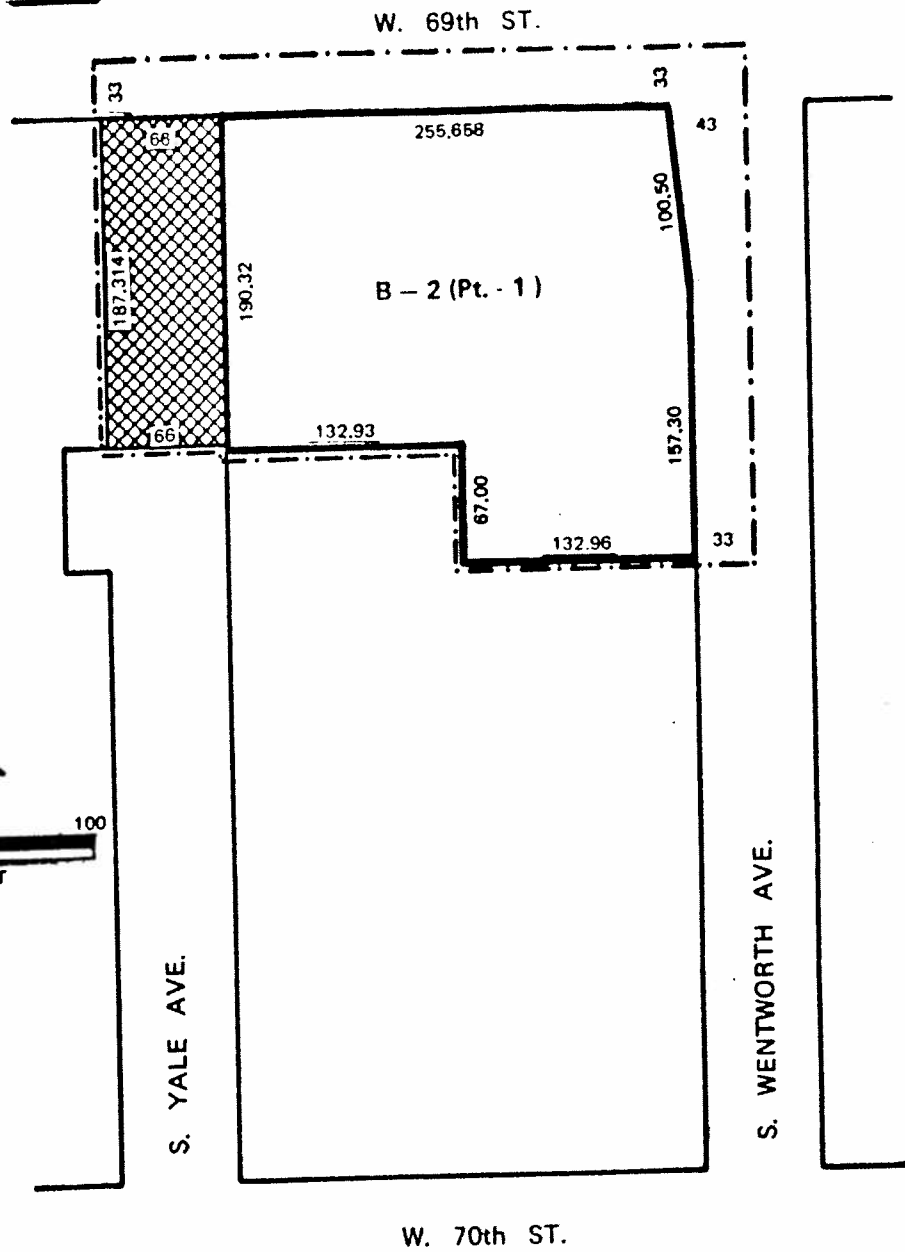

APPLICANT: DEPARTMENT OF URBAN RENEWAL CITY OF CHICAGO
 DATE: NOVEMBER 14, 1975

INSTITUTIONAL PLANNED DEVELOPMENT
GENERALIZED LAND USE PLAN

W. 69th ST.

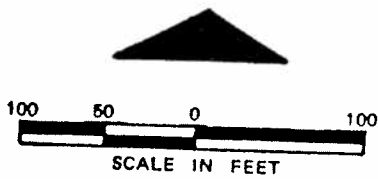
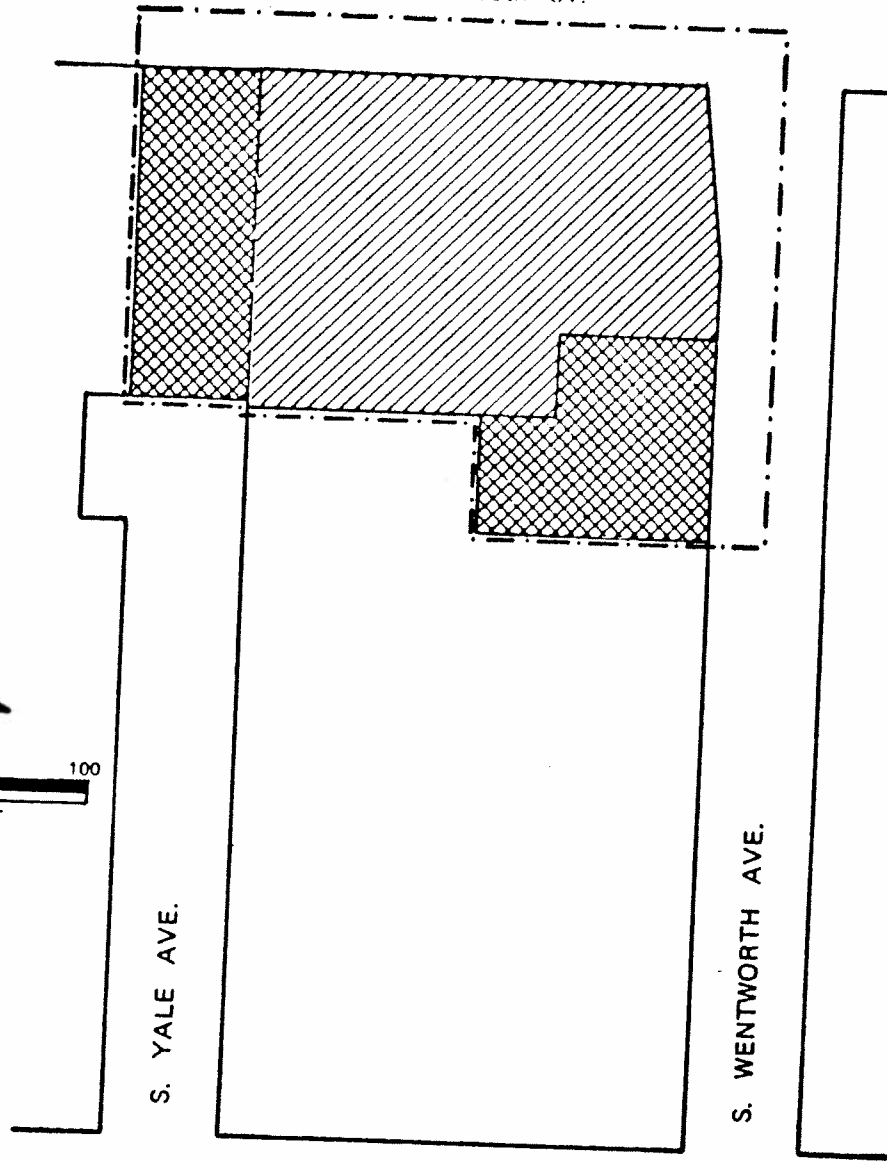

S. YALE AVE.

S. WENTWORTH AVE.

W. 70th ST.

LEGEND

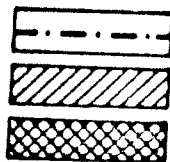

PLANNED DEVELOPMENT BOUNDARY

NURSING HOME

OFF-STREET PARKING AND LOADING

APPLICANT: DEPARTMENT OF URBAN RENOVATION CITY OF CHICAGO
DATE: NOVEMBER 14, 1975

