

W. Bryn Mawr Avenue; N. Wolcott Avenue; a line 150 feet south of W. Bryn Mawr Avenue; the west line of the right of way of the Chicago and North Western Railway Company; a line 351.52 feet west of N. Wolcott Avenue; a line from a point 576.33 feet north of W. Balmoral Avenue and 351 feet west of N. Wolcott Avenue to be connected by a 128.52 foot arc, with a chord of 127.94 feet, to a point 452.68 feet north of W. Balmoral Avenue and 322.51 feet west of N. Wolcott Avenue; a line 452.68 feet north of W. Balmoral Avenue; N. Wolcott Avenue; W. Balmoral Avenue; a line 468.89 feet west of N. Wolcott Avenue; a line 200.16 feet north of W. Balmoral Avenue; N. Damen Avenue; a line 412.64 feet north of W. Balmoral Avenue; a line from a point 412.64 feet north of W. Balmoral Avenue and 311.81 feet east of N. Damen Avenue to be connected by a 152.45 foot arc, with a chord of 151.02 feet, to a point 551.64 feet north of W. Balmoral Avenue, and 253 feet east of N. Damen Avenue; a line 551.64 feet north of W. Balmoral Avenue; and N. Damen Avenue,

to the designation of an Industrial Planned Development which is hereby established in the area above described, subject to such use and bulk regulations as are set forth in the Plan of Development herewith attached and made a part hereof and to no others.

[Plan of Development printed on pages 241-245 of this Journal]

SECTION 2. This ordinance shall be in force and effect from and after its passage and due publication.

Reclassification of Area Shown on Map No. 13-K.

Be It Ordained by the City Council of the City of Chicago:

SECTION 1. That the Chicago Zoning Ordinance be amended by changing all the R-2 Single Family Residence District and R-4 General Residence District symbols and indications as shown on Map No. 13-K in the area bounded by

a line 475 feet north of W. Argyle Street; N. Pulaski Road; the alley next north of and parallel to W. Argyle Street, or the line thereof if extended where no alley exists; and N. Kedvale Avenue,

to the designation of an Institutional Planned Development which is hereby established in the area above described, subject to such use and bulk regulations as are set forth in the Plan of Development herewith attached and made a part hereof and to no others.

[Plan of Development printed on pages 246-250 of this Journal]

SECTION 2. This ordinance shall be in force and effect from and after its passage and due publication.

*Reclassification of Area Shown on Map No. 13-M.
(As Amended).*

Be It Ordained by the City Council of the City of Chicago:

SECTION 1. That the Chicago Zoning Ordinance be amended by changing all the B4-1 Restricted Service District symbols and indications as shown on Map No. 13-M in the area bounded by

W. Bryn Mawr Avenue; N. Meade Avenue; Northwest Highway; a line beginning at a point 184.37 feet Northwesterly of the intersection of N. Meade Avenue and Northwest Highway and extending 100 feet perpendicular to Northwest Highway; the alley next Northeasterly and parallel to Northwest Highway; and the alley next west of and parallel to N. Meade Avenue,

to those of a C1-1 Restricted Commercial District, and a corresponding use district is hereby established in the area above described.

SECTION 2. This ordinance shall be in force and effect from and after its passage and due publication.

Failed to Pass—PROPOSED ORDINANCES FOR AMENDMENT OF CHICAGO ZONING ORDINANCE TO RECLASSIFY PARTICULAR AREAS (Adverse Committee Recommendations).

On motion of Alderman Vrdolyak, the City Council took up for consideration the report of the Committee on Buildings and Zoning deferred and published in the Journal of the Proceedings of February 28, 1975, pages 10251 and 10252, recommending that the City Council *Do Not Pass* seven proposed ordinances (under separate committee reports), for amendment of the Chicago Zoning Ordinance to reclassify particular areas.

Alderman Vrdolyak moved to *Concur In* the committee's recommendations. The question in reference to each proposed ordinance thereupon became: "*Shall the proposed ordinance Pass, notwithstanding the Committee's adverse recommendation?*" and the several questions being so put, each of the said proposed ordinances *Failed to Pass*, by yeas and nays as follows:

Yeas—Aldermen Roti, Barnett, Kenner, Evans, Lathrop, Sawyer, Wilinski, Cousins, Adduci, Vrdolyak, Bilandic, Kwak, Madrzyk, Burke, Jaksy, Barden, Shannon, Hines, Joyce, Kelley, Stewart, Stemberk, Lipinski, Rhodes, Marzullo, Zydlo, Ray, Cross, Hagopian, Gabinski, Mell, Frost, Laskowski, Aiello, Casey, Cullerton, Laurino, Gutstein, Pucinski, Natarus, Oberman, Simpson, Cohen, Schuller, Block, Saperstein, Stone—47.

Nays—None.

(continued on page 251)





INSTITUTIONAL PLANNED DEVELOPMENT # 126
PLAN OF DEVELOPMENT

STATEMENTS

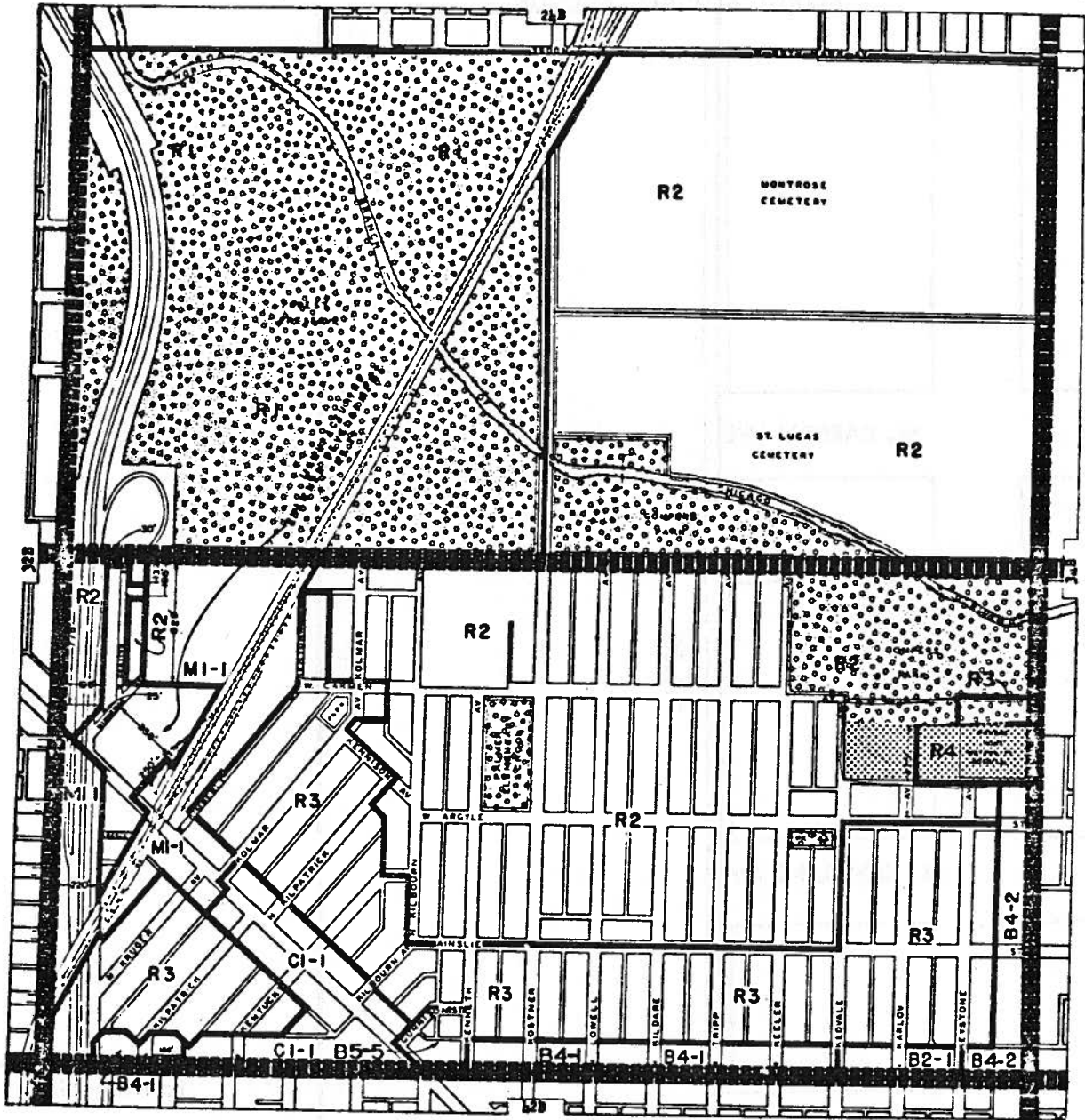
1. The area delineated herein as "Institutional Planned Development" is owned by The Salvation Army, an Illinois not-for-profit corporation.
2. Off-street parking and off-street loading facilities shall be provided in compliance with this Plan of Development, subject to the review of the Department of Streets and Sanitation and the approval of the Department of Development and Planning.
Ingress and egress to off-street parking and loading facilities shall be from N. Pulaski Road.
3. All applicable official reviews, approvals or permits are required to be obtained by The Salvation Army, or its successors, assignees or grantees.
4. Any dedication or vacation of streets and alleys, or easements, or adjustments of rights-of-way or consolidation or resubdivision of parcels shall require a separate submittal on behalf of The Salvation Army or its successors, assignees or grantees.
5. Any service drives or any other ingress or egress shall be adequately designed and paved in accord with the regulations of the Department of Streets and Sanitation and in compliance with the Municipal Code of Chicago, to provide ingress and egress for motor vehicles, including emergency vehicles; there shall be no parking within such paved areas. Fire lanes shall be adequately designed and paved in compliance with the Municipal Code of Chicago and shall have a minimum width of 20 feet to provide ingress and egress for emergency vehicles; there shall be no parking within such paved areas.
Fire lane access for emergency purposes shall be from N. Karlov Avenue.
6. The following uses shall be permitted within the area delineated herein as Institutional Planned Development: Obstetrical and gynecological hospital beds, and residence beds in conjunction with hospital function; skilled nursing beds; staff housing; passive recreation area; and off-street parking and loading spaces.
Laboratories & research facilities contained therein with regard to hospital functions shall be governed by performance standards as set forth under the M1 Zoning District classification of the Chicago Zoning Ordinance.
7. Identification signs may be permitted within the area delineated herein as Institutional Planned Development, subject to the review and approval of the Department of Buildings and the Department of Development and Planning.
8. The information in the table and maps attached hereto sets forth data concerning the generalized land use plan of the area delineated herein as Institutional Planned Development, and illustrates that the development of such area will be in general compliance with the R4 General Residence District classification and with the intent and purpose of the Chicago Zoning Ordinance.
9. The Plan of Development hereby attached shall be subject to the "Rules, Regulations and Procedures in Relation to Planned Developments", as promulgated by the Commissioner of Development and Planning.

INSTITUTIONAL PLANNED DEVELOPMENT EXISTING ZONING & PREFERENTIAL STREET SYSTEM



- LEGEND**
-  Planned Development Boundary
 -  Zoning District Boundary
 -  Parks & Playgrounds & Schools
 -  Preferential Streets



APPLICANT: THE SALVATION ARMY, an Illinois not-for-profit corporation

DATE: October 16, 1974

**INSTITUTIONAL PLANNED DEVELOPMENT
PROPERTY LINE MAP AND RIGHT-OF-WAY ADJUSTMENTS**

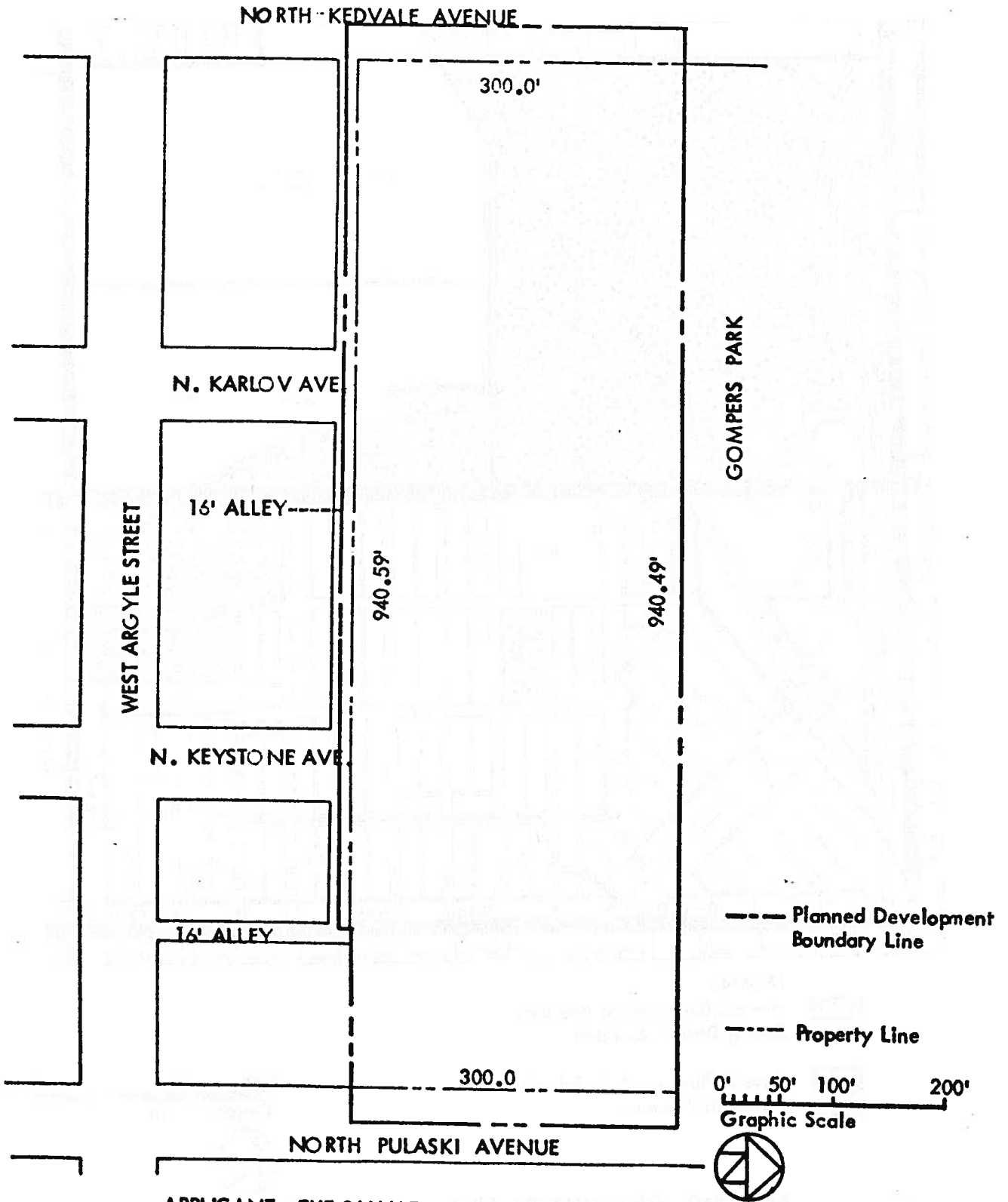

APPLICANT: THE SALVATION ARMY, an Illinois not-for-profit corporation

DATE: October 16, 1974

INSTITUTIONAL PLANNED DEVELOPMENT
GENERALIZED LAND USE PLAN

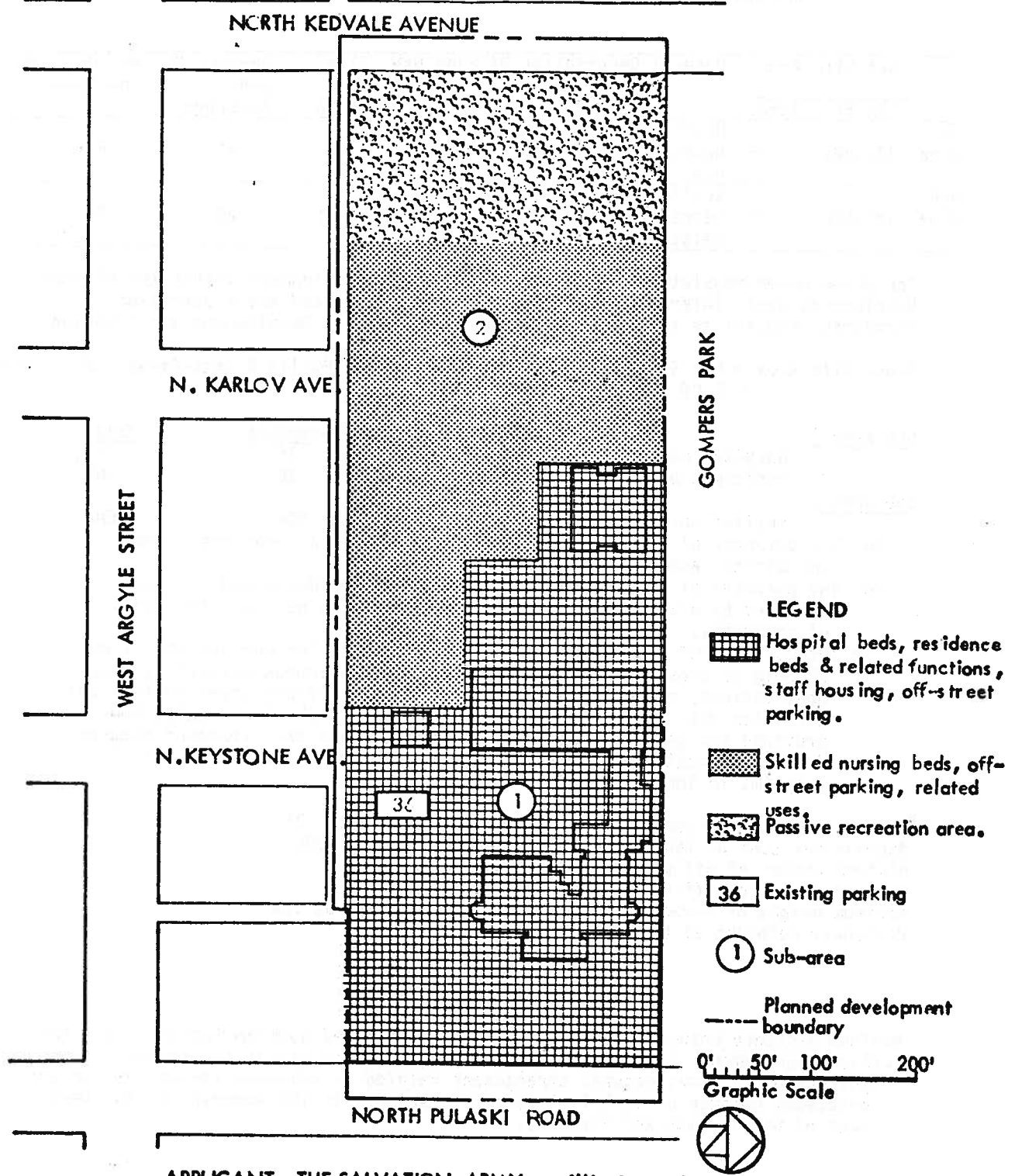

APPLICANT: THE SALVATION ARMY, an Illinois not-for-profit corporation

DATE: October 16, 1974

I N S T I T U T I O N A L P L A N N E D D E V E L O P M E N T

P L A N N E D D E V E L O P M E N T U S E & B U L K R E G U L A T I O N S & D A T A

	Net Site Area		General Description Of Land Use	Floor Area Ratio	Percent Of Land Coverage	No. Of Parking Spaces
	Sq.Ft.	Acres				
Sub-Area 1	141,681	3.25	Hospital & residence beds, staff housing, parking, and related uses	0.65	40	44
Sub-Area 2	140,526	3.22	Skilled nursing beds, passive recreation area, parking, and related uses	0.75	20	95

The above noted regulations relate to the ultimate development within the Planned Development area. Interim stages of development may exceed these permitted standards, subject to the approval of the Department of Development and Planning.

Gross Site Area = Net Site Area: 6.47 acres + Area in Public Rights-Of-Way: 0.61 acres
= 7.08 acres.

<u>Sub-area 1</u>	<u>existing</u>	<u>proposed</u>	<u>total</u>
hospital beds	20	15	35
residence beds	78	10	88
<u>Sub-area 2</u>			
skilled nursing beds	--	334	334

For the purposes of this Planned Development, hospital beds shall mean obstetrical and gynecological beds.

For the purposes of this Planned Development, a residence bed is a bed occupied by a woman receiving pre-natal care in her last few months of pregnancy.

For the purposes of this Planned Development, a skilled nursing bed is one wherein is provided skilled nursing care, continuous skilled nursing observations, restorative nursing and other services under professional direction with frequent medical supervision; a skilled nursing bed is provided for patients who need the type of care and treatment required during the post acute phase of illness, or during recurrence of symptoms in long-term illnesses.

Maximum permitted Floor Area Ratio for Net Site Area: 0.75

Maximum per cent of land coverage for Net Site Area: 35%

Minimum number of off-street parking spaces: 139

Minimum number of off-street loading spaces: 2

Maximum height of structure (existing and proposed): 55 feet

Periphery setbacks at boundary lines:

north - 12 feet
east - 100 feet
south - 41 feet
west - 270 feet

Minimum distance between hospital building and skilled nursing facility: 112 feet
Setback requirements may be adjusted where required to permit conformance to the pattern of or architectural arrangement related to existing structures, or when necessary because of technical reasons - subject to the approval of the Department of Development and Planning.

APPLICANT: The Salvation Army, an Illinois not-for-profit corporation
DATE: October 16, 1974