



Cook County, Illinois

E½ SW¼ Section 28 - 40 - 14

LAKE VIEW

2025 Tax Map

Page 1428F

40-14-28F

© 2025 Cook County, Illinois

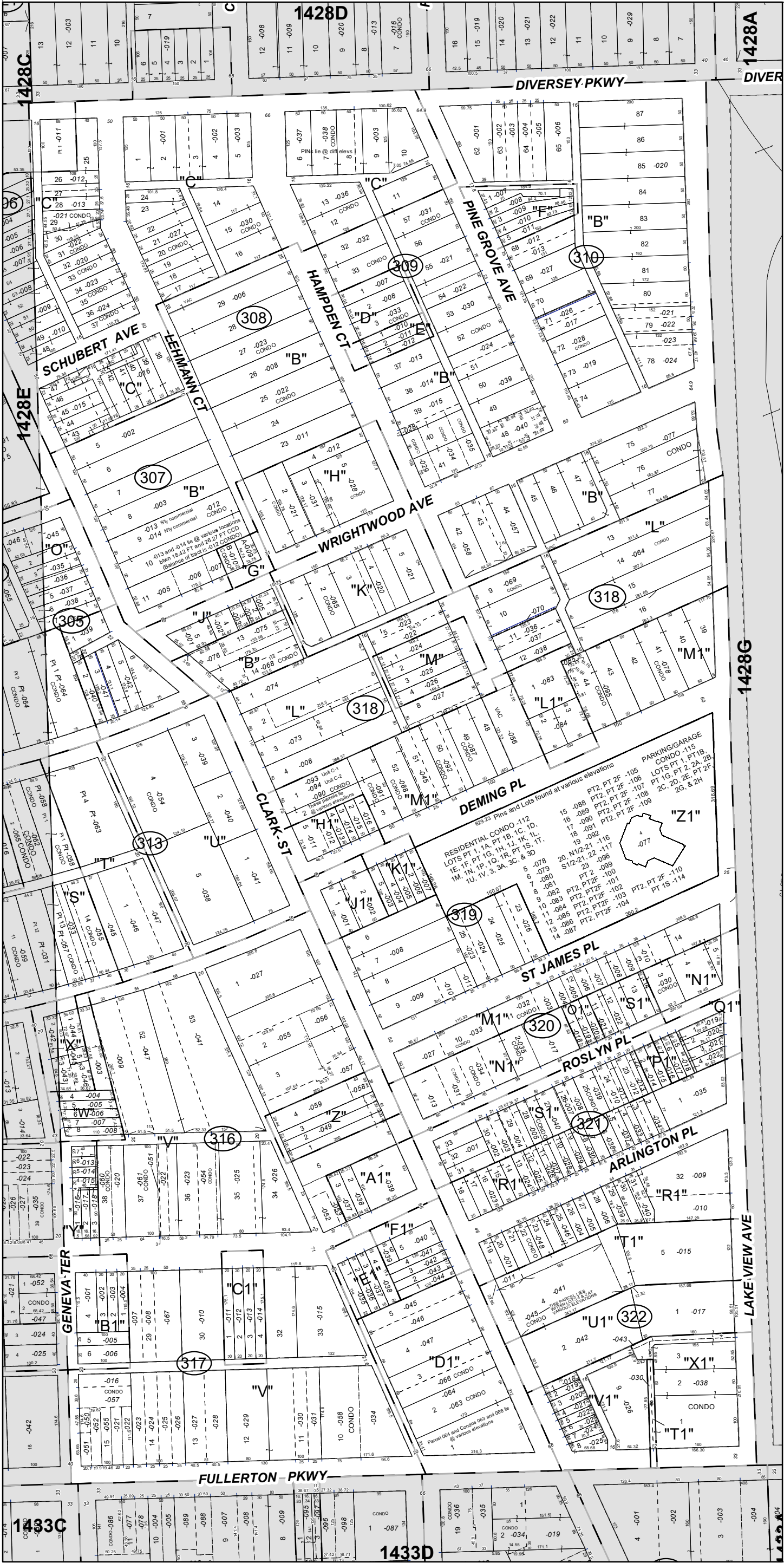

- "A"
- WRIGHTWOOD, a Sub. of the S. W. 1/4 of Sec. 28-40-14.
- Rec. Doc. 9999999999
- "B"
- ANDREW SPOFFORD & COLEHOUR'S SUB. of Blks. 1 & (ex. Lots 1 & 2) 2 of Outlot A in Wrightwood (see "A").
- Rec. Doc. 9999999999
- "C"
- LEHMAN DIVERSEY BLVD. ADD., a Sub. of part of Blks. 1 & 2 & vac. alley between Lots 59 & 60 of Andrew Spofford & Colehour's Sub. (see "B").
- Rec. Doc. 9999999999
- "D"
- HETTICK'S SUB. of Lots 34 & 35 in Andrew Spofford & Colehour's Sub. (see "B").
- Rec. Doc. 9999999999
- "E"
- JOHNSON'S SUB. of Lot 36 in Andrew Spofford & Colehour's Sub. (see "B").
- Rec. Doc. 9999999999
- "F"
- JOHNSON'S SUB. of Lots 66 & 67 in Andrew Spofford & Colehour's Sub. (see "B").
- Rec. Doc. 9999999999
- "G"
- SUB. of the E. 70 ft. of Lot 11 in Andrew Spofford & Colehour's Sub. (see "B").
- Rec. Doc. 9999999999
- "H"
- H. M. HOBART'S SUB. of Lots 20, 21 & 22 in Andrew Spofford & Colehour's Sub. (see "B").
- Rec. Doc. 9999999999
- "J"
- OWNER'S DIV. of Lot 12 in Andrew Spofford & Colehour's Sub. (see "B").
- Rec. Doc. 9999999999
- "K"
- H. M. HOBART'S SUB. of Lots 15 to 19 & the alley W. of and adj. Lots 17, 18 & 19 in Andrew Spofford & Colehour's Sub. (see "B").
- Rec. Doc. 9999999999
- "L"
- CODY & OTHERS SUB. of Blk. 3 of Outlot A in Wrightwood (see "A").
- Rec. Doc. 9999999999
- "M"
- SUB. of Lots 6 & 7 in Cody & Others Sub. (see "L").
- Rec. Doc. 9999999999
- "N"
- COUNTY CLERK'S DIV. of Outlot D in Wrightwood (see "A").
- Rec. Doc. 9999999999
- "O"
- SUB. of Lot 9 in County Clerk's Div. of Outlot D (see "N").
- Rec. Doc. 9999999999
- "P"
- SUB. of Lot 8 in County Clerk's Div. of Outlot D (see "N").
- Rec. Doc. 9999999999
- "Q"
- E. J. LEHMAN'S SUB. of Lot 10 in County Clerk's Div. of Outlot D (see "N").
- Rec. Doc. 9999999999
- "R"
- SUB. of Lot 2 in Sub. of Lot 10 (see "Q").
- Rec. Doc. 9999999999
- "S"
- GEO. S. PEPPER'S SUB. of Lot 12 in County Clerk's Div. of Outlot D (see "N").
- Rec. Doc. 9999999999
- "T"
- SWI ft.'S SUB. of Lot 11 in County Clerk's Div. of Outlot D (see "N").
- Rec. Doc. 9999999999
- "U"
- FRED C. BELL'S RESUB. of Lots 2 & 3 in Swi